

BUILDING-STRUCTURE INVENTORY FORM

FOR OFFICE USE ONLY

WS 15

DIVISION FOR HISTORIC PRESERVATION
NEW YORK STATE PARKS AND RECREATION
ALBANY, NEW YORK (518) 474-0479

UNIQUE SITE NO. _____
QUAD _____
SERIES _____
NEG. NO. _____

Green

YOUR NAME: Town of Islip Town Hall DATE: 6/15/79
655 Main Street
YOUR ADDRESS: Islip, N.Y. TELEPHONE: (516)224-5450
ORGANIZATION (if any): Department of Planning and Development

IDENTIFICATION

- 1. BUILDING NAME(S): Westerbeke House
- 2. COUNTY: Suffolk TOWN/CITY: Islip VILLAGE: West Sayville
- 3. STREET LOCATION: 57 Montauk Highway
- 4. OWNERSHIP: a. public b. private
- 5. PRESENT OWNER: _____ ADDRESS: _____
- 6. USE: Original: residence Present: residence
- 7. ACCESSIBILITY TO PUBLIC: Exterior visible from public road: Yes No
Interior accessible: Explain _____

DESCRIPTION

- 8. BUILDING MATERIAL: a. clapboard b. stone c. brick d. board and batten
e. cobblestone f. shingles g. stucco other: _____
- 9. STRUCTURAL SYSTEM: (if known) a. wood frame with interlocking joints
b. wood frame with light members
c. masonry load bearing walls
d. metal (explain) _____
e. other _____
- 10. CONDITION: a. excellent b. good c. fair d. deteriorated
- 11. INTEGRITY: a. original site b. moved if so, when? _____
c. list major alterations and dates (if known): _____

12. PHOTO: neg 31a NJM-3

13. MAP: Bowe-Anderson

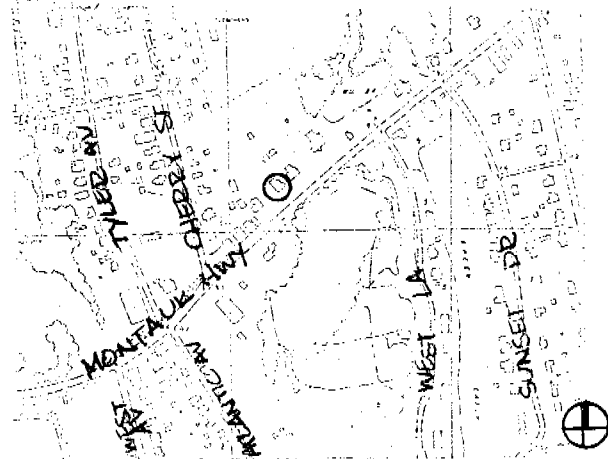

14. THREATS TO BUILDING: a. none known b. zoning c. roads
 d. developers e. deterioration
 f. other: _____
15. RELATED OUTBUILDINGS AND PROPERTY:
 a. barn b. carriage house c. garage
 d. privy e. shed f. greenhouse
 g. shop h. gardens
 i. landscape features: _____
 j. other: _____
16. SURROUNDINGS OF THE BUILDING (check more than one if necessary):
 a. open land b. woodland
 c. scattered buildings
 d. densely built-up e. commercial
 f. industrial g. residential
 h. other: _____

17. INTERRELATIONSHIP OF BUILDING AND SURROUNDINGS:
 (Indicate if building or structure is in an historic district)

The Westerbeke House, on the north side of Main Street (Montauk Hwy), is part of the West Sayville-Montauk Highway district (WS 18).

18. OTHER NOTABLE FEATURES OF BUILDING AND SITE (including interior features if known):
 2½ story wood house with gable roof. Gable porte cochere with scalloped shingles on east side. Wraparound porch with fluted columns. Queen Anne style detail in gable. Large Colonial Revival window with stained glass transom. Oval bevel glass panel in front door.

SIGNIFICANCE

19. DATE OF INITIAL CONSTRUCTION: before 1915

ARCHITECT: _____

BUILDER: _____

20. HISTORICAL AND ARCHITECTURAL IMPORTANCE:

The Westerbeke House is represented on the 1915 E. Belcher Hyde Map, as owned by William Westerbeke. From 1849, the Dutch began settling in West Sayville to engage in the shellfishing industry. Holland was having hard economic times and its people sought a new livelihood.

21. SOURCES:

E. Belcher Hyde, Atlas of a Part of Suffolk County, Long Island, New York, South Shore, Brooklyn, 1915.
 Charles P. Dickerson, A History of the Sayville Community, Suffolk

22. THEME: County News, 1975.

Prepared by: Society for the Preservation of Long Island Antiquities
 Setauket, New York 11733
 Nina Monastero, Research Assistant
 June, 1979

BUILDING-STRUCTURE INVENTORY FORM

DIVISION FOR HISTORIC PRESERVATION
NEW YORK STATE PARKS AND RECREATION
ALBANY, NEW YORK (518) 474-0479

FOR OFFICE USE ONLY
UNIQUE SITE NO. _____
QUAD _____
SERIES _____
NEG. NO. _____

green



YOUR NAME: Town of Islip Town Hall DATE: 6/15/79
655 Main Street
YOUR ADDRESS: Islip, N.Y. TELEPHONE: (516) 224-5450
ORGANIZATION (if any): Department of Planning and Development

IDENTIFICATION

- 1. BUILDING NAME(S): Westerbeke House
- 2. COUNTY: Suffolk TOWN/CITY: Islip VILLAGE: West Sayville
- 3. STREET LOCATION: 57 Montauk Highway
- 4. OWNERSHIP: a. public b. private
- 5. PRESENT OWNER: _____ ADDRESS: _____
- 6. USE: Original: residence Present: residence
- 7. ACCESSIBILITY TO PUBLIC: Exterior visible from public road: Yes No
Interior accessible: Explain _____

DESCRIPTION

- 8. BUILDING MATERIAL: a. clapboard b. stone c. brick d. board and batten
e. cobblestone f. shingles g. stucco other: _____
- 9. STRUCTURAL SYSTEM: a. wood frame with interlocking joints
(if known) b. wood frame with light members
c. masonry load bearing walls
d. metal (explain) _____
e. other _____
- 10. CONDITION: a. excellent b. good c. fair d. deteriorated
- 11. INTEGRITY: a. original site b. moved if so, when? _____
c. list major alterations and dates (if known): _____

12. PHOTO: ELW IX # 167 from SW,

13. MAP: Bowe-Anderson

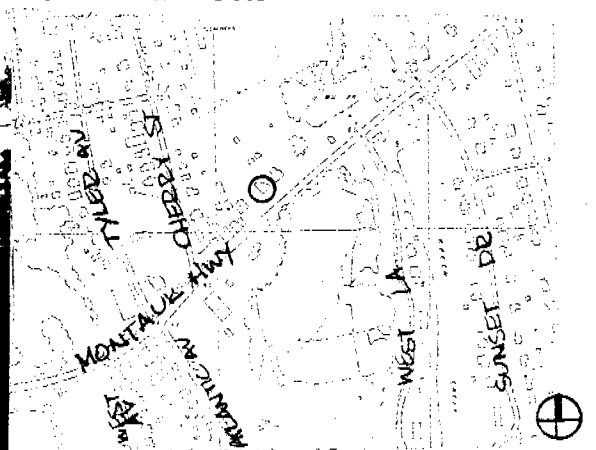

HP-1

front (south) facade