

# BUILDING-STRUCTURE INVENTORY FORM

DIVISION FOR HISTORIC PRESERVATION  
NEW YORK STATE PARKS AND RECREATION  
ALBANY, NEW YORK (518) 474-0479

FOR OFFICE USE ONLY

UNIQUE SITE NO. 10305.000761  
QUAD \_\_\_\_\_  
SERIES \_\_\_\_\_  
NEG. NO. \_\_\_\_\_

HA. 3

YOUR NAME: Town of Islip/SPLIA DATE: March 1990  
Town Hall, 655 Main St.  
YOUR ADDRESS: Islip, L.I., N.Y. 11751 TELEPHONE: 516.224.5450  
ORGANIZATION (if any): Dept. of Planning, Housing, and Development

\*\*\*\*\*

## IDENTIFICATION

1. BUILDING NAME(S): One Room School House  
2. COUNTY: Suffolk TOWN/CITY: Islip VILLAGE: Hauppauge  
3. STREET LOCATION: 647 Blydenburgh Rd.  
4. OWNERSHIP: a. public ☐ b. private ☒  
5. PRESENT OWNER: \_\_\_\_\_ ADDRESS: \_\_\_\_\_  
6. USE: Original: school house Present: residence  
7. ACCESSIBILITY TO PUBLIC: Exterior visible from public road: Yes ☒ No ☐  
Interior accessible: Explain private residence

## DESCRIPTION

8. BUILDING MATERIAL: a. clapboard ☐ b. stone ☐ c. brick ☐ d. board and batten ☐  
e. cobblestone ☐ f. shingles ☒ g. stucco ☐ other: composition shingle  
9. STRUCTURAL SYSTEM: a. wood frame with interlocking joints ☐  
(if known) b. wood frame with light members ☒  
c. masonry load bearing walls ☐  
d. metal (explain) \_\_\_\_\_  
e. other \_\_\_\_\_  
10. CONDITION: a. excellent ☐ b. good ☒ c. fair ☐ d. deteriorated ☐  
11. INTEGRITY: a. original site ☒ b. moved ☐ if so, when? \_\_\_\_\_  
c. list major alterations and dates (if known): \_\_\_\_\_

enlarged and converted to residence

12. PHOTO: Neg. KK XVI-4, fm. W 13. MAP: NYS DOT Central Islip Quad

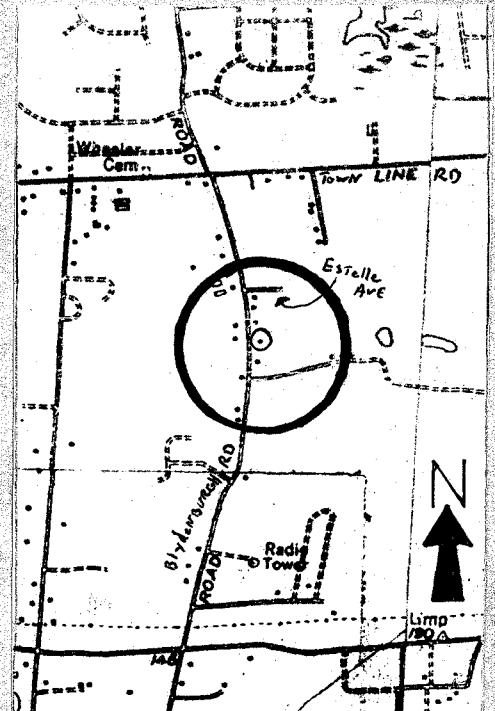

14. THREATS TO BUILDING: a. none known ☒ b. zoning ☐ c. roads ☐  
 d. developers ☐ e. deterioration ☐  
 f. other: \_\_\_\_\_
15. RELATED OUTBUILDINGS AND PROPERTY:  
 a. barn ☐ b. carriage house ☐ c. garage ☐  
 d. privy ☐ e. shed ☐ f. greenhouse ☐  
 g. shop ☐ h. gardens ☐  
 i. landscape features: \_\_\_\_\_  
 j. other: large dump site directly west
16. SURROUNDINGS OF THE BUILDING (check more than one if necessary):  
 a. open land ☐ b. woodland ☐  
 c. scattered buildings ☐  
 d. densely built-up ☐ e. commercial ☐  
 f. industrial ☐ g. residential ☒  
 h. other: \_\_\_\_\_
17. INTERRELATIONSHIP OF BUILDING AND SURROUNDINGS:  
 (Indicate if building or structure is in an historic district)  
 647 Blydenburgh Road is located on the east side of the street among residences of similiar size on small lots. A large dump/landfill occupies the west side of Blydenburgh Road.
18. OTHER NOTABLE FEATURES OF BUILDING AND SITE (including interior features if known):  
 647 Blydenburgh Road is a two story, low gable roof building with a pedimented entrance porch on the main (west) facade..

**SIGNIFICANCE**

19. DATE OF INITIAL CONSTRUCTION: 1909\*
- ARCHITECT: \_\_\_\_\_
- BUILDER: Mr. Hand

## 20. HISTORICAL AND ARCHITECTURAL IMPORTANCE:

This is 647 Blydenburgh Road today. It is hard to believe that it was a one-room school house. (see attached old view before remodelling).

21. SOURCES: NYS Retired Teacers Assoc. Old School Houses, Nassau and Suffolk, 1976.

Building-Structure Inventory Form, Mildred Harding, 2/14/1975.

\*Interview, Jack Marr, Hauppauge Historian, 516.234.4927.

22. THEME: Research by Society for the Preservation of Long Island Antiquities **KEK**

## BUILDING-STRUCTURE INVENTORY FORM

NEW YORK STATE HISTORIC TRUST  
OFFICE OF PARKS AND RECREATION  
ALBANY, NEW YORK (518) 457-3753

FOR OFFICE USE ONLY

FEB 19 1975 HA 3

UNIQUE SITE NO. 10305.000761  
QUAD \_\_\_\_\_  
SERIES \_\_\_\_\_  
NEG. NO. \_\_\_\_\_

YOUR NAME: Miss Mildred Harding DATE: Feb. 14, 1975  
YOUR ADDRESS: 647 Blydenburgh Rd. TELEPHONE: 516-979-0409  
ORGANIZATION (if any): Hauppauge, N.Y., 11787

### IDENTIFICATION

1. BUILDING NAME(S): One-room schoolhouse  
2. COUNTY: Suffolk TOWN/CITY: Hauppauge VILLAGE: Hauppauge  
3. STREET LOCATION: Between Town Line Rd. on north and  
4. OWNERSHIP: a. public ☐ b. private ☒ Motor Hwy. on south.  
5. PRESENT OWNER: Harry Dewar ADDRESS: 2169 Spring Creek Rd.  
6. USE: Original: Schoolhouse Present: Musis Studio-Residence  
7. ACCESSIBILITY TO PUBLIC: Exterior visible from public road: Yes ☒ No ☐  
Interior accessible: Explain Private

### DESCRIPTION

8. BUILDING MATERIAL: a. clapboard ☐ b. stone ☐ c. brick ☐ d. board and batten ☐  
e. cobblestone ☐ f. shingles ☒ g. stucco ☐ other: \_\_\_\_\_  
9. STRUCTURAL SYSTEM: a. wood frame with interlocking joints ☐  
(if known) b. wood frame with light members ☐  
c. masonry load bearing walls ☐  
d. metal (explain) \_\_\_\_\_  
e. other \_\_\_\_\_  
10. CONDITION: a. excellent ☐ b. good ☐ c. fair ☒ d. deteriorated ☐  
11. INTEGRITY: a. original site ☒ b. moved ☐ if so, when? \_\_\_\_\_  
c. list major alterations and dates (if known): Conversion from

12. PHOTO:

13. MAP:

schoolhouse to residence in early 1930's.  
Built 1909.

Dacatur  
Georgia  
30033



14. THREATS TO BUILDING: a. none known ☒ b. zoning ☐ c. roads ☐  
 d. developers ☐ e. deterioration ☐  
 f. other: \_\_\_\_\_

## 15. RELATED OUTBUILDINGS AND PROPERTY:

- a. barn ☐ b. carriage house ☐ c. garage ☐  
 d. privy ☐ e. shed ☐ f. greenhouse ☐  
 g. shop ☐ h. gardens ☐  
 i. landscape features: beginning stage of development.  
 j. other: \_\_\_\_\_

## 16. SURROUNDINGS OF THE BUILDING (check more than one if necessary):

- a. open land ☐ b. woodland ☐  
 c. scattered buildings ☐  
 d. densely built-up ☐ e. commercial ☐  
 f. industrial ☐ g. residential ☒  
 h. other: houses either side, field in

rear woods across street near Colony Hill Golf Course  
 17. INTERRELATIONSHIP OF BUILDING AND SURROUNDINGS:  
 (Indicate if building or structure is in an historic district)  
Near spots in Smithtown (2 miles).

## 18. OTHER NOTABLE FEATURES OF BUILDING AND SITE (including interior features if known):

Some of original wainscoting inside.

SIGNIFICANCE

19. DATE OF INITIAL CONSTRUCTION: 1909

ARCHITECT: \_\_\_\_\_

BUILDER: \_\_\_\_\_

## 20. HISTORICAL AND ARCHITECTURAL IMPORTANCE:

Hauppauge's 4<sup>th</sup> schoolhouse.

## 21. SOURCES:

Old newspaper clippings found in library, stories from neighbors.

Blydenburgh Road, south of Town Line Road, East Hauppauge, New York



Records from the Hauppauge School District show that on August 6, 1908, it was voted to erect a schoolhouse in East Hauppauge. An appropriation of \$2,000 for the building and \$500 for the grounds and fencing was recorded.

In the minutes of October 31, 1908, Mr. Hand's bid of \$1,299 was accepted. The schoolhouse was erected in 1909 and served East Hauppauge until it was closed in 1940. The building was sold for \$800 to Olinto Parenti and subsequently converted into a residence which is still in use.

New York State Retired Teachers Assoc., Old School Houses, Nassau & Suffolk Counties, 1976.