

BUILDING-STRUCTURE INVENTORY FORM

DIVISION FOR HISTORIC PRESERVATION  
NEW YORK STATE PARKS AND RECREATION  
ALBANY, NEW YORK (518) 474-0479

FOR OFFICE USE ONLY  
UNIQUE SITE NO. 103-050158  
QUAD \_\_\_\_\_  
SERIES \_\_\_\_\_  
NEG. NO. \_\_\_\_\_

B-7  
D04

YOUR NAME: Town of Islip DATE: 8/1/75

YOUR ADDRESS: Town Hall-655 Main St. Islip, L.I., N.Y. 11751 TELEPHONE: 516-581-2000

ORGANIZATION (if any): Dept. of Planning, Housing, & Development

\*\*\*\*\*

IDENTIFICATION

- 1. BUILDING NAME(S): #659 Suffolk Avenue
- 2. COUNTY: Suffolk TOWN/CITY: Islip VILLAGE: Brentwood
- 3. STREET LOCATION: 659 Suffolk Ave.
- 4. OWNERSHIP: a. public  b. private
- 5. PRESENT OWNER: \_\_\_\_\_ ADDRESS: \_\_\_\_\_
- 6. USE: Original: Residence Present: Residence
- 7. ACCESSIBILITY TO PUBLIC: Exterior visible from public road: Yes  No   
Interior accessible: Explain Privately owned

DESCRIPTION

- 8. BUILDING MATERIAL: a. clapboard  b. stone  c. brick  d. board and batten   
e. cobblestone  f. shingles  g. stucco  other: \_\_\_\_\_
- 9. STRUCTURAL SYSTEM: (if known) a. wood frame with interlocking joints   
b. wood frame with light members   
c. masonry load bearing walls   
d. metal (explain) \_\_\_\_\_  
e. other \_\_\_\_\_
- 10. CONDITION: a. excellent  b. good  c. fair  d. deteriorated
- 11. INTEGRITY: a. original site  b. moved  if so, when? \_\_\_\_\_  
c. list major alterations and dates (if known):  
Front porch gone.

12. PHOTO: Negative No. B-6A

13. MAP:

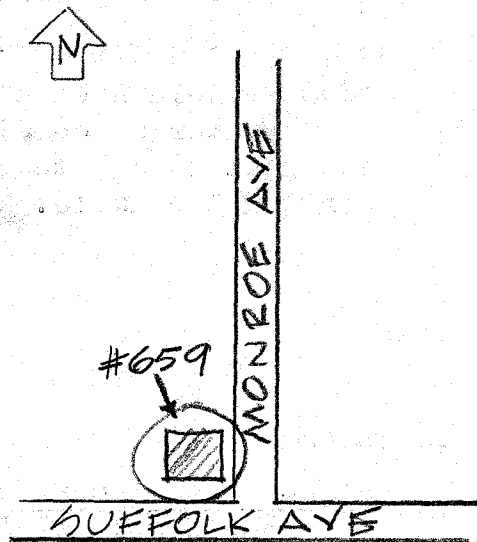

14. THREATS TO BUILDING: a. none known  b. zoning  c. roads   
 d. developers  e. deterioration   
 f. other: \_\_\_\_\_
15. RELATED OUTBUILDINGS AND PROPERTY:  
 a. barn  b. carriage house  c. garage   
 d. privy  e. shed  f. greenhouse   
 g. shop  h. gardens   
 i. landscape features: \_\_\_\_\_  
 j. other: \_\_\_\_\_
16. SURROUNDINGS OF THE BUILDING (check more than one if necessary):  
 a. open land  b. woodland   
 c. scattered buildings   
 d. densely built-up  e. commercial   
 f. industrial  g. residential   
 h. other: \_\_\_\_\_

17. INTERRELATIONSHIP OF BUILDING AND SURROUNDINGS:  
 (Indicate if building or structure is in an historic district)  
**#659 Suffolk Avenue is on the corner of a commercial neighborhood.  
 It is a remnant of the past among newer buildings.**

18. OTHER NOTABLE FEATURES OF BUILDING AND SITE (including interior features if known):  
**Two and one half story Victorian house with original verge  
 boards and stickwork in gable. Brick foundation. Bay window  
 on East facade.**

**SIGNIFICANCE**

19. DATE OF INITIAL CONSTRUCTION: \_\_\_\_\_  
 ARCHITECT: \_\_\_\_\_  
 BUILDER: \_\_\_\_\_

20. HISTORICAL AND ARCHITECTURAL IMPORTANCE:  
**#659 Suffolk Avenue is a handsome Victorian house with typical  
 fine Victorian detailing. It provides an esthetic example of  
 the past to an otherwise commercial area. It has fine stick-  
 work in the gable.**

21. SOURCES:  
**Atlas of the Ocean Shore of Suffolk County (Westerly Section)  
 New York: E. Belcher Hyde 1915, Plate 17.**

22. THEME:  
**Research by the Society for the Preservation of L.I. Antiquities**  
 EFW