

BUILDING-STRUCTURE INVENTORY FORM

DIVISION FOR HISTORIC PRESERVATION
NEW YORK STATE PARKS AND RECREATION
ALBANY, NEW YORK (518) 474-0479

FOR OFFICE USE ONLY
UNIQUE SITE NO. <u>103-05-0174</u> - 004
QUAD _____
SERIES _____
NEG. NO. _____

B-21
004

YOUR NAME: Town of Islip DATE: 8/15/75

Town Hall 655 Main St.
YOUR ADDRESS: Islip, L.I., N.Y. 11751 TELEPHONE: 516-581-2000

ORGANIZATION (if any): Dept. of Planning, Housing, & Development

IDENTIFICATION

- BUILDING NAME(S): #29 ~~Fourth Avenue~~
- COUNTY: Suffolk TOWN/CITY: Islip VILLAGE: Brentwood
- STREET LOCATION: 29 Fourth Ave.
- OWNERSHIP: a. public b. private
- PRESENT OWNER: _____ ADDRESS: _____
- USE: Original: Residence Present: Residence
- ACCESSIBILITY TO PUBLIC: Exterior visible from public road: Yes No
Interior accessible: Explain _____

DESCRIPTION

- BUILDING MATERIAL: a. clapboard b. stone c. brick d. board and batten
e. cobblestone f. shingles g. stucco other: _____
- STRUCTURAL SYSTEM: (if known) a. wood frame with interlocking joints
b. wood frame with light members
c. masonry load bearing walls
d. metal (explain) _____
e. other _____
- CONDITION: a. excellent b. good c. fair d. deteriorated
- INTEGRITY: a. original site b. moved if so, when? _____
c. list major alterations and dates (if known):
Addition to NE side of House.

12. PHOTO: Negative No. C-8A

13. MAP: 

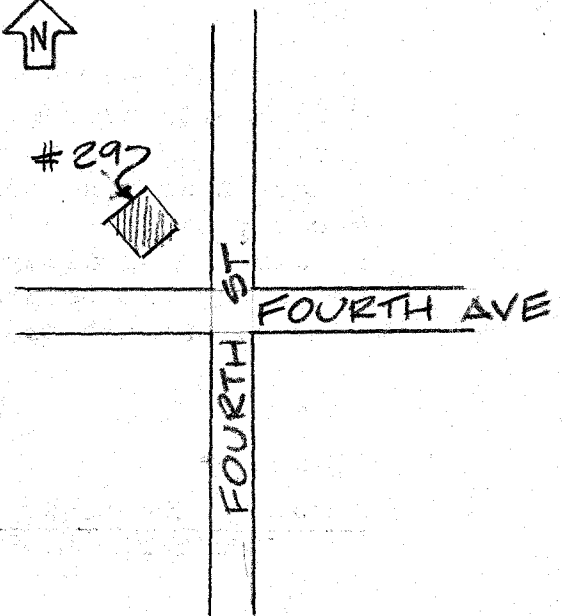

14. THREATS TO BUILDING: a. none known b. zoning c. roads
d. developers e. deterioration
f. other: _____
15. RELATED OUTBUILDINGS AND PROPERTY:
a. barn b. carriage house c. garage
d. privy e. shed f. greenhouse
g. shop h. gardens
i. landscape features: _____
j. other: _____
16. SURROUNDINGS OF THE BUILDING (check more than one if necessary):
a. open land b. woodland
c. scattered buildings
d. densely built-up e. commercial
f. industrial g. residential
h. other: _____

17. INTERRELATIONSHIP OF BUILDING AND SURROUNDINGS:
(Indicate if building or structure is in an historic district)
29 Fourth Avenue is set at an angle to the street. It is surrounded by trees at the rear of a rolling, open lawn.

18. OTHER NOTABLE FEATURES OF BUILDING AND SITE (including interior features if known):
Flared Hip roof with cross dormers. Dormer in front of roof with gothic muntins. Recessed pediment over small front dormer. Dentils under eaves. Original windows. Oval window and large window flanking entry. Continuous porch surrounding house with flanking pavillions. Brick foundation. Pilaster
SIGNIFICANCE Chimney emanating from peak of roof.

19. DATE OF INITIAL CONSTRUCTION: _____
ARCHITECT: _____
BUILDER: _____

20. HISTORICAL AND ARCHITECTURAL IMPORTANCE:
29 Fourth Avenue is a two and one half story three bay Colonial Revival house with details typical of its period. Of particular interest are the porch pavillions that are covered by trees. The way the house is set at an angle to the street gives it an air of formality not normally found with a house of its size. The house can be located on a 1915 Atlas of Brentwood at which time it was the property of O.H. Watson.

21. SOURCES:
Atlas of the Ocean Shore of Suffolk County (Westerly Section)
New York: E. Belcher Hyde, 1915. Plate 17.

22. THEME:
Research by the Society for the Preservation of L.I. Antiquities
EFW