

BUILDING-STRUCTURE INVENTORY FORM

DIVISION FOR HISTORIC PRESERVATION
NEW YORK STATE PARKS AND RECREATION
ALBANY, NEW YORK (518) 474-0479

FOR OFFICE USE ONLY	
UNIQUE SITE NO.	<u>103-05-0024-001</u>
QUAD	_____
SERIES	_____
NEG. NO.	_____

Quad IV
No. 18

YOUR NAME: Town of Islip DATE: August 25, 1975
Town Hall
YOUR ADDRESS: 655 Main Street TELEPHONE: (516) 581-2000

ORGANIZATION (if any): Department of Planning, Housing, & Development

IDENTIFICATION

- 1. BUILDING NAME(S): Formerly Fred Dominy House in 1915.
- 2. COUNTY: Suffolk TOWN/CITY: Islip VILLAGE: Bay Shore
- 3. STREET LOCATION: #33 Shore Lane (east side, bet. Gibson St. & Maple Ct.)
- 4. OWNERSHIP: a. public b. private
- 5. PRESENT OWNER: _____ ADDRESS: _____
- 6. USE: Original: Residence Present: Residence
- 7. ACCESSIBILITY TO PUBLIC: Exterior visible from public road: Yes No
Interior accessible: Explain By appointment only.

DESCRIPTION

- 8. BUILDING MATERIAL: a. clapboard b. stone c. brick d. board and batten
e. cobblestone f. shingles g. stucco other: _____
- 9. STRUCTURAL SYSTEM: (if known) a. wood frame with interlocking joints
b. wood frame with light members
c. masonry load bearing walls
d. metal (explain) _____
e. other _____
- 10. CONDITION: a. excellent b. good c. fair d. deteriorated
- 11. INTEGRITY: a. original site b. moved if so, when? _____
c. list major alterations and dates (if known): _____

12. PHOTO:

13. MAP:

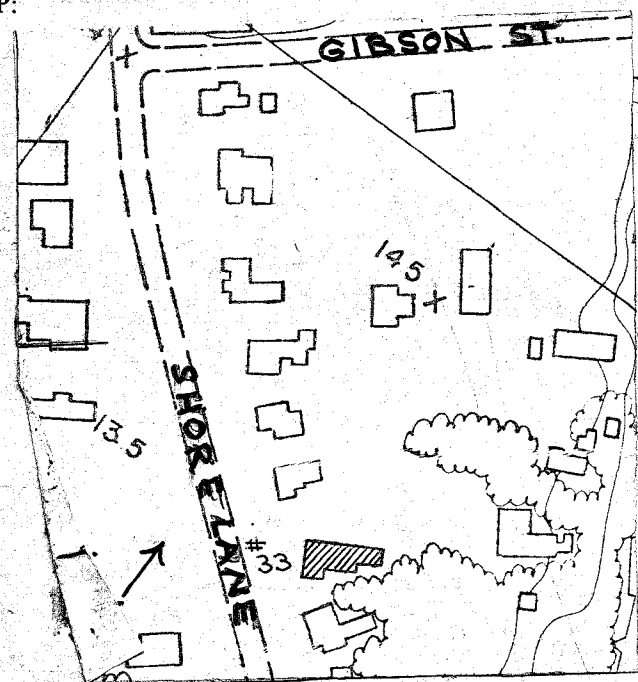

HP-1 Bay Shore Roll #Q5; Neg. #3
Front (west) & North facades.

14. THREATS TO BUILDING: a. none known b. zoning c. roads
d. developers e. deterioration
f. other: _____
15. RELATED OUTBUILDINGS AND PROPERTY:
a. barn b. carriage house c. garage
d. privy e. shed f. greenhouse
g. shop h. gardens
i. landscape features: _____
j. other: _____
16. SURROUNDINGS OF THE BUILDING (check more than one if necessary):
a. open land b. woodland
c. scattered buildings
d. densely built-up e. commercial
f. industrial g. residential
h. other: _____

17. INTERRELATIONSHIP OF BUILDING AND SURROUNDINGS:

(Indicate if building or structure is in an historic district)

This house is in a residential area which runs south from Main Street to the Great South Bay. There are numerous houses of architectural significance in the area, particularly from the Victorian Era, in the Queen Anne and Italianate styles.

18. OTHER NOTABLE FEATURES OF BUILDING AND SITE (including interior features if known):

This two and one-half story Victorian house has much of its original detail. The roof line retains decorative brackets, dentils, and frieze. The porch has turned posts with scrollwork, and a simple balustrade. There are dentils at the window heads. The gable windows are pointed. The foundation is brick.

SIGNIFICANCE

19. DATE OF INITIAL CONSTRUCTION: unknown

ARCHITECT: unknown

BUILDER: unknown

20. HISTORICAL AND ARCHITECTURAL IMPORTANCE:

This is a fine example of a Victorian house with much of its original detail, i.e. brackets, dentils, frieze, turned posts and scrollwork. The building is cross gabled; there is a projecting bay window on the north side, with a rectangular projection above it. The front door has a transom and sidelights. The windows, other than the gable windows, are rectangular with dentils at the heads. The first floor front windows reach almost to the floor level.

21. SOURCES:

Atlas of the Ocean Shore of Suffolk County, L.I. (Westerly Section). Brooklyn & Manhattan: E. Belcher Hyde, 1915. Volume I. Plate 21.

22. THEME: