

BUILDING-STRUCTURE INVENTORY FORM

DIVISION FOR HISTORIC PRESERVATION
NEW YORK STATE PARKS AND RECREATION
ALBANY, NEW YORK (518) 474-0479

FOR OFFICE USE ONLY
UNIQUE SITE NO. 103-05-0113
QUAD _____
SERIES _____
NEG. NO. _____

IVx-7
001
Quad IV Ext
No. 7

YOUR NAME: Town of Islip DATE: September 17, 1975
Town Hall
YOUR ADDRESS: 655 Main Street TELEPHONE: (516) 581-2000
ORGANIZATION (if any): Department of Planning, Housing & Development

IDENTIFICATION

- 1. BUILDING NAME(S): ~~Formerly~~ N.W. Tausig House / Formerly Fountain House
- 2. COUNTY: Suffolk TOWN/CITY: Islip VILLAGE: Bay Shore
- 3. STREET LOCATION: #80 Shore ~~Roll #80~~ (~~east side, north of Aldrich Court~~)
- 4. OWNERSHIP: a. public b. private
- 5. PRESENT OWNER: _____ ADDRESS: _____
- 6. USE: Original: Residence Present: Residence
- 7. ACCESSIBILITY TO PUBLIC: Exterior visible from public road: Yes No
Interior accessible: Explain By appointment only.

DESCRIPTION

- 8. BUILDING MATERIAL: a. clapboard b. stone c. brick d. board and batten
e. cobblestone f. shingles g. stucco other: _____
- 9. STRUCTURAL SYSTEM: (if known) a. wood frame with interlocking joints
b. wood frame with light members
c. masonry load bearing walls
d. metal (explain) _____
e. other _____
- 10. CONDITION: a. excellent b. good c. fair d. deteriorated
- 11. INTEGRITY: a. original site b. moved if so, when? _____
c. list major alterations and dates (if known): _____

Glassed in first floor porch.

12. PHOTO:

13. MAP:

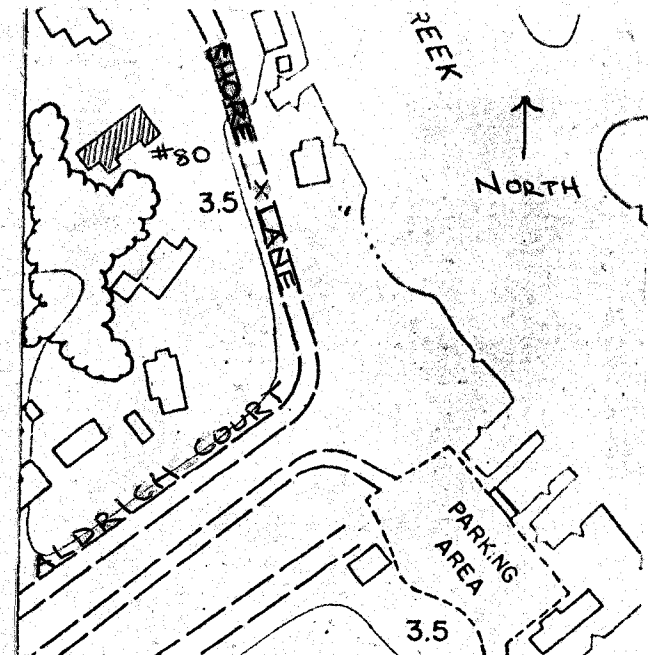

HP-1

Bay Shore Roll #Q6; Neg. #15
South (front) & East sides

14. THREATS TO BUILDING: a. none known b. zoning c. roads
d. developers e. deterioration
f. other: _____

15. RELATED OUTBUILDINGS AND PROPERTY:
a. barn b. carriage house c. garage
d. privy e. shed f. greenhouse
g. shop h. gardens
i. landscape features: _____
j. other: cottage

16. SURROUNDINGS OF THE BUILDING (check more than one if necessary):
a. open land b. woodland
c. scattered buildings
d. densely built-up e. commercial
f. industrial g. residential
h. other: _____

17. INTERRELATIONSHIP OF BUILDING AND SURROUNDINGS:
(Indicate if building or structure is in an historic district)

This house is in a residential area which runs south from Main Street to the Great South Bay. There are numerous houses of architectural significance in the area, ranging from rural Greek Revival to formal Colonial Revival, with Victorian predominating.

18. OTHER NOTABLE FEATURES OF BUILDING AND SITE (including interior features if known):
This large two and one-half story Colonial Revival house is in unspoiled condition, retaining all its original detail. The three front dormers are gabled with return cornices; they have round headed windows with ornamental upper sash, and triangular casement side windows. The steep gabled roof has a return cornice as does the projecting wing.

SIGNIFICANCE

19. DATE OF INITIAL CONSTRUCTION: circa 1916

ARCHITECT: unknown

BUILDER: unknown

20. HISTORICAL AND ARCHITECTURAL IMPORTANCE:

This Colonial Revival house retains its original windows, porches, shutters, cornices with fretwork, balustrades, pilasters, etc. The two second story porches have Chippendale railings and urn-shaped finials on the newel posts. The gabled one bay front entrance porch has a return cornice, classical columns, pilasters, an ornamental semi-circular fanlight, sidelights, decorative molding and festoons. The first and second floors have rectangular windows. The east wing has a Palladian window with an ornamental design in the upper sash. There is another Palladian window in the rear over a projecting semi-circular entrance porch with railing above. The main section's east gable has an ornamented circular window. The rear has shed roof dormers.

21. SOURCES: It has been said that Greek sailors were billeted here during World War II.

Interview with Resident and Owner of House, September, 1975.

22. THEME: