

**BUILDING-STRUCTURE INVENTORY FORM**

DIVISION FOR HISTORIC PRESERVATION  
NEW YORK STATE PARKS AND RECREATION  
ALBANY, NEW YORK (518) 474-0479

FOR OFFICE USE ONLY  
UNIQUE SITE NO. 103-05-0026  
QUAD \_\_\_\_\_  
SERIES \_\_\_\_\_  
NEG. NO. \_\_\_\_\_

001  
Quad IV  
No. 20

YOUR NAME: Town of Islip DATE: August 25, 1975  
Town Hall  
YOUR ADDRESS: 655 Main Street TELEPHONE: (516) 581-2000  
ORGANIZATION (if any): Department of Planning, Housing & Development

\*\*\*\*\*

**IDENTIFICATION**

- 1. BUILDING NAME(S): J.R. Howell House "Cattis Lodge" in 1915.
- 2. COUNTY: Suffolk TOWN/CITY: Islip VILLAGE: Bay Shore
- 3. STREET LOCATION: #51 Shore Lane (east side)
- 4. OWNERSHIP: a. public  b. private
- 5. PRESENT OWNER: \_\_\_\_\_ ADDRESS: \_\_\_\_\_
- 6. USE: Original: Residence Present: Residence
- 7. ACCESSIBILITY TO PUBLIC: Exterior visible from public road: Yes  No   
Interior accessible: Explain By appointment only.

**DESCRIPTION**

- 8. BUILDING MATERIAL: a. clapboard  b. stone  c. brick  d. board and batten   
e. cobblestone  f. shingles  g. stucco  other: \_\_\_\_\_
- 9. STRUCTURAL SYSTEM: (if known) a. wood frame with interlocking joints   
b. wood frame with light members   
c. masonry load bearing walls   
d. metal (explain) \_\_\_\_\_  
e. other \_\_\_\_\_
- 10. CONDITION: a. excellent  b. good  c. fair  d. deteriorated
- 11. INTEGRITY: a. original site  b. moved  if so, when? \_\_\_\_\_  
c. list major alterations and dates (if known):  
New siding.

12. PHOTO:

13. MAP:

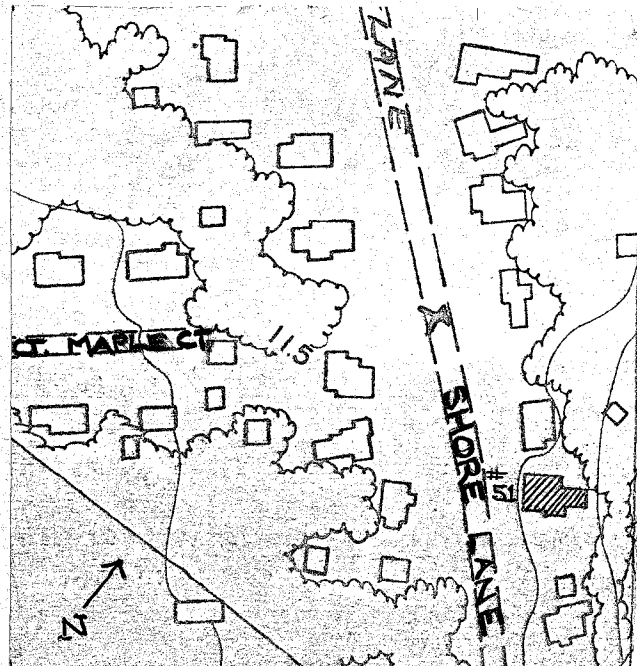

HP-1 Bay Shore Roll #Q5; Neg. #5  
North & West (front) Facades.

14. THREATS TO BUILDING: a. none known  b. zoning  c. roads   
 d. developers  e. deterioration   
 f. other: \_\_\_\_\_
15. RELATED OUTBUILDINGS AND PROPERTY:  
 a. barn  b. carriage house  c. garage   
 d. privy  e. shed  f. greenhouse   
 g. shop  h. gardens   
 i. landscape features: \_\_\_\_\_  
 j. other: \_\_\_\_\_
16. SURROUNDINGS OF THE BUILDING (check more than one if necessary):  
 a. open land  b. woodland   
 c. scattered buildings   
 d. densely built-up  e. commercial   
 f. industrial  g. residential   
 h. other: \_\_\_\_\_

17. INTERRELATIONSHIP OF BUILDING AND SURROUNDINGS:

(Indicate if building or structure is in an historic district)

This house is in a residential area which runs south from Main Street to the Great South Bay. There are numerous houses of architectural significance in the area, particularly those from the Victorian Era, in the Queen Anne and Italianate styles.

18. OTHER NOTABLE FEATURES OF BUILDING AND SITE (including interior features if known):

This two and one-half story house is in the Queen Anne Style. There is a porch along the front and south sides; it has turned posts and its stair entrance is pedimented. The porch extends to a porte-cochere on the north side. There is a gabled projection at the third story of the front facade.

SIGNIFICANCE

19. DATE OF INITIAL CONSTRUCTION: unknown

ARCHITECT: unknown

BUILDER: unknown

20. HISTORICAL AND ARCHITECTURAL IMPORTANCE:

This Queen Anne style house has recently been refurbished, while retaining much of its original detail. On the north facade there is a Gothic window with an ornamental design and stained glass. There are original multi-paned Queen Anne style windows in the gables and hipped-roof dormers. The front door is flanked by leaded glass windows. The third floor front gable projects; the south side has a gable and two story bay window. The Gothic window is on a gabled projection on the north side. The porch and porte-cochere have turned posts. The foundation is brick; there is a wide central chimney. The house was one of several owned by J.R. Howell which were rented out in the summer.

21. SOURCES: Atlas of the Ocean Shore of Suffolk County, L.I. (Westerly Section). Brooklyn & Manhattan: E. Belcher Hyde, 1915. Vol.I. Plate 21. Interview with Mrs. Mooney, granddaughter of J.R. Howell and long-time Bay Shore Resident, 5 West Drive, Bay Shore, August, 1975.

22. THEME: