

BUILDING-STRUCTURE INVENTORY FORM

DIVISION FOR HISTORIC PRESERVATION
NEW YORK STATE PARKS AND RECREATION
ALBANY, NEW YORK (518) 474-0479

FOR OFFICE USE ONLY
UNIQUE SITE NO. 103-05-0027
QUAD _____
SERIES _____
NEG. NO. _____

DO 1
Quad IV
No. 21

YOUR NAME: Town of Islip DATE: August 25, 1975
Town of Islip
YOUR ADDRESS: 655 Main Street TELEPHONE: (516) 581-2000

ORGANIZATION (if any): Department of Planning, Housing & Development

IDENTIFICATION

- 1. BUILDING NAME(S): Formerly Mrs. S. King House
- 2. COUNTY: Suffolk TOWN/CITY: Islip VILLAGE: Bay Shore
- 3. STREET LOCATION: 36 Shore Lane (west side, bet. Gibson St. & Maple St.)
- 4. OWNERSHIP: a. public b. private
- 5. PRESENT OWNER: _____ ADDRESS: _____
- 6. USE: Original: Residence Present: Residence
- 7. ACCESSIBILITY TO PUBLIC: Exterior visible from public road: Yes No
Interior accessible: Explain BY appointment only.

DESCRIPTION

- 8. BUILDING MATERIAL: a. clapboard b. stone c. brick d. board and batten
e. cobblestone f. shingles g. stucco other: shakes
- 9. STRUCTURAL SYSTEM: (if known) a. wood frame with interlocking joints
b. wood frame with light members
c. masonry load bearing walls
d. metal (explain) _____
e. other _____
- 10. CONDITION: a. excellent b. good c. fair d. deteriorated
- 11. INTEGRITY: a. original site b. moved if so, when? _____
c. list major alterations and dates (if known): _____

New shakes.



13. MAP:

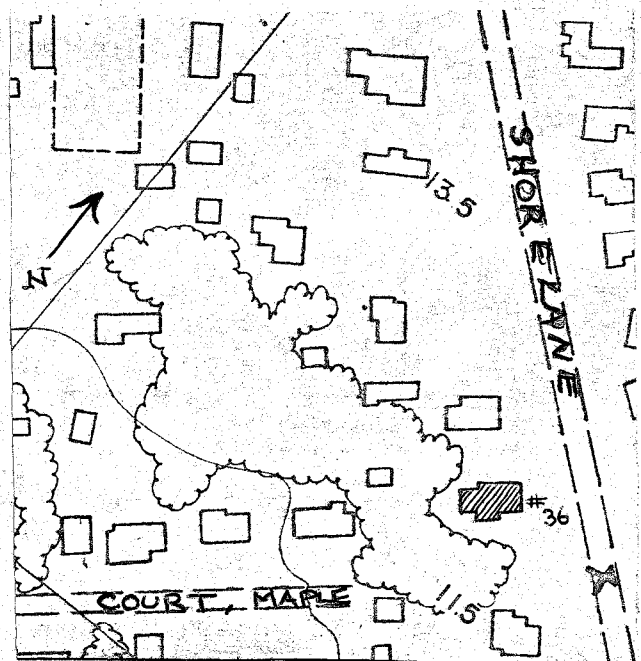

HP-1 Bay Shore Roll #Q5; Neg. #6
Front (east) Facade

14. THREATS TO BUILDING: a. none known b. zoning c. roads
d. developers e. deterioration
f. other: _____

15. RELATED OUTBUILDINGS AND PROPERTY:
a. barn b. carriage house c. garage
d. privy e. shed f. greenhouse
g. shop h. gardens
i. landscape features: _____
j. other: _____

16. SURROUNDINGS OF THE BUILDING (check more than one if necessary):
a. open land b. woodland
c. scattered buildings
d. densely built-up e. commercial
f. industrial g. residential
h. other: _____

17. INTERRELATIONSHIP OF BUILDING AND SURROUNDINGS:
(Indicate if building or structure is in an historic district)

This house is in a residential area which runs south from Main Street to the Great South Bay. There are numerous houses of architectural significance in the area, particularly from the Victorian Era, in the Queen Anne and Italianate styles.

18. OTHER NOTABLE FEATURES OF BUILDING AND SITE (including interior features if known):
The dominant element of this Victorian house is its original porch. The porch extends along the front and around half the south side. It has round turned posts and jigsaw brackets. There are drops in the center of the porch's semi-elliptical arches. The porch eaves have brackets; the frieze is simply panelled.

SIGNIFICANCE

19. DATE OF INITIAL CONSTRUCTION: unknown

ARCHITECT: unknown

BUILDER: unknown

20. HISTORICAL AND ARCHITECTURAL IMPORTANCE:

This two and one-half story Victorian house is three bays wide; there is a wing on the south side. The original porch has brackets, drops, and turned posts on brick piers. The houses's windows are rectangular with simple architraves. There are pointed windows in the gables. The front door is double-leafed. The foundation is brick.

21. SOURCES:

Atlas of the Ocean Shore of Suffolk County, L.I. (Westerly Section). Volume I. Amityville to Eastport Inclusive. Brooklyn & Manhattan: E. Belcher Hyde, 1915. Plate 21.

22. THEME:

Research by the Society for the Preservation of Long Island Antiquities.
(Judith Saltzman)