

BUILDING-STRUCTURE INVENTORY FORM

DIVISION FOR HISTORIC PRESERVATION
NEW YORK STATE PARKS AND RECREATION
ALBANY, NEW YORK (518) 474-0479

FOR OFFICE USE ONLY
UNIQUE SITE NO. 103-05-0083-001
QUAD _____
SERIES _____
NEG. NO. _____

Quad IV
No. 16

YOUR NAME: Town of Islip DATE: August 18, 1975
Town Hall

YOUR ADDRESS: 655 Main Street TELEPHONE: (516) 581-2000

ORGANIZATION (if any): Department of Planning, Housing & Development

IDENTIFICATION

- 1. BUILDING NAME(S): ~~Mack House~~; Edward Robbins House
- 2. COUNTY: Suffolk TOWN/CITY: Islip VILLAGE: Bay Shore
- 3. STREET LOCATION: #25 Shore Lane (east side, bet. Gibson St. & Maple Ct.)
- 4. OWNERSHIP: a. public b. private
- 5. PRESENT OWNER: Mack ADDRESS: Resident
- 6. USE: Original: Residence Present: Residence
- 7. ACCESSIBILITY TO PUBLIC: Exterior visible from public road: Yes No
Interior accessible: Explain By appointment only.

DESCRIPTION

- 8. BUILDING MATERIAL: a. clapboard b. stone c. brick d. board and batten
e. cobblestone f. shingles g. stucco other: _____
- 9. STRUCTURAL SYSTEM: a. wood frame with interlocking joints
(if known) b. wood frame with light members
c. masonry load bearing walls
d. metal (explain) _____
e. other _____
- 10. CONDITION: a. excellent b. good c. fair d. deteriorated
- 11. INTEGRITY: a. original site b. moved if so, when? _____
c. list major alterations and dates (if known):
New asphalt shingles. Front porch gone.



Day Shore Roll #Q4; Neg. #18
HP-1 Front (west) facade.

13. MAP:

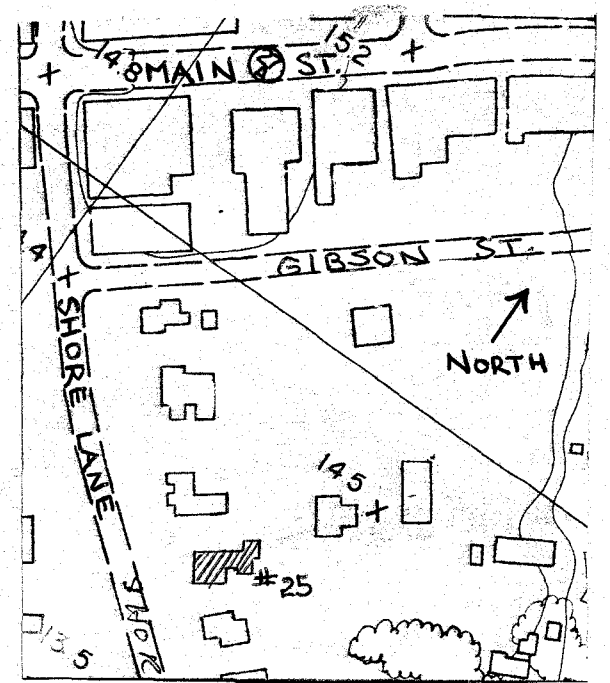

14. THREATS TO BUILDING: a. none known b. zoning c. roads
 d. developers e. deterioration
 f. other: _____
15. RELATED OUTBUILDINGS AND PROPERTY:
 a. barn b. carriage house c. garage
 d. privy e. shed f. greenhouse
 g. shop h. gardens
 i. landscape features: _____
 j. other: _____
16. SURROUNDINGS OF THE BUILDING (check more than one if necessary):
 a. open land b. woodland
 c. scattered buildings
 d. densely built-up e. commercial
 f. industrial g. residential
 h. other: _____

17. INTERRELATIONSHIP OF BUILDING AND SURROUNDINGS:
 (Indicate if building or structure is in an historic district)

This house is in a residential area running from Main Street south to the Great South Bay. There are numerous houses of architectural significance in the area, particularly those from the Victorian Era in the Italianate and Queen Anne styles.

18. OTHER NOTABLE FEATURES OF BUILDING AND SITE (including interior features if known):
 This two and one-half story Italianate house retains much of its original detail, both on the exterior and interior. There are decorative brackets with terminal drops, and bracketed window heads with scalloped friezes. The interior retains original window and door architraves, panelled ceilings, and stairways.

SIGNIFICANCE

19. DATE OF INITIAL CONSTRUCTION: unknown
 ARCHITECT: unknown
 BUILDER: unknown

20. HISTORICAL AND ARCHITECTURAL IMPORTANCE:

This house is a fine example of the Italianate style. The window architraves with brackets and friezes have either rectangular or pointed heads. The gable roof has a plain frieze and brackets with terminal drops. The north side has a projecting section with a cross gable. There is a pilastered bay window with brackets on the south side. The front doorway is pilastered and has a blind transom. The interior has the original curved stairway, as well as the simpler back stairway. There are two fireplaces; the foundation is brick.

21. SOURCES:

Atlas of the Ocean Shore of Suffolk County, L.I. (Westerly Section). Volume I. Amityville to Eastport Inclusive. Brooklyn & Manhattan: E. Belcher Hyde, 1915. Plate 21.

22. THEME: Interview with Mrs. Mack, owner & resident. August 12, 1975.

Research by the Society for the Preservation of Long Island Antiquities.
 (Judith Saltzman)

Sound. Above the main highway this thoroughfare was later called Telegraph Road, leading to Thompson's Station on the railroad.

When Nathaniel Smith died on February 27, 1787, he left his farm to two sons, Philip and Walter, who divided the property by making Bay Avenue the boundary--Walter took the east portion, Philip the west. Deeds covering such transactions are amusing today, because the ancient markers mentioned are gone--for example: pear trees, fences, bars in the fence, and a walnut bush in the hedge.

Walter was the father of Treadwell, Ezra, Benjamin, and Edgar Smith, all of whom were heirs. Treadwell bought some property from his brothers and began developing it into lots for cranberries, orchards, etc. He ran a general store on Main Street. In 1865 he developed Ocean Avenue from alongside his store down to the Bay.

Meanwhile South Bay Shore Avenue (Shore Lane) had been opened down to a public dock on Penataquit Creek near the bay, where Selah Howell, a well-known boat builder, had his place of business. Aldrich Court was not laid out until many years later when it seemed advisable for the township to construct a link between South Bay Shore and Maple Avenues.

In the central section Joshua Wicks owned a vast tract of woodland, covered with tall trees. Upon his death he left property to several sons, among whom was Selah Wicks,