

BUILDING-STRUCTURE INVENTORY FORM

DIVISION FOR HISTORIC PRESERVATION
 NEW YORK STATE PARKS AND RECREATION
 ALBANY, NEW YORK (518) 474-0479

FOR OFFICE USE ONLY
 UNIQUE SITE NO. 103-05-0029-001
 QUAD _____
 SERIES _____
 NEG. NO. _____

Quad IV
 No. 23

YOUR NAME: Town of Islip DATE: August 27, 1975
Town Hall

YOUR ADDRESS: 655 Main Street TELEPHONE: (516) 581-2000

ORGANIZATION (if any): Department of Planning, Housing & Development

IDENTIFICATION

1. BUILDING NAME(S): Formerly Josiah Robbins House in 1915.
2. COUNTY: Suffolk TOWN/CITY: Islip VILLAGE: Bay Shore
3. STREET LOCATION: 118 Shore Lane (west side, bet. Gibson St. & Maple St.)
4. OWNERSHIP: a. public b. private
5. PRESENT OWNER: _____ ADDRESS: _____
6. USE: Original: Residence Present: Residence
7. ACCESSIBILITY TO PUBLIC: Exterior visible from public road: Yes No
 Interior accessible: Explain By appointment only.

DESCRIPTION

8. BUILDING MATERIAL: a. clapboard b. stone c. brick d. board and batten
 e. cobblestone f. shingles g. stucco other: _____
9. STRUCTURAL SYSTEM: (if known) a. wood frame with interlocking joints
 b. wood frame with light members
 c. masonry load bearing walls
 d. metal (explain) _____
 e. other _____
10. CONDITION: a. excellent b. good c. fair d. deteriorated
11. INTEGRITY: a. original site b. moved if so, when? _____
 c. list major alterations and dates (if known):

Partially reshingled.

12. PHOTO:

13. MAP:

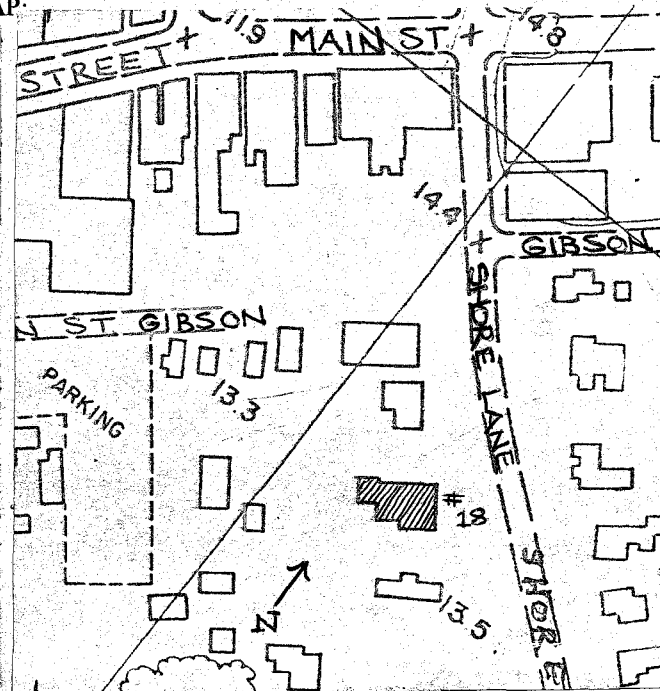

HP-1

Bay Shore Roll #05; Neg. #1
 East (front) & South facades.

14. THREATS TO BUILDING: a. none known b. zoning c. roads
d. developers e. deterioration
f. other: _____
15. RELATED OUTBUILDINGS AND PROPERTY:
a. barn b. carriage house c. garage
d. privy e. shed f. greenhouse
g. shop h. gardens
i. landscape features: Iron fence of the period.
j. other: _____
16. SURROUNDINGS OF THE BUILDING (check more than one if necessary):
a. open land b. woodland
c. scattered buildings
d. densely built-up e. commercial
f. industrial g. residential
h. other: _____

17. INTERRELATIONSHIP OF BUILDING AND SURROUNDINGS:
(Indicate if building or structure is in an historic district)

This house is in a residential area which runs south from Main Street to the Great South Bay. There are numerous houses of architectural significance in the area, particularly from the Victorian Era - in the Italianate and Queen Anne styles.

18. OTHER NOTABLE FEATURES OF BUILDING AND SITE (including interior features if known):
This two and one-half story Queen Anne style house has a round tower, porch, and eyebrow windows. The porch has turned posts (coupled) and a balustrade; it curves at the northeast corner, following the line of the tower. There are original brackets at the roof, porch, and tower. The eyebrow windows are on the front (east) and south facades.

SIGNIFICANCE

19. DATE OF INITIAL CONSTRUCTION: unknown
- ARCHITECT: unknown
- BUILDER: unknown

20. HISTORICAL AND ARCHITECTURAL IMPORTANCE:

This house has a variety of Queen Anne style elements; projections include the round tower, porch, eyebrow windows, third story front gable, and bay window on the north side. There is a gabled clapboard wing on the south side, and a gabled third story projection on the north side. The surface materials are a mixture of clapboard and shingle; the gables have fish-scale shingles. The porch entrance is gabled with a semi-circular inset, and brackets below. Original brackets are retained under projections and at eaves; they appear at three levels. With the exception of the eyebrow windows, the windows are rectangular, with simple architraves. On the north side of the house there is a horizontal window with diamond shaped panes.

21. SOURCES:

Atlas of the Ocean Shore of Suffolk County, LI. (Westerly Section). Brooklyn & Manhattan: E. Belcher Hyde, 1915. Volume I. Plate 21.

22. THEME:

Research by the Society for the Preservation of Long Island Antiquities.
(Judith Saltzman)