

393-02-65 thru 69 ✓

**BUILDING-STRUCTURE INVENTORY FORM**

DIVISION FOR HISTORIC PRESERVATION  
NEW YORK STATE PARKS AND RECREATION  
ALBANY, NEW YORK (518) 474-0479

FOR OFFICE USE ONLY	
UNIQUE SITE NO. _____	Quad I
QUAD _____	No. 23
SERIES _____	
NEG. NO. _____	

YOUR NAME: Town of Islip DATE: September 26, 1975

YOUR ADDRESS: Town Hall  
655 Main Street TELEPHONE: (516) 581-2000

ORGANIZATION (if any): Department of Planning, Housing & Development

\*\*\*\*\*

**IDENTIFICATION**

- 1. BUILDING NAME(S): Group of five Victorian houses on Park Avenue
- 2. COUNTY: Suffolk TOWN/CITY: Islip VILLAGE: Bay Shore
- 3. STREET LOCATION: #42, #46, #48, #50, and #52 Park Avenue (west side)
- 4. OWNERSHIP: a. public  b. private
- 5. PRESENT OWNER: \_\_\_\_\_ ADDRESS: \_\_\_\_\_
- 6. USE: Original: Residences Present: Residences
- 7. ACCESSIBILITY TO PUBLIC: Exterior visible from public road: Yes  No   
Interior accessible: Explain By appointment only

**DESCRIPTION**

- 8. BUILDING MATERIAL: a. clapboard  b. stone  c. brick  d. board and batten   
e. cobblestone  f. shingles  g. stucco  other: varied
- 9. STRUCTURAL SYSTEM: a. wood frame with interlocking joints   
(if known) b. wood frame with light members   
c. masonry load bearing walls   
d. metal (explain) \_\_\_\_\_  
e. other \_\_\_\_\_
- 10. CONDITION: a. excellent  b. good  c. fair  d. deteriorated
- 11. INTEGRITY: a. original site  b. moved  if so, when? \_\_\_\_\_  
c. list major alterations and dates (if known): \_\_\_\_\_

#50: new first floor window and door; new siding.  
#48: new shingles.

12. PHOTO:



13. MAP:

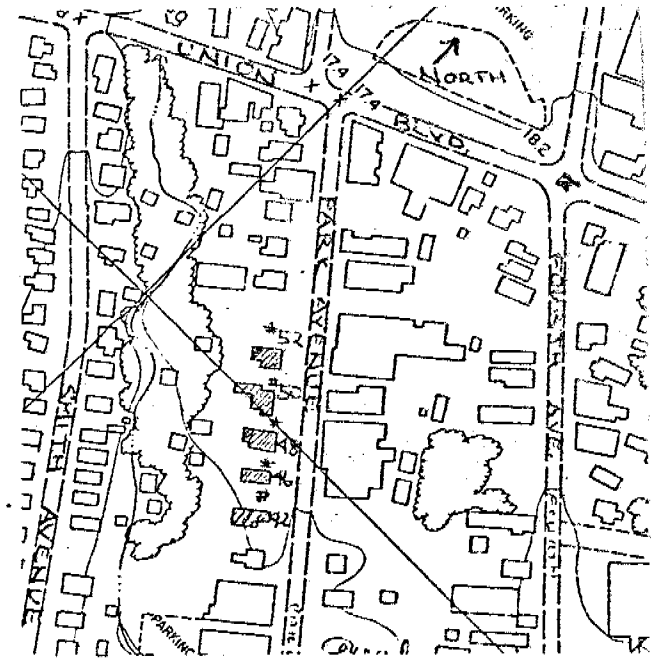

HP-1 Roll #07; Negative #10  
House #52; South & East (front) Sides.

14. THREATS TO BUILDING: a. none known  b. zoning  c. roads   
 d. developers  e. deterioration   
 f. other: \_\_\_\_\_
15. RELATED OUTBUILDINGS AND PROPERTY:  
 a. barn  b. carriage house  c. garage   
 d. privy  e. shed  f. greenhouse   
 g. shop  h. gardens   
 i. landscape features: \_\_\_\_\_  
 j. other: \_\_\_\_\_
16. SURROUNDINGS OF THE BUILDING (check more than one if necessary):  
 a. open land  b. woodland   
 c. scattered buildings   
 d. densely built-up  e. commercial   
 f. industrial  g. residential   
 h. other: \_\_\_\_\_

17. INTERRELATIONSHIP OF BUILDING AND SURROUNDINGS:  
 (Indicate if building or structure is in an historic district)

This is a group of five Victorian houses on the west side of Park Avenue, between Main Street and Union Boulevard. It is surrounded by an area of mixed usage, including commercial and residential structures - some of which are architecturally significant.

18. OTHER NOTABLE FEATURES OF BUILDING AND SITE (including interior features if known):  
 This group of five houses is a fine example of Victorian structures in the area. They retain much of their original detail, including porches with turned posts, vergeboards, towers, friezes, brackets, stained glass windows, shingles, and clapboard.

SIGNIFICANCE

19. DATE OF INITIAL CONSTRUCTION: unknown

ARCHITECT: unknown

BUILDER: unknown

20. HISTORICAL AND ARCHITECTURAL IMPORTANCE:

- #42 has a square tower with a pointed roof and finial, brackets, and frieze. Original windows include stained glass panes around the upper sash. Original porch with turned posts, decorative balustrade, and gingerbread. Queen Anne style.
- #46 has a square tower with a pointed roof, original clapboard and shingles. The gable and tower have multi-paned windows. Original porch. Picket fence. Queen Anne style.
- #48 has an original porch with turned posts, curved stickwork in the gable, exposed rafter ends, and brackets.
- #50 has an original porch with turned posts and a balustrade. Original windows, cross gables. (Continued on attached sheet)

21. SOURCES:

Atlas of the Ocean Shore of Suffolk County, L.I. (Westerly Section). Brooklyn & Manhattan: E. Belcher Hyde, 1915. Volume I. Plate 21.

22. THEME:

Research by the Society for the Preservation of Long Island Antiquities. (Judith Saltzman)