

**BUILDING-STRUCTURE INVENTORY FORM**

DIVISION FOR HISTORIC PRESERVATION  
NEW YORK STATE PARKS AND RECREATION  
ALBANY, NEW YORK (518) 474-0479

**FOR OFFICE USE ONLY**  
UNIQUE SITE NO. 103-05-0034  
QUAD \_\_\_\_\_  
SERIES \_\_\_\_\_  
NEG. NO. \_\_\_\_\_

-D01  
Quad III Ext  
No. 1

YOUR NAME: Town of Islip DATE: August 28, 1975

YOUR ADDRESS: Town Hall  
655 Main Street TELEPHONE: (516) 581-2000

ORGANIZATION (if any): Department of Planning, Housing & Development

\*\*\*\*\*

**IDENTIFICATION**

- 1. BUILDING NAME(S): Banks House; Formerly E.E. Gold House in 1915.
- 2. COUNTY: Suffolk TOWN/CITY: Islip VILLAGE: Bay Shore
- 3. STREET LOCATION: Ocean Avenue; East side; just south of Linden Pl
- 4. OWNERSHIP: a. public  b. private
- 5. PRESENT OWNER: \_\_\_\_\_ ADDRESS: \_\_\_\_\_
- 6. USE: Original: Residence Present: Residence
- 7. ACCESSIBILITY TO PUBLIC: Exterior visible from public road: Yes  No   
Interior accessible: Explain By appointment only.

**DESCRIPTION**

- 8. BUILDING MATERIAL: a. clapboard  b. stone  c. brick  d. board and batten   
e. cobblestone  f. shingles  g. stucco  other: \_\_\_\_\_
- 9. STRUCTURAL SYSTEM: (if known) a. wood frame with interlocking joints   
b. wood frame with light members   
c. masonry load bearing walls   
d. metal (explain) \_\_\_\_\_  
e. other \_\_\_\_\_
- 10. CONDITION: a. excellent  b. good  c. fair  d. deteriorated
- 11. INTEGRITY: a. original site  b. moved  if so, when? \_\_\_\_\_  
c. list major alterations and dates (if known): \_\_\_\_\_

Multiple additions to original house.

12. PHOTO:

13. MAP:

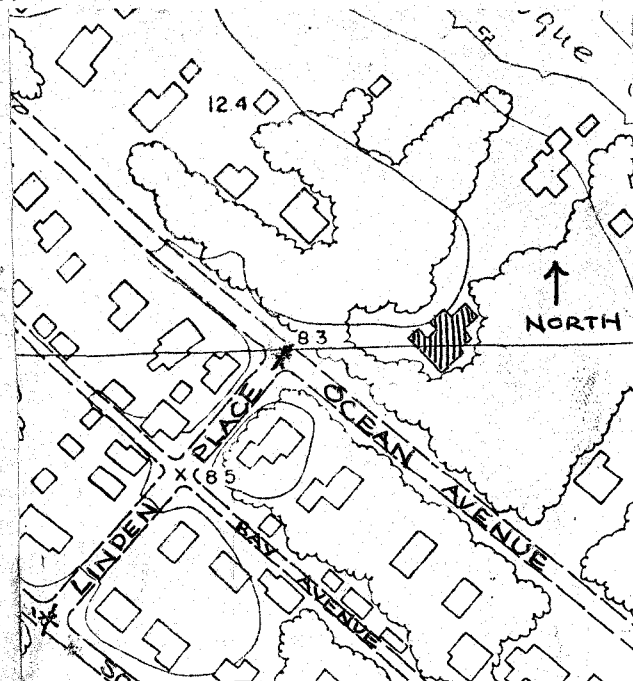

HP-1 Bay Shore Roll #Q5; Neg. #12  
North & West (front) Facades.

14. THREATS TO BUILDING: a. none known  b. zoning  c. roads   
d. developers  e. deterioration   
f. other: \_\_\_\_\_

15. RELATED OUTBUILDINGS AND PROPERTY:

- a. barn  b. carriage house  c. garage   
d. privy  e. shed  f. greenhouse   
g. shop  h. gardens

i. landscape features: Iron gates & ivy covered fence with brick  
j. other: Victorian structure with two cupolas piers.

16. SURROUNDINGS OF THE BUILDING (check more than one if necessary):

- a. open land  b. woodland   
c. scattered buildings   
d. densely built-up  e. commercial   
f. industrial  g. residential   
h. other: \_\_\_\_\_

17. INTERRELATIONSHIP OF BUILDING AND SURROUNDINGS:

(Indicate if building or structure is in an historic district)

This house is in a residential area which runs south from Main Street to the Great South Bay. There are numerous houses of architectural significance in the area, ranging from large Victorian structures to baymen's cottages.

18. OTHER NOTABLE FEATURES OF BUILDING AND SITE (including interior features if known):

This two and one-half story, five bay Colonial Revival house has a gambrel roof. There is an original porch extending to a porte-cochere on the north side and to a polygonal pavilion on the south. There is a polygonal wing behind the porte-cochere; the wing's windows are diamond paned, as are those of the south pavilion. The first floor front facade has French windows.

SIGNIFICANCE

19. DATE OF INITIAL CONSTRUCTION: unknown

ARCHITECT: unknown

BUILDER: unknown

20. HISTORICAL AND ARCHITECTURAL IMPORTANCE:

This is a fine example of a Colonial Revival house. There are three pilastered and pedimented dormers with six-over-one windows; the central dormer is larger than those flanking it. On the north and south gables there are Palladian type windows with panelled center sections. The original cornice with dentils is retained. The window architraves have projecting heads. The front door has blind side and transom panels. The chimneys are corbelled. The original porch, porte-cochere, south polygonal pavilion, and north polygonal wing have all been retained.

The house has undergone extensive additions; the original section is much older than the Colonial Revival style would indicate.

21. SOURCES: Atlas of the Ocean Shore of Suffolk County, L.I. (Westerly Section). Brooklyn & Manhattan: E. Belcher Hyde, 1915. Vol. I. Plate 21. Interview with Mr. Stellenwerf, long-time resident of Bay Shore, Ocean Ave., Bay Shore, August, 1975.

22. THEME: