

**BUILDING-STRUCTURE INVENTORY FORM**

DIVISION FOR HISTORIC PRESERVATION  
NEW YORK STATE PARKS AND RECREATION  
ALBANY, NEW YORK (518) 474-0479

FOR OFFICE USE ONLY  
UNIQUE SITE NO. 103-05-0100-001  
QUAD \_\_\_\_\_  
SERIES \_\_\_\_\_  
NEG. NO. \_\_\_\_\_

Quad III Ext  
No. 11

YOUR NAME: Town of Islip DATE: September 10, 1975

YOUR ADDRESS: Town Hall  
655 Main Street TELEPHONE: (516) 581-2000

ORGANIZATION (if any): Department of Planning, Housing & Development

\*\*\*\*\*

**IDENTIFICATION**

- 1. BUILDING NAME(S): House at #80 Ocean Avenue
- 2. COUNTY: Suffolk TOWN/CITY: Islip VILLAGE: Bay Shore
- 3. STREET LOCATION: #80 Ocean Ave. (west side, south of Linden Place)
- 4. OWNERSHIP: a. public  b. private
- 5. PRESENT OWNER: \_\_\_\_\_ ADDRESS: \_\_\_\_\_
- 6. USE: Original: Residence Present: Residence
- 7. ACCESSIBILITY TO PUBLIC: Exterior visible from public road: Yes  No   
Interior accessible: Explain By appointment only

**DESCRIPTION**

- 8. BUILDING MATERIAL: a. clapboard  b. stone  c. brick  d. board and batten   
e. cobblestone  f. shingles  g. stucco  other: \_\_\_\_\_
- 9. STRUCTURAL SYSTEM: (if known) a. wood frame with interlocking joints   
b. wood frame with light members   
c. masonry load bearing walls   
d. metal (explain) \_\_\_\_\_  
e. other \_\_\_\_\_
- 10. CONDITION: a. excellent  b. good  c. fair  d. deteriorated
- 11. INTEGRITY: a. original site  b. moved  if so, when? \_\_\_\_\_  
c. list major alterations and dates (if known):  
Enclosure of porch.

12. PHOTO:

13. MAP:

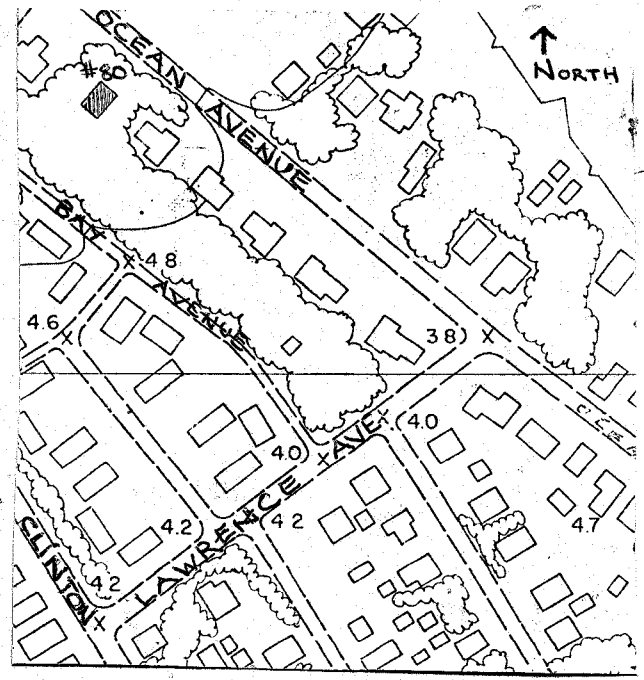

HP-1 Bay Shore Roll #06; Neg. #6  
Partial front and north sides.

14. THREATS TO BUILDING: a. none known  b. zoning  c. roads   
d. developers  e. deterioration   
f. other: \_\_\_\_\_

15. RELATED OUTBUILDINGS AND PROPERTY:  
a. barn  b. carriage house  c. garage   
d. privy  e. shed  f. greenhouse   
g. shop  h. gardens   
i. landscape features: \_\_\_\_\_  
j. other: \_\_\_\_\_

16. SURROUNDINGS OF THE BUILDING (check more than one if necessary):  
a. open land  b. woodland   
c. scattered buildings   
d. densely built-up  e. commercial   
f. industrial  g. residential   
h. other: \_\_\_\_\_

17. INTERRELATIONSHIP OF BUILDING AND SURROUNDINGS:  
(Indicate if building or structure is in an historic district)

The house is in a residential area which runs south from Main Street to the Great South Bay. There are numerous houses of architectural significance in the area, ranging from large Victorian structures to simple baymen's cottages.

18. OTHER NOTABLE FEATURES OF BUILDING AND SITE (including interior features if known):  
This brown shingled house has picturesque roof massing. The left front bay has a clipped gable; there are original brackets and a vergeboard with a sawtooth edge. The gable window is semi-circular. The right front gable has a vergeboard combining curves and trelliswork; there is a stained glass window with 15 panes in the upper sash.

**SIGNIFICANCE**

19. DATE OF INITIAL CONSTRUCTION: unknown

ARCHITECT: unknown

BUILDER: unknown

20. HISTORICAL AND ARCHITECTURAL IMPORTANCE:  
This house retains much of its original detail, i.e., brackets, vergeboards, trelliswork, and stained glass windows. There is a second story balcony with trelliswork and a simple balustrade, shielded by a curving sweep of roof. The north side of the house has gables with vergeboards, and diagonal trelliswork above the porch windows. The south side has a second story porch with trelliswork and a balustrade; the south gable has a simple vergeboard. There are two corbelled chimneys. This house may be the Fred Eddy house on the 1915 maps.

21. SOURCES:  
Atlas of the Ocean Shore of Suffolk County, LI. (Westerly Section).  
Brooklyn & Manhattan: E. Belcher Hyde, 1915. Volume I. Plate 21.

22. THEME: