

BUILDING-STRUCTURE INVENTORY FORM

DIVISION FOR HISTORIC PRESERVATION
NEW YORK STATE PARKS AND RECREATION
ALBANY, NEW YORK (518) 474-0479

FOR OFFICE USE ONLY
UNIQUE SITE NO. 103-05-0101 - 001
QUAD _____
SERIES _____
NEG. NO. _____

Quad IIIExt.
No. 12

YOUR NAME: Town of Islip DATE: September 10, 1975
Town Hall

YOUR ADDRESS: 655 Main Street TELEPHONE: (516) 581-2000

ORGANIZATION (if any): Department of Planning, Housing & Development

IDENTIFICATION

- 1. BUILDING NAME(S): House at #66 Ocean Avenue; O Donnell House
- 2. COUNTY: Suffolk TOWN/CITY: Islip VILLAGE: Bay Shore
- 3. STREET LOCATION: #66 Ocean Avenue (west side, south of Linden Place)
- 4. OWNERSHIP: a. public b. private
- 5. PRESENT OWNER: _____ ADDRESS: _____
- 6. USE: Original: Residence Present: Multiple Residence
- 7. ACCESSIBILITY TO PUBLIC: Exterior visible from public road: Yes No
Interior accessible: Explain By appointment only

DESCRIPTION

- 8. BUILDING MATERIAL: a. clapboard b. stone c. brick d. board and batten
e. cobblestone f. shingles g. stucco other: _____
- 9. STRUCTURAL SYSTEM: a. wood frame with interlocking joints
(if known) b. wood frame with light members
c. masonry load bearing walls
d. metal (explain) _____
e. other _____
- 10. CONDITION: a. excellent b. good c. fair d. deteriorated
- 11. INTEGRITY: a. original site b. moved if so, when? _____
c. list major alterations and dates (if known): _____

12. PHOTO:

13. MAP:

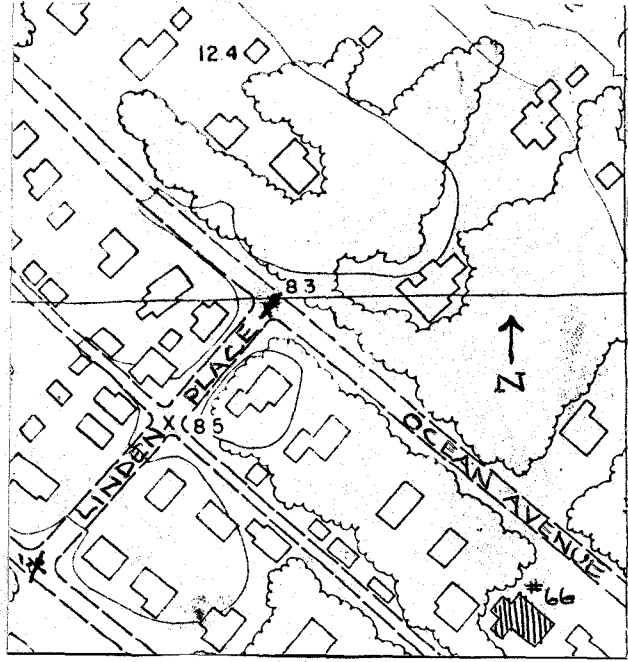

HP-1 Bay Shore Roll #Q6; Neg. #5
Front Facade

14. THREATS TO BUILDING: a. none known b. zoning c. roads
d. developers e. deterioration
f. other: _____
15. RELATED OUTBUILDINGS AND PROPERTY:
a. barn b. carriage house c. garage
d. privy e. shed f. greenhouse
g. shop h. gardens
i. landscape features: _____
j. other: _____
16. SURROUNDINGS OF THE BUILDING (check more than one if necessary):
a. open land b. woodland
c. scattered buildings
d. densely built-up e. commercial
f. industrial g. residential
h. other: _____

17. INTERRELATIONSHIP OF BUILDING AND SURROUNDINGS:
(Indicate if building or structure is in an historic district)

This house is in a residential area which runs south from Main Street to the Great South Bay. There are numerous houses of architectural significance in the area, ranging from large Victorian structures to simple baymen's cottages.

18. OTHER NOTABLE FEATURES OF BUILDING AND SITE (including interior features if known):
This two and one-half story Tudor-Style house has two projecting half-timbered gables either side of the center bay. There is a half-timbered dormer in the central bay. Under the front gables there are two bay windows on the second floor. There is another bay window on the first floor north of the door.

SIGNIFICANCE

19. DATE OF INITIAL CONSTRUCTION: unknown
ARCHITECT: unknown
BUILDER: unknown

20. HISTORICAL AND ARCHITECTURAL IMPORTANCE:

This large Tudor-Style house retains its original brackets, half-timbering, dormers, porch, and Tudor-style windows. The porch has a simple balustrade. There are two diamond-paned windows on either side of the front door. The main windows have three lights above casements. The gables and dormer have diamond-paned windows. There are half-timbered projecting gables with supporting brackets on both the north and south sides, as well as the front gables. The north side's gable is on a projecting wing. The south side's gable has a further projection in its peak above the gable windows. There is a rear wing. The pilastered chimneys have corbelled tops. This may have been the

21. SOURCES: Frank Farrell house in 1915.
Atlas of the Ocean Shore of Suffolk County, L.I. (Westerly Section).
Brooklyn & Manhattan: E. Belcher Hyde, 1915. Volume I. Plate 21.

22. THEME:

Research by the Society for the Preservation of Long Island Antiquities.
(Judith Saltzman)