

BUILDING-STRUCTURE INVENTORY FORM

**DIVISION FOR HISTORIC PRESERVATION
NEW YORK STATE PARKS AND RECREATION
ALBANY, NEW YORK (518) 474-0479**

FOR OFFICE USE ONLY

UNIQUE SITE NO. 103-05-0104
QUAD _____
SERIES _____
NEG. NO. _____

001
Quad IIIExt.
No. 15

YOUR NAME: Town of Islip DATE: September 10, 1975
Town Hall
YOUR ADDRESS: 655 Main Street TELEPHONE: (516) 581-2000

ORGANIZATION (if any): Department of Planning, Housing, & Development

IDENTIFICATION

- 1. BUILDING NAME(S): House at #56 Ocean Avenue
- 2. COUNTY: Suffolk TOWN/CITY: Islip VILLAGE: Bay Shore
- 3. STREET LOCATION: #56 Ocean Ave. (west side, south of Linden Place)
- 4. OWNERSHIP: a. public b. private
- 5. PRESENT OWNER: _____ ADDRESS: _____
- 6. USE: Original: Residence Present: Residence
- 7. ACCESSIBILITY TO PUBLIC: Exterior visible from public road: Yes No
Interior accessible: Explain By appointment only

DESCRIPTION

- 8. BUILDING MATERIAL: a. clapboard b. stone c. brick d. board and batten
e. cobblestone f. shingles g. stucco other: _____
- 9. STRUCTURAL SYSTEM: a. wood frame with interlocking joints
(if known) b. wood frame with light members
c. masonry load bearing walls
d. metal (explain) _____
e. other _____
- 10. CONDITION: a. excellent b. good c. fair d. deteriorated
- 11. INTEGRITY: a. original site b. moved if so, when? _____
c. list major alterations and dates (if known): _____

12. PHOTO:

13. MAP:

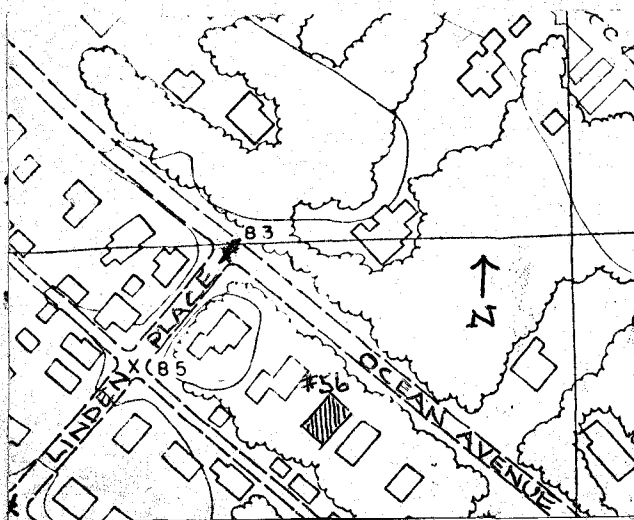

HP-1 Bay Shore Roll #Q6; Neg. #3
Front Facade

14. THREATS TO BUILDING: a. none known b. zoning c. roads
d. developers e. deterioration
f. other: _____
15. RELATED OUTBUILDINGS AND PROPERTY:
a. barn b. carriage house c. garage
d. privy e. shed f. greenhouse
g. shop h. gardens
i. landscape features: _____
j. other: _____
16. SURROUNDINGS OF THE BUILDING (check more than one if necessary):
a. open land b. woodland
c. scattered buildings
d. densely built-up e. commercial
f. industrial g. residential
h. other: _____

17. INTERRELATIONSHIP OF BUILDING AND SURROUNDINGS:

(Indicate if building or structure is in an historic district)

This house is in a residential area which runs south from Main Street to the Great South Bay. There are numerous houses of architectural significance in the area, ranging from Victorian and Colonial Revival Houses to simple baymen's cottages.

18. OTHER NOTABLE FEATURES OF BUILDING AND SITE (including interior features if known):

This unaltered hipped-roof house has its original double course shingles. The front porch has square columns on shingled piers. The front doorway has a five pane transom and two pane upper sidelights.

SIGNIFICANCE

19. DATE OF INITIAL CONSTRUCTION: unknown
- ARCHITECT: unknown
- BUILDER: unknown

20. HISTORICAL AND ARCHITECTURAL IMPORTANCE:

This house is a fine example of a style common in this area - two-and-one-half story shingled house with a hipped roof. The distinctive elements of this house are its fluted pilasters at the corners, and its double course shingles. The original windows have diamond-paned upper sash. The dormer has casement windows. There is a first floor projection on the south side with vertical diamond-paned windows. The roof has a wide overhang.

This may have been the C.B. Lawrence house in 1915.

21. SOURCES:

Atlas of the Ocean Shore of Suffolk County, LI. (Westerly Section).
Brooklyn & Manhattan: E. Belcher Hyde, 1915. Volume I. Plate 21.

22. THEME:

Research by the Society for the Preservation of Long Island Antiquities.
(Judith Saltzman)