

BUILDING-STRUCTURE INVENTORY FORM

DIVISION FOR HISTORIC PRESERVATION
NEW YORK STATE PARKS AND RECREATION
ALBANY, NEW YORK (518) 474-0479

442-01-017 ✓
FOR OFFICE USE ONLY
UNIQUE SITE NO. 10305_000042
QUAD _____
SERIES _____
NEG. NO. _____

Quad III Ext
No. 9

YOUR NAME: Town of Islip DATE: August 29, 1975
Town Hall

YOUR ADDRESS: 655 Main Street TELEPHONE: (516) 581-2000

ORGANIZATION (if any): Department of Planning, Housing & Development

IDENTIFICATION

- 1. BUILDING NAME(S): Veltman House
- 2. COUNTY: Suffolk TOWN/CITY: Islip VILLAGE: Bay Shore
- 3. STREET LOCATION: #112 Ocean Ave. (west side, bet. Lawrence & Bayview Aves.)
- 4. OWNERSHIP: a. public b. private
- 5. PRESENT OWNER: _____ ADDRESS: _____
- 6. USE: Original: Residence Present: Residence
- 7. ACCESSIBILITY TO PUBLIC: Exterior visible from public road: Yes No
Interior accessible: Explain By appointment only.

DESCRIPTION

- 8. BUILDING MATERIAL: a. clapboard b. stone c. brick d. board and batten
e. cobblestone f. shingles g. stucco other: _____
- 9. STRUCTURAL SYSTEM: a. wood frame with interlocking joints
(if known) b. wood frame with light members
c. masonry load bearing walls
d. metal (explain) _____
e. other _____
- 10. CONDITION: a. excellent b. good c. fair d. deteriorated
- 11. INTEGRITY: a. original site b. moved if so, when? _____
c. list major alterations and dates (if known): New shingles.

Extension at rear.
Addition of third dormer on south side.

12. PHOTO:

13. MAP:

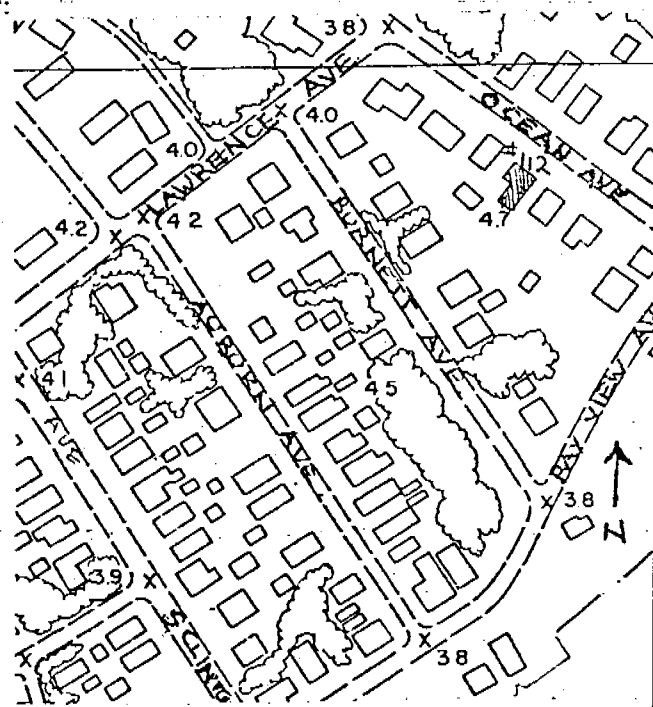

HP-1 Bay Shore Roll #Q5; Neg. #18
East (front) & North Sides.

14. THREATS TO BUILDING: a. none known b. zoning c. roads
d. developers e. deterioration
f. other: _____

15. RELATED OUTBUILDINGS AND PROPERTY:
a. barn b. carriage house c. garage
d. privy e. shed f. greenhouse
g. shop h. gardens
i. landscape features: _____
j. other: _____

16. SURROUNDINGS OF THE BUILDING (check more than one if necessary):
a. open land b. woodland
c. scattered buildings
d. densely built-up e. commercial
f. industrial g. residential
h. other: _____

17. INTERRELATIONSHIP OF BUILDING AND SURROUNDINGS:
(Indicate if building or structure is in an historic district) _____
This house is in a residential area which runs south from Main Street to the Great South Bay. There are numerous houses of architectural significance in the area, ranging from ornate Victorian houses to simple baymen's cottages.

18. OTHER NOTABLE FEATURES OF BUILDING AND SITE (including interior features if known):
This gable roofed house has a variety of original projections. On the front facade there is a two window projection on the first story, and a narrow gabled projection on the second story. On the south side there are dormers which extend down to the second floor level. There is a one bay entrance porch.

SIGNIFICANCE

19. DATE OF INITIAL CONSTRUCTION: 1902

ARCHITECT: unknown

BUILDER: Phillips family

20. HISTORICAL AND ARCHITECTURAL IMPORTANCE:
This house retains much of its original detail. There are exposed rafters at the eaves and at the first floor front projection. The second story has a rectangular twin window on the front facade. There are dentils at the window heads; the cornice is also original. The architrave of the front entrance is simply molded. The two dormers on the south side which are closest to the front facade are original.
The house was built in 1902 by the Phillips family, who then built a similar house next door (110 Ocean Avenue) in 1903.

21. SOURCES: Atlas of the Ocean Shore of Suffolk County, L.I. (Westerly Section). Brooklyn & Manhattan: E. Belcher Hyde, 1915. Volume I. Plate
Interview with Mr. Phillips, resident of 114 Ocean Avenue, Bay Shore, August, 1975. Old postcard of street in Mr. Phillips' possession.
22. THEME: