

BUILDING-STRUCTURE INVENTORY FORM

DIVISION FOR HISTORIC PRESERVATION
NEW YORK STATE PARKS AND RECREATION
ALBANY, NEW YORK (518) 474-0479

| | |
|---------------------|---------------------|
| FOR OFFICE USE ONLY | |
| UNIQUE SITE NO. | <u>10305.000662</u> |
| QUAD | _____ |
| SERIES | _____ |
| NEG. NO. | _____ |

BS 31

YOUR NAME: Town of Islip/SPLIA DATE: January 1990
Town Hall, 655 Main St.
 YOUR ADDRESS: Islip, L.I., N.Y. 11751 TELEPHONE: 516.224.5450
 ORGANIZATION (if any): Dept. of Planning, Housing, and Development

IDENTIFICATION

1. BUILDING NAME(S): 68 Montgomery Avenue - Dawson House
 2. COUNTY: Suffolk TOWN/CITY: Islip VILLAGE: Bay Shore
 3. STREET LOCATION: 68 Montgomery Avenue
 4. OWNERSHIP: a. public b. private
 5. PRESENT OWNER: _____ ADDRESS: _____
 6. USE: Original: residence Present: residence
 7. ACCESSIBILITY TO PUBLIC: Exterior visible from public road: Yes No
 Interior accessible: Explain private residence

DESCRIPTION

8. BUILDING MATERIAL: a. clapboard b. stone c. brick d. board and batten
 e. cobblestone f. shingles g. stucco other: _____
 9. STRUCTURAL SYSTEM: (if known) a. wood frame with interlocking joints
 b. wood frame with light members
 c. masonry load bearing walls
 d. metal (explain) _____
 e. other _____
 10. CONDITION: a. excellent b. good c. fair d. deteriorated
 11. INTEGRITY: a. original site b. moved if so, when? _____
 c. list major alterations and dates (if known): _____

12. PHOTO: Neg. KK III-26, fm. NE

13. MAP: NYS DOT Bay Shore East Quad

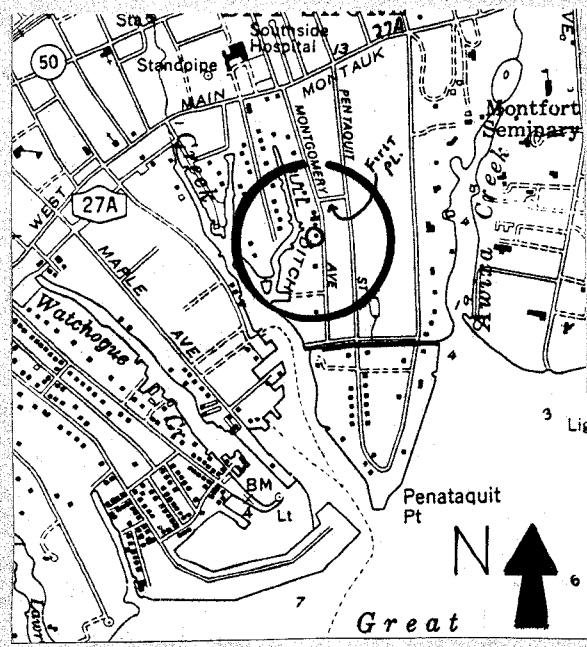

14. THREATS TO BUILDING: a. none known b. zoning c. roads
 d. developers e. deterioration
 f. other: _____
15. RELATED OUTBUILDINGS AND PROPERTY:
 a. barn b. carriage house c. garage
 d. privy e. shed f. greenhouse
 g. shop h. gardens
 i. landscape features: creek directly west
 j. other: picket fence at property line
16. SURROUNDINGS OF THE BUILDING (check more than one if necessary):
 a. open land b. woodland
 c. scattered buildings
 d. densely built-up e. commercial
 f. industrial g. residential
 h. other: Boat yard (BS 30) directly N.

17. INTERRELATIONSHIP OF BUILDING AND SURROUNDINGS: In Awixa Creek Area District
 (Indicate if building or structure is in an historic district)

Refer to continuation sheet (1975 Inventory Form)

18. OTHER NOTABLE FEATURES OF BUILDING AND SITE (including interior features if known):

Refer to continuation sheet (1975 Inventory Form)

SIGNIFICANCE

19. DATE OF INITIAL CONSTRUCTION: Last half of 19th century

ARCHITECT: _____

BUILDER: _____

20. HISTORICAL AND ARCHITECTURAL IMPORTANCE:

This house was Mrs. R. Pinkerton in 1915, and Dawson in 1902. This would have been a normal sized house in the mid-19th century anywhere but here in the mansion area of the South Shore. It undoubtedly was here before the nearby mansions were built. It is a typical house in the local vernacular. It contributes a sense of place to the Awixa Creek Area District.

Refer to continuation sheet. (1975 Inventory Form)

21. SOURCES:
E. Belcher Hyde. Atlas of the Ocean Shore of Suffolk County, L.I. (west-
 erly section), 1915.
Ibid, 1902.

22. THEME:

BUILDING-STRUCTURE INVENTORY FORM

DIVISION FOR HISTORIC PRESERVATION
NEW YORK STATE PARKS AND RECREATION
ALBANY, NEW YORK (518) 474-0479

FOR OFFICE USE ONLY

UNIQUE SITE NO. _____
QUAD _____
SERIES _____
NEG. NO. _____

Supplemen
Landmark
List #T3

YOUR NAME: Town of Islip DATE: September 17, 1975
Town Hall

YOUR ADDRESS: 655 Main Street TELEPHONE: (516) 581-2000

ORGANIZATION (if any): Department of Planning, Housing & Development

IDENTIFICATION

- 1. BUILDING NAME(S): House at #68 South Montgomery Avenue
- 2. COUNTY: Suffolk TOWN/CITY: Islip VILLAGE: Bay Shore
- 3. STREET LOCATION: #68 So. Montgomery Ave. (west side, bet. First Ct. & Montgomery Lane)
- 4. OWNERSHIP: a. public b. private
- 5. PRESENT OWNER: _____ ADDRESS: _____
- 6. USE: Original: Residence Present: Residence
- 7. ACCESSIBILITY TO PUBLIC: Exterior visible from public road: Yes No
Interior accessible: Explain By appointment only

DESCRIPTION

- 8. BUILDING MATERIAL: a. clapboard b. stone c. brick d. board and batten
e. cobblestone f. shingles g. stucco other: _____
- 9. STRUCTURAL SYSTEM: a. wood frame with interlocking joints
(if known) b. wood frame with light members
c. masonry load bearing walls
d. metal (explain) _____
e. other _____
- 10. CONDITION: a. excellent b. good c. fair d. deteriorated
- 11. INTEGRITY: a. original site b. moved if so, when? _____
c. list major alterations and dates (if known): _____

12. PHOTO:



13. MAP:

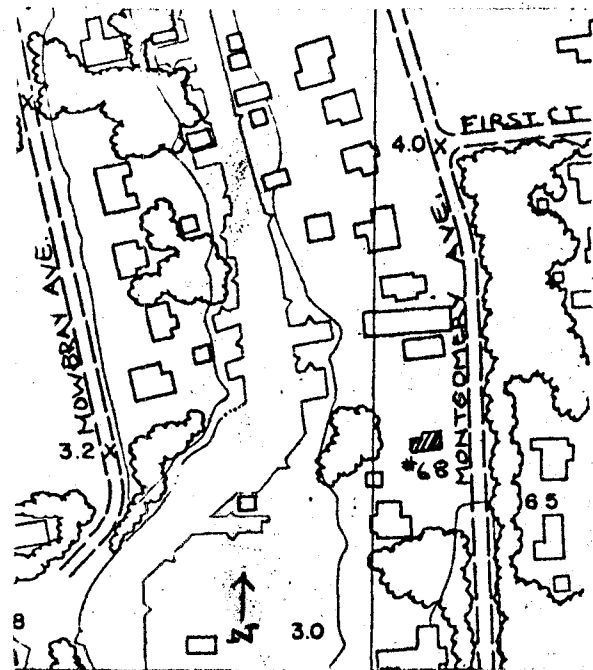

HP-1

Bay Shore Roll #Q6; Neg. #20
Front & North Sides

14. THREATS TO BUILDING: a. none known b. zoning c. roads
 d. developers e. deterioration
 f. other: _____
15. RELATED OUTBUILDINGS AND PROPERTY:
 a. barn b. carriage house c. garage
 d. privy e. shed f. greenhouse
 g. shop h. gardens
 i. landscape features: picket fence
 j. other: _____
16. SURROUNDINGS OF THE BUILDING (check more than one if necessary):
 a. open land b. woodland
 c. scattered buildings
 d. densely built-up e. commercial
 f. industrial g. residential
 h. other: _____

17. INTERRELATIONSHIP OF BUILDING AND SURROUNDINGS:
 (Indicate if building or structure is in an historic district)

This house is in a residential area which runs south from Main Street to the Great South Bay. There are numerous houses of architectural significance in the area, particularly in the Victorian and Shingle styles.

18. OTHER NOTABLE FEATURES OF BUILDING AND SITE (including interior features if known):
 This two and one-half story house is three bays long and has a gable roof. It is two bays wide on the sides. There is a projecting one story wing on the north side. There is a rear wing as well, and a rear porch at the southwest corner.

SIGNIFICANCE

19. DATE OF INITIAL CONSTRUCTION: unknown

ARCHITECT: unknown

BUILDER: unknown

20. HISTORICAL AND ARCHITECTURAL IMPORTANCE:

This is a fine example of a Victorian house. The front porch has turned posts on piers topped with gingerbread, and decorative brackets with terminal drops. The roof overhang on the gable sides also have brackets with terminal drops. Above the front facade's two-over-two windows there are smaller brackets. The first floor front windows extend to floor level. There is a round-headed window in both the north and south gables. The windows are shuttered and have simple architraves. The secondary entrance is a panelled door with round-headed windows in the upper half. The main section has a central chimney.

21. SOURCES:

22. THEME:

Research by the Society for the Preservation of Long Island Antiquities,
 (Judith Saltzman)