

BUILDING-STRUCTURE INVENTORY FORM

DIVISION FOR HISTORIC PRESERVATION
NEW YORK STATE PARKS AND RECREATION
ALBANY, NEW YORK (518) 474-0479

FOR OFFICE USE ONLY
UNIQUE SITE NO. 10305-0118-001
QUAD _____
SERIES _____
NEG. NO. _____

Supplement.
Landmark
List #T3.

YOUR NAME: Town of Islip DATE: September 17, 1975
Town Hall

YOUR ADDRESS: 655 Main Street TELEPHONE: (516) 581-2000

ORGANIZATION (if any): Department of Planning, Housing & Development

IDENTIFICATION

Mrs. R. Pinkerton (?) in 1915

- 1. BUILDING NAME(S): House at #68 South Montgomery Avenue
- 2. COUNTY: Suffolk TOWN/CITY: Islip VILLAGE: Bay Shore
- 3. STREET LOCATION: #68 So. Montgomery Ave. (west side, bet. First Ct. & Montgomery Lane)
- 4. OWNERSHIP: a. public b. private
- 5. PRESENT OWNER: _____ ADDRESS: _____
- 6. USE: Original: Residence Present: Residence
- 7. ACCESSIBILITY TO PUBLIC: Exterior visible from public road: Yes No
Interior accessible: Explain By appointment only

DESCRIPTION

- 8. BUILDING MATERIAL: a. clapboard b. stone c. brick d. board and batten
e. cobblestone f. shingles g. stucco other: _____
- 9. STRUCTURAL SYSTEM: a. wood frame with interlocking joints
(if known) b. wood frame with light members
c. masonry load bearing walls
d. metal (explain) _____
e. other _____
- 10. CONDITION: a. excellent b. good c. fair d. deteriorated
- 11. INTEGRITY: a. original site b. moved if so, when? _____
c. list major alterations and dates (if known): _____

12. PHOTO:

13. MAP:

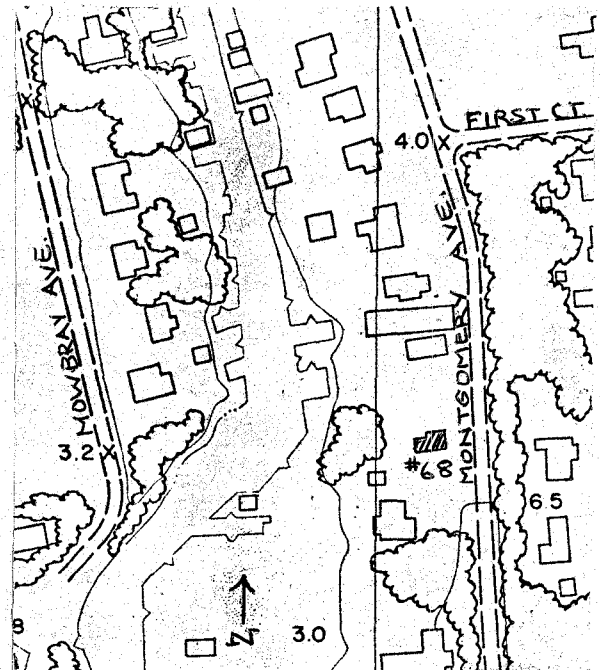

HP-1 Bay Shore Roll #Q6; Neg. #20
Front & North Sides.

14. THREATS TO BUILDING: a. none known b. zoning c. roads
d. developers e. deterioration
f. other: _____

15. RELATED OUTBUILDINGS AND PROPERTY:
a. barn b. carriage house c. garage
d. privy e. shed f. greenhouse
g. shop h. gardens
i. landscape features: picket fence
j. other: _____

16. SURROUNDINGS OF THE BUILDING (check more than one if necessary):
a. open land b. woodland
c. scattered buildings
d. densely built-up e. commercial
f. industrial g. residential
h. other: _____

17. INTERRELATIONSHIP OF BUILDING AND SURROUNDINGS:
(Indicate if building or structure is in an historic district)

This house is in a residential area which runs south from Main Street to the Great South Bay. There are numerous houses of architectural significance in the area, particularly in the Victorian and Shingle styles.

18. OTHER NOTABLE FEATURES OF BUILDING AND SITE (including interior features if known):
This two and one-half story house is three bays long and has a gable roof. It is two bays wide on the sides. There is a projecting one story wing on the north side. There is a rear wing as well, and a rear porch at the southwest corner.

SIGNIFICANCE

19. DATE OF INITIAL CONSTRUCTION: unknown c1880 1868?

ARCHITECT: unknown

BUILDER: unknown

20. HISTORICAL AND ARCHITECTURAL IMPORTANCE:

This is a fine example of a Victorian house. The front porch has turned posts on piers topped with gingerbread, and decorative brackets with terminal drops. The roof overhang on the gable sides also have brackets with terminal drops. Above the front facade's two-over-two windows there are smaller brackets. The first floor front windows extend to floor level. There is a round-headed window in both the north and south gables. The windows are shuttered and have simple architraves. The secondary entrance is a panelled door with round-headed windows in the upper half. The main section has a central chimney.

21. SOURCES: Atlas: E. Belcher Hyde 1915 - Plate 22

22. THEME:

Research by the Society for the Preservation of Long Island Antiquities.
(Judith Saltzman)

T-3

ELBELCHER HYDE ATLAS OF THE
OCEAN SHORE... 1915. PLATE 22



OREGON

PENNAQUITT LAKES

father of Perry Wicks. The land was partly used for farming, but its northern portion from Garfield Street down, was still a source of wood which Selah Wicks shipped to New York. Fourth Avenue originally ran through his farm, becoming a mere cowpath south of Main Street where it led down to pasture for cattle at the waterfront, and to a little dock used by the family. Selah Wicks developed the cowpath into a high-class residential street (Maple Avenue) when Bay Shore became a summer resort.

Clinton Avenue was also a development for summer people, opened by Nathaniel and Hallet Clock of Islip. Richard Montgomery, prominent real estate man and former resident, laid out Montgomery Avenue for the same use.

Early development northward extended on Fifth Avenue, Third Avenue, and to some degree on Brook Street, as well as Fourth Avenue. In North Bay Shore near Garfield Street, Eliphalet Snedecor had several dozen cottages which were rented to colored (Indian or Negro) families. The tenants paid rent each day, on a sort of installment plan.

Third Avenue property near Main Street belonged to "Aunt Tisch Green", an Indian woman who sold her land on the west side to Seth Clock. South Park Avenue was a cranberry marsh, later filled in by Treadwell O. Smith.

About 1870 a large tract was surveyed for development of First and Second Avenues. By 1882 many houses had been erected. In its early days this property belonged to

BUILDING-STRUCTURE INVENTORY FORM

DIVISION FOR HISTORIC PRESERVATION
NEW YORK STATE PARKS AND RECREATION
ALBANY, NEW YORK (518) 474-0479

FOR OFFICE USE ONLY	
UNIQUE SITE NO.	<u>10365-000/18</u>
QUAD	_____
SERIES	_____
NEG. NO.	_____

YOUR NAME: Mrs. Robert A. Prescott DATE: 3/28/84

YOUR ADDRESS: 68 So. Montgomery Ave. TELEPHONE: (516) 665-4465

ORGANIZATION (if any): _____

IDENTIFICATION

- 1. BUILDING NAME(S): Pinkerton Detective Agency Estate - Caretaker's Home
- 2. COUNTY: Suffolk TOWN/CITY: Bayshore VILLAGE: Islip Township
- 3. STREET LOCATION: 68 South Montgomery Avenue, Bayshore
- 4. OWNERSHIP: a. public b. private
- 5. PRESENT OWNER: Same as Above ADDRESS: Same as Above
- 6. USE: Original: Pinkerton Agency Caretaker's Home Present: PRIVATE dwelling
- 7. ACCESSIBILITY TO PUBLIC: Exterior visible from public road, Yes No
Interior accessible: Explain by Appointment Only.

DESCRIPTION

- 8. BUILDING MATERIAL: a. clapboard b. stone c. brick d. board and batten
e. cobblestone f. shingles g. stucco other: _____
- 9. STRUCTURAL SYSTEM: (if known) a. wood frame with interlocking joints
b. wood frame with light members
c. masonry load bearing walls
d. metal (explain) _____
e. other _____
- 10. CONDITION: a. excellent b. good c. fair d. deteriorated
- 11. INTEGRITY: a. original site b. moved if so, when? _____
c. list major alterations and dates (if known): _____

12. PHOTO: taken winter of 1982.

13. MAP: See following pages.

