

BUILDING-STRUCTURE INVENTORY FORM

DIVISION FOR HISTORIC PRESERVATION
 NEW YORK STATE PARKS AND RECREATION
 ALBANY, NEW YORK (518) 474-0479

FOR OFFICE USE ONLY
 UNIQUE SITE NO. 103-05-0031-001
 QUAD _____
 SERIES _____
 NEG. NO. _____

Quad IV
 No. 25

YOUR NAME: Town of Islip DATE: August 27, 1975

Town Hall
 YOUR ADDRESS: 655 Main Street TELEPHONE: (516) 581-2000

ORGANIZATION (if any): Department of Planning, Housing & Development

IDENTIFICATION

1. BUILDING NAME(S): Formerly Mrs. E.C. Hungerford House in 1915.
2. COUNTY: Suffolk TOWN/CITY: Islip VILLAGE: Bay Shore
3. STREET LOCATION: Maple Ave; east side; south of Gibson St. Gibson & Maple (etc.)
4. OWNERSHIP: a. public b. private
5. PRESENT OWNER: _____ ADDRESS: _____
6. USE: Original: Residence Present: Part of Mayfair Rest Home
7. ACCESSIBILITY TO PUBLIC: Exterior visible from public road: Yes No
 Interior accessible: Explain By appointment only.

DESCRIPTION

8. BUILDING MATERIAL: a. clapboard b. stone c. brick d. board and batten
 e. cobblestone f. shingles g. stucco other: _____
9. STRUCTURAL SYSTEM: (if known) a. wood frame with interlocking joints
 b. wood frame with light members
 c. masonry load bearing walls
 d. metal (explain) _____
 e. other _____
10. CONDITION: a. excellent b. good c. fair d. deteriorated
11. INTEGRITY: a. original site b. moved if so, when? _____
 c. list major alterations and dates (if known): _____

12. PHOTO:

13. MAP:

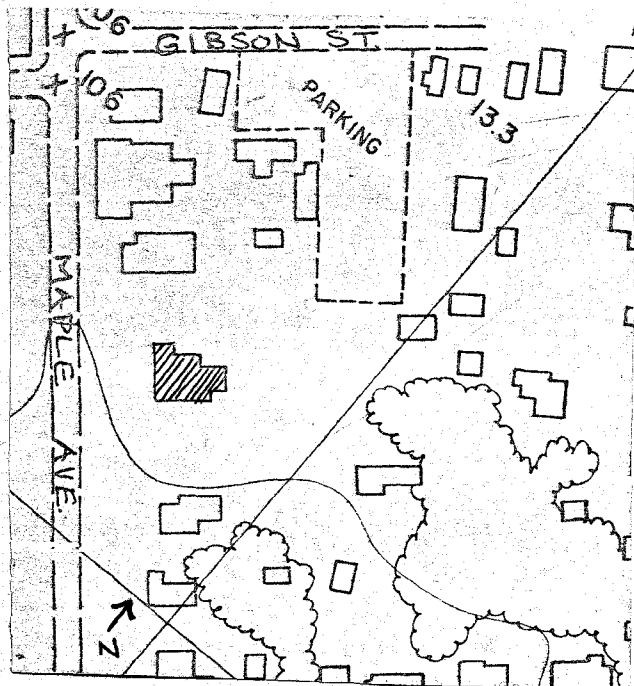

HP-1 Bay Shore Roll #Q5; Neg.#9
 Front (west) facade.

14. THREATS TO BUILDING: a. none known b. zoning c. roads
 d. developers e. deterioration
 f. other: _____
15. RELATED OUTBUILDINGS AND PROPERTY:
 a. barn b. carriage house c. garage
 d. privy e. shed f. greenhouse
 g. shop h. gardens
 i. landscape features: _____
 j. other: _____
16. SURROUNDINGS OF THE BUILDING (check more than one if necessary):
 a. open land b. woodland
 c. scattered buildings
 d. densely built-up e. commercial
 f. industrial g. residential
 h. other: _____

17. INTERRELATIONSHIP OF BUILDING AND SURROUNDINGS:

(Indicate if building or structure is in an historic district)

This house is in a residential area which runs south from Main Street to the Great South Bay. There are numerous houses of architectural significance in the area, particularly from the Victorian Era, in the Italianate and Queen Anne styles. This house is one of several run by the Mayfair Rest Home.

18. OTHER NOTABLE FEATURES OF BUILDING AND SITE (including interior features if known):

This two and one-half story house has a front clipped gable with a vergeboard with circular perforations and brackets. The side gables have vergeboards as well. The porch extends along the front and around the sides; it has square posts with rounded brackets, and exposed rafter ends. The balustrade is geometrical. There is a gable with vergeboard on the north side of the porch.

SIGNIFICANCE

19. DATE OF INITIAL CONSTRUCTION: unknown

ARCHITECT: unknown

BUILDER: unknown

20. HISTORICAL AND ARCHITECTURAL IMPORTANCE:

This Queen Anne style house retains much of its original detail, i.e., vergeboards, brackets, and porch. Above the porch, at the center bay, there is a balcony with a sweeping roof and geometrical balustrade. The second story also has projections to the sides - a polygonal bay on the south side, and a square bay on the north. The windows are rectangular, with twin windows on either side of the second story balcony. The front door is double leafed and panelled. There are two symmetrically placed corbelled chimneys; the foundation is brick.

The house belonged to the Hungerfords of the Hungerford Copper Company.

21. SOURCES:

Atlas of the Ocean Shore of Suffolk County, L.I. (Westerly Section).
 Brooklyn & Manhattan: E. Belcher Hyde, 1915. Volume I. Plate 21.

22. THEME:

Research by the Society for the Preservation of Long Island Antiquities.
 (Judith Saltzman)