

BUILDING-STRUCTURE INVENTORY FORM

DIVISION FOR HISTORIC PRESERVATION
NEW YORK STATE PARKS AND RECREATION
ALBANY, NEW YORK (518) 474-0479

FOR OFFICE USE ONLY	
UNIQUE SITE NO.	<u>103-05-0108</u> - 001
QUAD	_____
SERIES	_____
NEG. NO.	_____

Quad IV Ext
No. 3

YOUR NAME: Town of Islip DATE: September 11, 1975
Town Hall

YOUR ADDRESS: 655 Main Street TELEPHONE: (516) 581-2000

ORGANIZATION (if any): Department of Planning, Housing & Development

IDENTIFICATION

- 1. BUILDING NAME(S): House at #59 Maple Avenue
- 2. COUNTY: Suffolk TOWN/CITY: Islip VILLAGE: Bay Shore
- 3. STREET LOCATION: #59 Maple Ave. (East side, south of Maple Court)
- 4. OWNERSHIP: a. public b. private
- 5. PRESENT OWNER: _____ ADDRESS: _____
- 6. USE: Original: Residence Present: Residence
- 7. ACCESSIBILITY TO PUBLIC: Exterior visible from public road: Yes No
Interior accessible: Explain By appointment only

DESCRIPTION

- 8. BUILDING MATERIAL: a. clapboard b. stone c. brick d. board and batten
e. cobblestone f. shingles g. stucco other: _____
- 9. STRUCTURAL SYSTEM: (if known) a. wood frame with interlocking joints
b. wood frame with light members
c. masonry load bearing walls
d. metal (explain) _____
e. other _____
- 10. CONDITION: a. excellent b. good c. fair d. deteriorated
- 11. INTEGRITY: a. original site b. moved if so, when? _____
c. list major alterations and dates (if known): _____

Probably windows enclosing end of porch are not original.

12. PHOTO:

13. MAP:

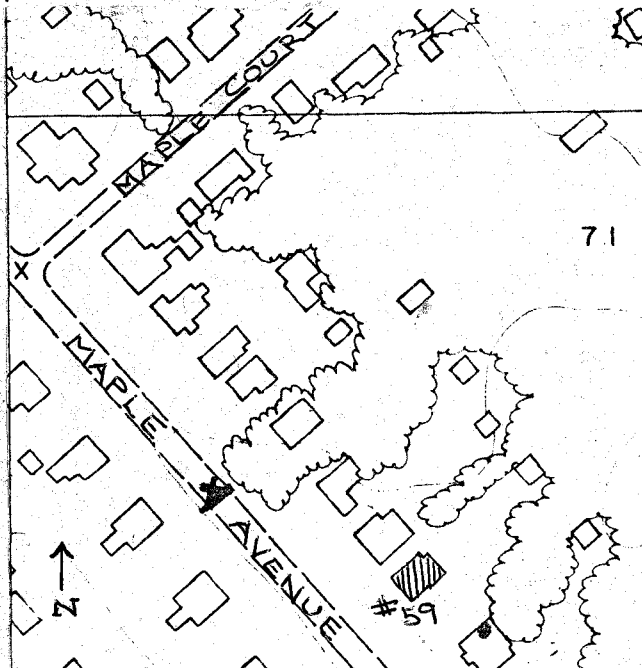

Bay Shore Roll #Q6; Neg. #8
HP-1 Front & South sides

14. THREATS TO BUILDING: a. none known b. zoning c. roads
d. developers e. deterioration
f. other: _____

15. RELATED OUTBUILDINGS AND PROPERTY:
a. barn b. carriage house c. garage
d. privy e. shed f. greenhouse
g. shop h. gardens
i. landscape features: _____
j. other: _____

16. SURROUNDINGS OF THE BUILDING (check more than one if necessary):
a. open land b. woodland
c. scattered buildings
d. densely built-up e. commercial
f. industrial g. residential
h. other: _____

17. INTERRELATIONSHIP OF BUILDING AND SURROUNDINGS:

(Indicate if building or structure is in an historic district)

This shingled house is in a residential area which runs south from Main Street to the Great South Bay. There are numerous houses of architectural significance in the area, ranging from Victorian to Shingle to Spanish Style.

18. OTHER NOTABLE FEATURES OF BUILDING AND SITE (including interior features if known):

The house retains its original windows. There are two twelve-over-one windows at the south end of the front facade. The front gable has a nine-over-one window flanked by six lights on each side (two wide, three long). The north side has a round headed window with an ornamental design, and shingles outlining the circular head.

SIGNIFICANCE

19. DATE OF INITIAL CONSTRUCTION: unknown

ARCHITECT: unknown

BUILDER: unknown

20. HISTORICAL AND ARCHITECTURAL IMPORTANCE:

This house has an unusual combination of gable and gambrel roof types, with a return on the gable side. The roof line is repeated on the large front dormer. There is a wide overhang. The front porch has classical columns and a simple balustrade. There are several types of original windows, the predominant type being rectangular with simple architraves. (the multi-paned types and round-headed window are described above) On the south side below the cornice there is a second story bay window. The front facade has a shed roof dormer.

This may have been the E.R. Udall House in 1915.

21. SOURCES:

Atlas of the Ocean Shore of Suffolk County, L.I. (Westerly Section).
Brooklyn & Manhattan: E. Belcher Hyde, 1915. Volume I. Plate 21.
See OLD POSTAL CARD

22. THEME:

Research by the Society for the Preservation of Long Island Antiquities.
(Judith Saltzman)



OLD POSTAL CARD - LOOKING NORTH

59 MAPLE AVENUE AT RIGHT