

BUILDING-STRUCTURE INVENTORY FORM

DIVISION FOR HISTORIC PRESERVATION
 NEW YORK STATE PARKS AND RECREATION
 ALBANY, NEW YORK (518) 474-0479

FOR OFFICE USE ONLY
 UNIQUE SITE NO. 103-05-0070
 QUAD _____
 SERIES _____
 NEG. NO. _____

III-7
001

YOUR NAME: Town of Islip DATE: August 7, 1975
Town Hall
 YOUR ADDRESS: 655 Main Street TELEPHONE: (516) 581-2000
 ORGANIZATION (if any): Department of Planning, Housing, & Development

IDENTIFICATION

1. BUILDING NAME(S): O. Brewster House in 1915
 2. COUNTY: Suffolk TOWN/CITY: Islip VILLAGE: Bay Shore
 3. STREET LOCATION: 32 Maple Ave. (west side, bet. Gibson St. & Maple Ct.)
 4. OWNERSHIP: a. public b. private
 5. PRESENT OWNER: _____ ADDRESS: _____
 6. USE: Original: Residence Present: Residence
 7. ACCESSIBILITY TO PUBLIC: Exterior visible from public road: Yes No
 Interior accessible: Explain By appointment only

DESCRIPTION

8. BUILDING MATERIAL: a. clapboard b. stone c. brick d. board and batten
 e. cobblestone f. shingles g. stucco other: _____
 9. STRUCTURAL SYSTEM: a. wood frame with interlocking joints
 (if known) b. wood frame with light members
 c. masonry load bearing walls
 d. metal (explain) _____
 e. other _____
 10. CONDITION: a. excellent b. good c. fair d. deteriorated
 11. INTEGRITY: a. original site b. moved if so, when? _____
 c. list major alterations and dates (if known): _____

New shingles.

12. PHOTO:



13. MAP:

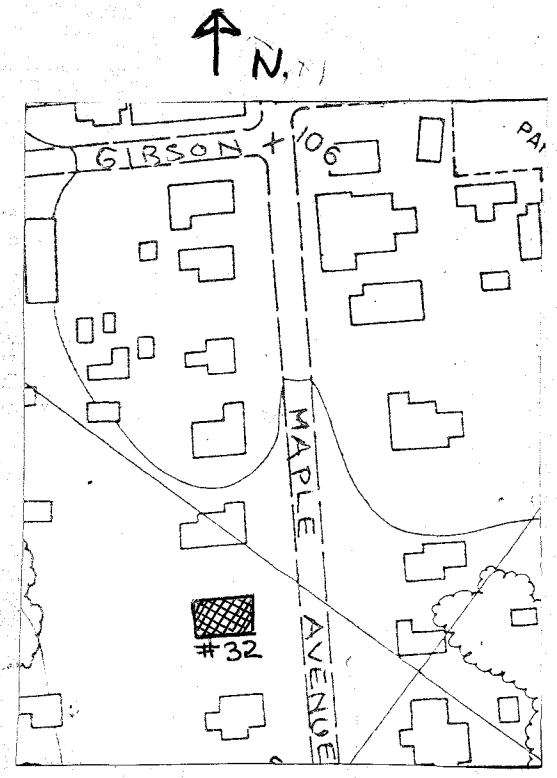

14. THREATS TO BUILDING: a. none known b. zoning c. roads
d. developers e. deterioration
f. other: _____

15. RELATED OUTBUILDINGS AND PROPERTY:
a. barn b. carriage house c. garage
d. privy e. shed f. greenhouse
g. shop h. gardens
i. landscape features: _____
j. other: _____

16. SURROUNDINGS OF THE BUILDING (check more than one if necessary):
a. open land b. woodland
c. scattered buildings
d. densely built-up e. commercial
f. industrial g. residential
h. other: _____

17. INTERRELATIONSHIP OF BUILDING AND SURROUNDINGS:
(Indicate if building or structure is in an historic district)

This house is in a residential area between Main Street and the Great South Bay. There are many houses of architectural significance here, primarily from the Victorian Era, and generally in the Queen Anne or Italianate styles.

18. OTHER NOTABLE FEATURES OF BUILDING AND SITE (including interior features if known):

This Queen Anne house has a typical polygonal tower capped with a pointed roof. There are eight over eight windows in the upper story of the tower. The porch extends along the front and side of the house and has posts with simple arches. There is a porte-cochere as well. The main gable has a Palladian window.

SIGNIFICANCE

19. DATE OF INITIAL CONSTRUCTION: unknown

ARCHITECT: unknown

BUILDER: unknown

20. HISTORICAL AND ARCHITECTURAL IMPORTANCE:

This house with its polygonal tower, extensive porch, and projections is a good example of the Queen Anne style. There is leaded glass in the front door and its flanking windows. On the north side, there is a projecting bay with a flat roof and cornice. The foundation is brick, as is the corbelled chimney.

The windows are original (two over two windows on the first and second floors) and have a simple molded trim. The porch entrance is pedimented; the portion of the second floor above it is slightly recessed.

21. SOURCES:

Atlas of the Ocean Shore of Suffolk County, L.I. (Westerly Section). Volume I. Amityville to Eastport Inclusive. Brooklyn & Manhattan: E. Belcher Hyde, 1915.

22. THEME:

J.S.