

BUILDING-STRUCTURE INVENTORY FORM

DIVISION FOR HISTORIC PRESERVATION
NEW YORK STATE PARKS AND RECREATION
ALBANY, NEW YORK (518) 474-0479

FOR OFFICE USE ONLY
UNIQUE SITE NO. 103-05-0068
QUAD _____
SERIES _____
NEG. NO. _____

III-6
001

YOUR NAME: Town of Islip DATE: August 7, 1975
Town Hall
YOUR ADDRESS: 655 Main Street TELEPHONE: (516) 581-2000
ORGANIZATION (if any): Department of Planning, Housing & Development

IDENTIFICATION

- 1. BUILDING NAME(S): Mrs. E. Wicks House in 1915
- 2. COUNTY: Suffolk TOWN/CITY: Islip VILLAGE: Bay Shore
- 3. STREET LOCATION: 26 Maple Ave. (west side, bet. Gibson St. & Maple Ct.)
- 4. OWNERSHIP: a. public b. private
- 5. PRESENT OWNER: _____ ADDRESS: _____
- 6. USE: Original: Residence Present: Residence
- 7. ACCESSIBILITY TO PUBLIC: Exterior visible from public road: Yes No
Interior accessible: Explain By appointment only

DESCRIPTION

- 8. BUILDING MATERIAL: a. clapboard b. stone c. brick d. board and batten
e. cobblestone f. shingles g. stucco other: _____
- 9. STRUCTURAL SYSTEM: a. wood frame with interlocking joints
(if known) b. wood frame with light members
c. masonry load bearing walls
d. metal (explain) _____
e. other _____
- 10. CONDITION: a. excellent b. good c. fair d. deteriorated
- 11. INTEGRITY: a. original site b. moved if so, when? _____
c. list major alterations and dates (if known): _____

12. PHOTO:



13. MAP:

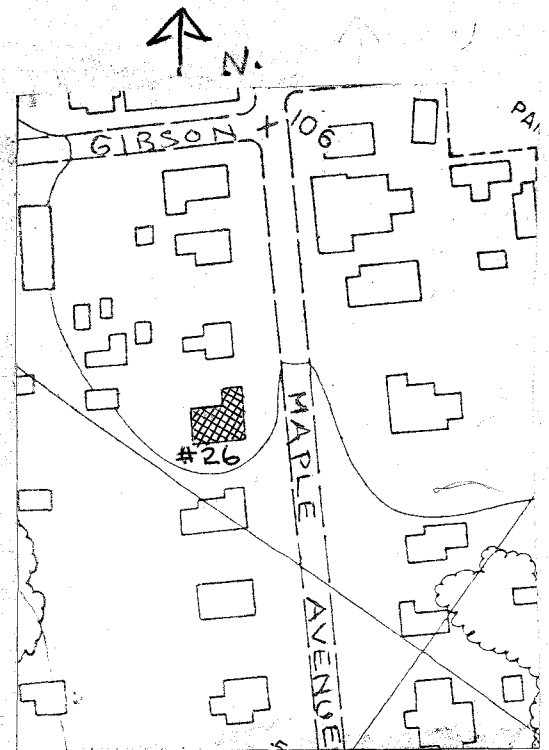

14. THREATS TO BUILDING: a. none known b. zoning c. roads
 d. developers e. deterioration
 f. other: _____
15. RELATED OUTBUILDINGS AND PROPERTY:
 a. barn b. carriage house c. garage
 d. privy e. shed f. greenhouse
 g. shop h. gardens
 i. landscape features: _____
 j. other: _____
16. SURROUNDINGS OF THE BUILDING (check more than one if necessary):
 a. open land b. woodland
 c. scattered buildings
 d. densely built-up e. commercial
 f. industrial g. residential
 h. other: _____

17. INTERRELATIONSHIP OF BUILDING AND SURROUNDINGS:

(Indicate if building or structure is in an historic district)

The house is in a residential area between Main Street and the Great South Bay. There are many houses of architectural significance here, primarily from the Victorian Era, and generally in the Queen Anne or Italianate styles.

18. OTHER NOTABLE FEATURES OF BUILDING AND SITE (including interior features if known):

This Victorian house has its original windows, vergeboard, pointed shingles and stickwork in the gable. There are decorative brackets at the gable projection, as well as decorative extended rafters. The porch has its original turned posts and balustrade. There is a porte-cochere with turned posts on a brick pier.

SIGNIFICANCE

19. DATE OF INITIAL CONSTRUCTION: unknown

ARCHITECT: unknown

BUILDER: unknown

20. HISTORICAL AND ARCHITECTURAL IMPORTANCE:

This Victorian house retains much of its original detail, i.e., windows, elaborate vergeboard, pointed shingles, stickwork, and turned posts. The projecting gable with its decorative brackets, as well as the porch and porte-cochere with their turned posts, make this a fine example of the historical houses common to this area.

two corbelled chimneys. The mixture of surface materials - clapboard and pointed shingle - is also typical of the period. The original two over two windows have a simple molded trim.

21. SOURCES:

Atlas of the Ocean Shore of Suffolk County, L.I. (Westerly Section). Volume I. Amityville to Eastport Inclusive. Brooklyn & Manhattan: E. Belcher Hyde, 1915.

22. THEME:

Research by the Society for the Preservation of Long Island Antiquities.