

BUILDING-STRUCTURE INVENTORY FORM

DIVISION FOR HISTORIC PRESERVATION
NEW YORK STATE PARKS AND RECREATION
ALBANY, NEW YORK (518) 474-0479

FOR OFFICE USE ONLY	
UNIQUE SITE NO. <u>103-05-0054</u>	- 001
QUAD _____	
SERIES _____	
NEG. NO. _____	

Quad IV
NO.7

YOUR NAME: Town of Islip DATE: August 15, 1975

YOUR ADDRESS: Town Hall
655 Main Street TELEPHONE: (516) 581-2000

ORGANIZATION (if any): Department of Planning, Housing & Development

IDENTIFICATION

- BUILDING NAME(S): (Mars Stores)
- COUNTY: Suffolk TOWN/CITY: Islip VILLAGE: Bay Shore
- STREET LOCATION: #110 E. Main St. (south side, bet. Shore & Homan Aves.)
- OWNERSHIP: a. public b. private
- PRESENT OWNER: _____ ADDRESS: _____
- USE: Original: _____ Present: Store
- ACCESSIBILITY TO PUBLIC: Exterior visible from public road: Yes No
Interior accessible: Explain By appointment.

DESCRIPTION

- BUILDING MATERIAL: a. clapboard b. stone c. brick d. board and batten
e. cobblestone f. shingles g. stucco other: _____
- STRUCTURAL SYSTEM: a. wood frame with interlocking joints
(if known) b. wood frame with light members
c. masonry load bearing walls
d. metal (explain) _____
e. other _____
- CONDITION: a. excellent b. good c. fair d. deteriorated
- INTEGRITY: a. original site b. moved if so, when? _____
c. list major alterations and dates (if known): _____

First floor remodelled.
Stuccoed

12. PHOTO:

13. MAP:

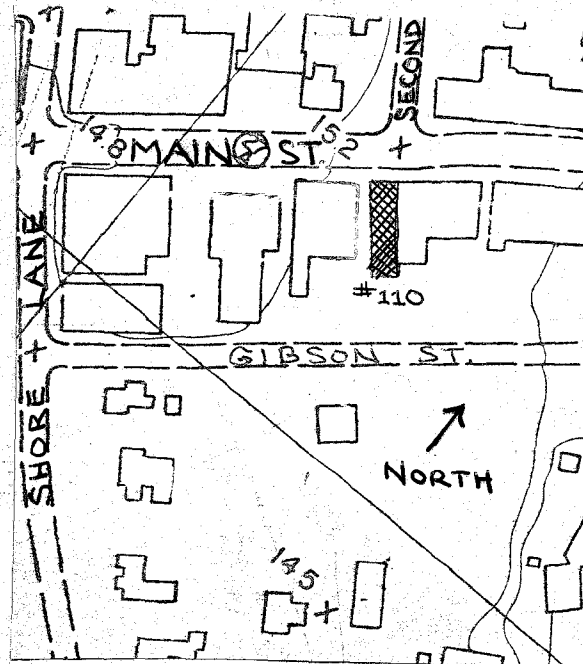

Bay Shore Roll #Q4; Neg.#12
HP-1 Front (north) facade.

14. THREATS TO BUILDING: a. none known b. zoning c. roads
 d. developers e. deterioration
 f. other: _____
15. RELATED OUTBUILDINGS AND PROPERTY:
 a. barn b. carriage house c. garage
 d. privy e. shed f. greenhouse
 g. shop h. gardens
 i. landscape features: _____
 j. other: _____
16. SURROUNDINGS OF THE BUILDING (check more than one if necessary):
 a. open land b. woodland
 c. scattered buildings
 d. densely built-up e. commercial
 f. industrial g. residential
 h. other: _____

17. INTERRELATIONSHIP OF BUILDING AND SURROUNDINGS:
 (Indicate if building or structure is in an historic district)

The building is on the main commercial street. There are other structures of architectural significance near-by, though from varying periods and in varying styles. Many of them have undergone extensive remodelling.

18. OTHER NOTABLE FEATURES OF BUILDING AND SITE (including interior features if known):

This two story building is three bays wide and has a gable roof. The gables are on the side of the building, and the eaves expose extended rafter ends. The second floor windows have simply molded architraves.

SIGNIFICANCE

19. DATE OF INITIAL CONSTRUCTION: circa 1910 mabe earlier

ARCHITECT: unknown

BUILDER: unknown

20. HISTORICAL AND ARCHITECTURAL IMPORTANCE:

Despite alterations, this building retains some elements of an early twentieth century wood frame structure. It is one of the few gable roofed buildings with exposed rafter ends on Main Street.

The site was part of J. Robbins property in 1915

See 1906 photograph from Cambérwell Collection.

21. SOURCES:

Atlas of the Ocean Shore of Suffolk County, L.I. (Westerly Section). Volume I. Amityville to Eastport Inclusive. Brooklyn & Manhattan: E. Belcher Hyde, 1915. Plate 21.

22. THEME:

Research by the Society for the Preservation of Long Island Antiquities.
 (Judith Saltzman)

1/28/73

LONG ISLAND PRESS, SUNDA

Long Island then ... and now

1906



From the Camberwell Collection of Raymond R. Chambers

Looking east from Shore Lane

Leisurely pace is gone from Bay Shore's Main St.

It's business as usual along Bay Shore's Main Street today, just as it was in 1906 when the above picture was taken. But what a vast difference in the two scenes!

The leisurely pace of horse and wagon, of bicycles and those early hand-cranked cars, has

a while silent film stars like Marie Dressler, Norma Talmadge, Anita Stewart and Fatty Arbuckle rubbed shoulders with the baymen and farmers who made up the bulk of the year-round population.

Delving back through the mists of history, we find that Bay Shore got its name about the middle

1/28/73

LONG ISLAND PRESS, SUNDA

Long Island then...and now

1966



From the Camberwell Collection of Raymond R. Chambers



1
2
3
4
5
6
7
8
9
10