

**BUILDING-STRUCTURE INVENTORY FORM**

DIVISION FOR HISTORIC PRESERVATION  
NEW YORK STATE PARKS AND RECREATION  
ALBANY, NEW YORK (518) 474-0479

FOR OFFICE USE ONLY	
UNIQUE SITE NO.	<u>103-05-0052</u>
QUAD	_____
SERIES	_____
NEG. NO.	_____

DOJ  
Quad IV  
No. 5

YOUR NAME: Town of Islip DATE: August 15, 1975  
Town Hall  
 YOUR ADDRESS: 655 Main Street TELEPHONE: (516) 581-2000  
 ORGANIZATION (if any): Department of Planning, Housing & Development

**IDENTIFICATION**

1. BUILDING NAME(S): Courthouse Building  
 2. COUNTY: Suffolk TOWN/CITY: Islip VILLAGE: Bay Shore  
 3. STREET LOCATION: 66-92 Main St. ~~here, #86, #88, #92 Main~~  
 4. OWNERSHIP: a. public  b. private   
 5. PRESENT OWNER: \_\_\_\_\_ ADDRESS: \_\_\_\_\_  
 6. USE: Original: Courthouse & Offices Present: Stores & Offices  
 7. ACCESSIBILITY TO PUBLIC: Exterior visible from public road: Yes  No   
 Interior accessible: Explain During business hours.

**DESCRIPTION**

8. BUILDING MATERIAL: a. clapboard  b. stone  c. brick  d. board and batten   
 e. cobblestone  f. shingles  g. stucco  other: \_\_\_\_\_  
 9. STRUCTURAL SYSTEM: a. wood frame with interlocking joints   
 (if known) b. wood frame with light members   
 c. masonry load bearing walls   
 d. metal (explain) \_\_\_\_\_  
 e. other \_\_\_\_\_  
 10. CONDITION: a. excellent  b. good  c. fair  d. deteriorated   
 11. INTEGRITY: a. original site  b. moved  if so, when? \_\_\_\_\_  
 c. list major alterations and dates (if known): \_\_\_\_\_

Remodelling on first floor for store fronts;

12. PHOTO:



13. MAP:

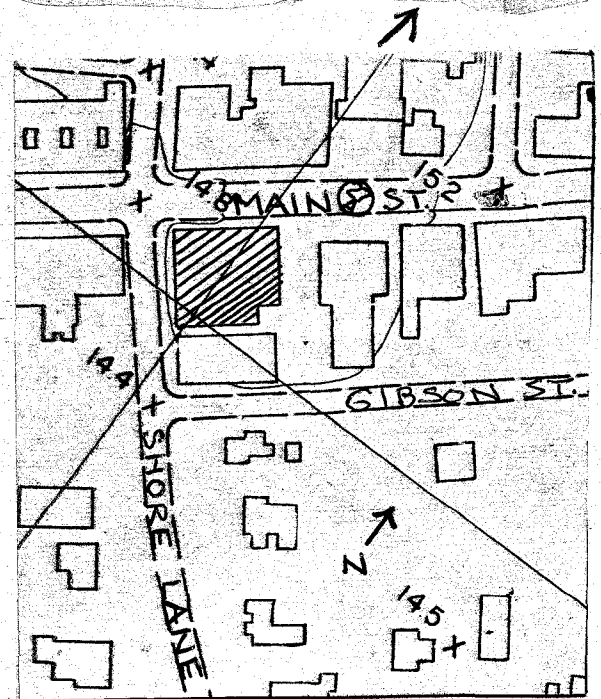

HP-1 Bay Shore Roll #Q4; Neg. #10  
North & West sides.

14. THREATS TO BUILDING: a. none known  b. zoning  c. roads   
d. developers  e. deterioration   
f. other: \_\_\_\_\_
15. RELATED OUTBUILDINGS AND PROPERTY:  
a. barn  b. carriage house  c. garage   
d. privy  e. shed  f. greenhouse   
g. shop  h. gardens   
i. landscape features: \_\_\_\_\_  
j. other: \_\_\_\_\_
16. SURROUNDINGS OF THE BUILDING (check more than one if necessary):  
a. open land  b. woodland   
c. scattered buildings   
d. densely built-up  e. commercial   
f. industrial  g. residential   
h. other: \_\_\_\_\_

17. INTERRELATIONSHIP OF BUILDING AND SURROUNDINGS:

(Indicate if building or structure is in an historic district)

The building is on the main commercial street. There are other structures of architectural significance near-by, though from varying periods and in varying styles. Many of them have undergone extensive remodelling.

18. OTHER NOTABLE FEATURES OF BUILDING AND SITE (including interior features if known):

This two story yellow brick building has white tile molded cornices and ornament. The west facade has a large round arched doorway with brick radiating voussoirs and a white tile keystone. The brick parapet has openings with decorative railings.

The eastern third of the building is three stories, with similar detailing.

SIGNIFICANCE

19. DATE OF INITIAL CONSTRUCTION: unknown exact date; circa 1915 -1920

ARCHITECT: unknown

BUILDER: unknown

20. HISTORICAL AND ARCHITECTURAL IMPORTANCE:

This yellow brick building is two stories at its western two-thirds and three stories at the eastern one-third. The white tile cornice and ornament give textural and color contrast. There are diamond-shaped white tiles with a foliated pattern surrounded by angled bricks between floor levels. The windows, both double and single, are rectangular with brick radiating voussoirs and white tile keystones, and raised brick labels above.

The three story eastern section of the building was used as a courthouse.

21. SOURCES:

Interview with Jerome Gleason, Penataquit Press, Bay Shore, New York. August, 1975. Gleason photo.

22. THEME:

Research by the Society for the Preservation of Long Island Antiquities. (Judith Saltzman)