

**BUILDING-STRUCTURE INVENTORY FORM**

DIVISION FOR HISTORIC PRESERVATION  
NEW YORK STATE PARKS AND RECREATION  
ALBANY, NEW YORK (518) 474-0479

FOR OFFICE USE ONLY

UNIQUE SITE NO 10305.000679

QUAD \_\_\_\_\_

SERIES \_\_\_\_\_

NEG. NO. \_\_\_\_\_

BS 47

YOUR NAME: Town of Islip/SPLIA DATE: January 1990

Town Hall, 655 Main St.

YOUR ADDRESS: Islip, L.I., N.Y. 11751 TELEPHONE: 516.224.5450

ORGANIZATION (if any): Dept. of Planning, Housing, and Development

\*\*\*\*\*  
**IDENTIFICATION**

- 1. BUILDING NAME(S): St. Luke's Lutheran Church
- 2. COUNTY: Suffolk TOWN/CITY: Islip VILLAGE: Bay Shore
- 3. STREET LOCATION: Lawrance Lane, SE corner Montauk Highway, 0 Co'Nee
- 4. OWNERSHIP: a. public  b. private
- 5. PRESENT OWNER: \_\_\_\_\_ ADDRESS: \_\_\_\_\_
- 6. USE: Original: church Present: church
- 7. ACCESSIBILITY TO PUBLIC: Exterior visible from public road: Yes  No   
Interior accessible: Explain by appointment

**DESCRIPTION**

- 8. BUILDING MATERIAL: a. clapboard  b. stone  c. brick  d. board and batten   
e. cobblestone  f. shingles  g. stucco  other: \_\_\_\_\_
- 9. STRUCTURAL SYSTEM: (if known) a. wood frame with interlocking joints   
b. wood frame with light members   
c. masonry load bearing walls   
d. metal (explain) \_\_\_\_\_  
e. other \_\_\_\_\_
- 10. CONDITION: a. excellent  b. good  c. fair  d. deteriorated
- 11. INTEGRITY: a. original site  b. moved  if so, when? \_\_\_\_\_  
c. list major alterations and dates (if known): \_\_\_\_\_

12. PHOTO: Neg. KK V-9, fm. NW

13. MAP: NYS DOT Bay Shore East & West Quads

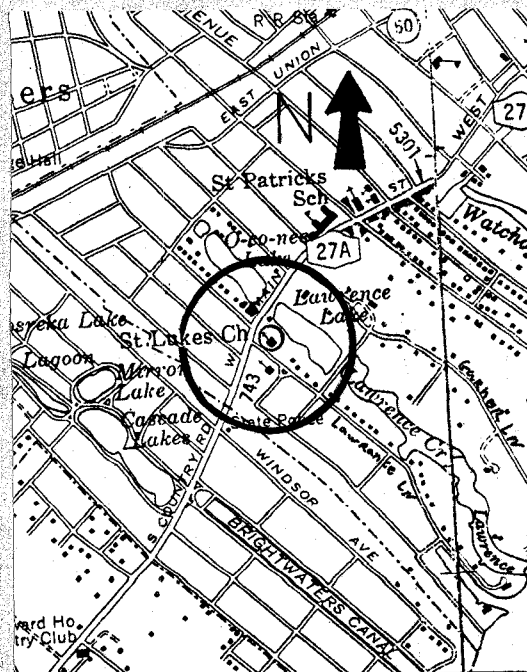

14. THREATS TO BUILDING: a. none known  b. zoning  c. roads   
 d. developers  e. deterioration   
 f. other: \_\_\_\_\_
15. RELATED OUTBUILDINGS AND PROPERTY:  
 a. barn  b. carriage house  c. garage   
 d. privy  e. shed  f. greenhouse   
 g. shop  h. gardens   
 i. landscape features: Lawrance Lake directly east  
 j. other: \_\_\_\_\_
16. SURROUNDINGS OF THE BUILDING (check more than one if necessary):  
 a. open land  b. woodland   
 c. scattered buildings   
 d. densely built-up  e. commercial   
 f. industrial  g. residential   
 h. other: separate church directly west

17. INTERRELATIONSHIP OF BUILDING AND SURROUNDINGS: In O Co'Nee District  
 (Indicate if building or structure is in an historic district)  
 St. Luke's Lutheran Church is located at the northern end of the Lawrance Lane entrance to the private residential community of the O Co'Nee Association south of the Montauk Highway. The church is surrounded towards the south by O Co'Nee Association residences built predominantly during the 1920's.

18. OTHER NOTABLE FEATURES OF BUILDING AND SITE (including interior features if known):  
 St. Luke's Lutheran Church is a 2½ story, stucco and fieldstone building with a wide, crenellated parapet roof between two projecting, gable roof wings flanked by crenellated parapet roof extensions. Tall window groupings separated by panelled spandrels mark the facades, many containing molded masonry hoods. Pointed-arch entrance doors set in fieldstone SIGNIFICANCE feature characteristic Medieval style hardware.

19. DATE OF INITIAL CONSTRUCTION: 1929

ARCHITECT: \_\_\_\_\_

BUILDER: \_\_\_\_\_

20. HISTORICAL AND ARCHITECTURAL IMPORTANCE:

While not exactly part of the O Co'Nee development, this structure is built on F.C. Lawrance land and is indicated on the 1986 map. This handsome building is a contributing component of the O Co'Nee District.

21. SOURCES:  
O Co'Nee Association Property Map, 1986.  
Construction date, NW cornerstone.  
Tuttle, Etta A. A Brief History of Bay Shore, 1962, p. 5.

22. THEME:  
 Research by the Society for the Preservation of Long Island Antiquities - KEK

Continuation Sheet  
St. Luke's Lutheran Church

October 1986

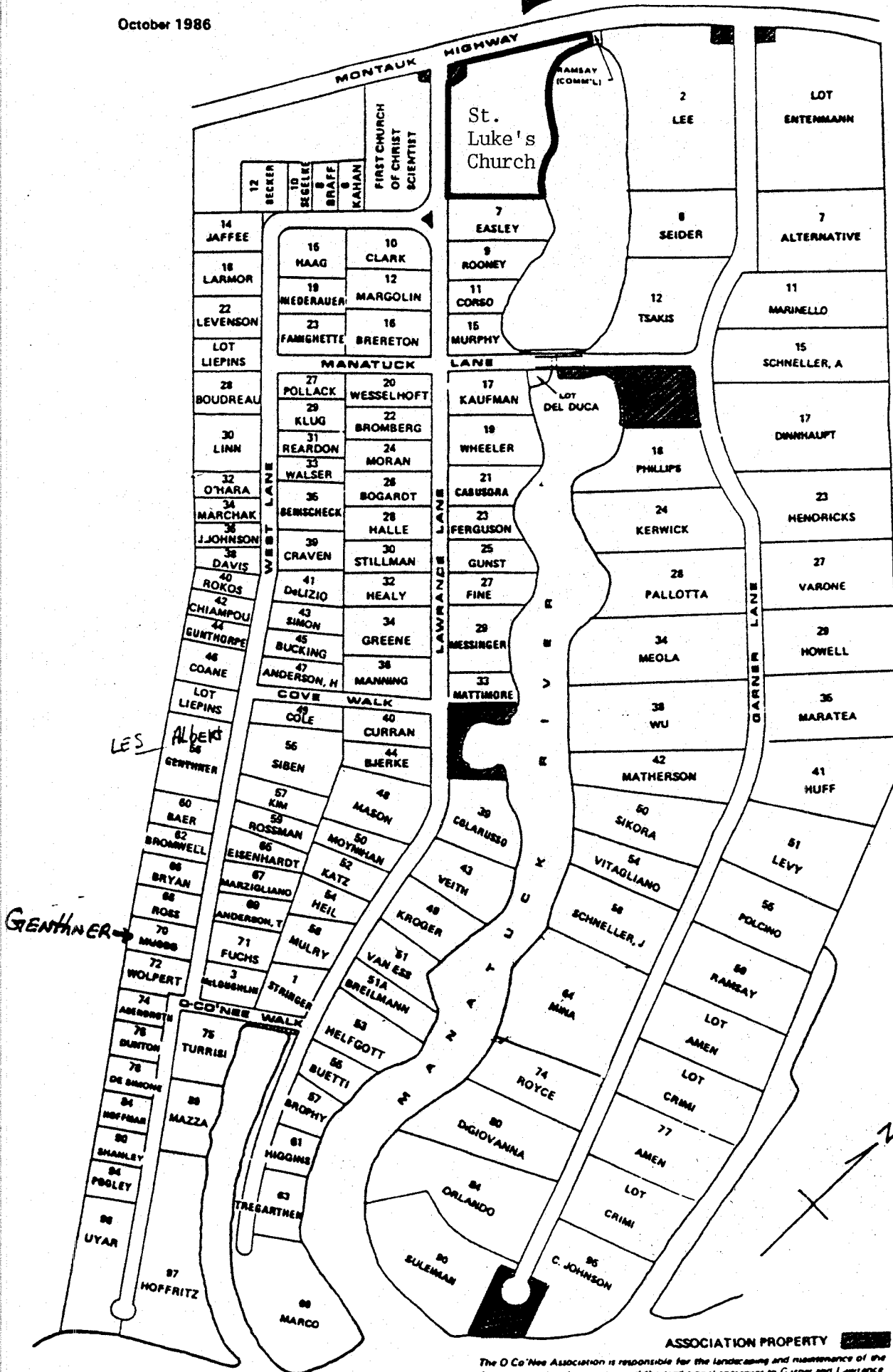

ASSOCIATION PROPERTY

The O'Co'Nee Association is responsible for the landscaping and maintenance of the Association-owned properties and the traditional entrances to Corner and Lawrence Lane. It also employs a patrol service to increase the security of the entire area.