

2 BUILDING-STRUCTURE INVENTORY FORM

DIVISION FOR HISTORIC PRESERVATION
NEW YORK STATE PARKS AND RECREATION
ALBANY, NEW YORK (518) 474-0479

FOR OFFICE USE ONLY

UNIQUE SITE NO. 10305.000680
QUAD _____
SERIES _____
NEG. NO. _____

BS 48

YOUR NAME: Town of Islip/SPLIA DATE: January 1990
Town Hall, 655 Main St.

YOUR ADDRESS: Islip, L.I., N.Y. 11751 TELEPHONE: 516.224.5450

ORGANIZATION (if any): Dept. of Planning, Housing, and Development

IDENTIFICATION

- 1. BUILDING NAME(S): Corso House
- 2. COUNTY: Suffolk TOWN/CITY: Islip VILLAGE: Bay Shore
- 3. STREET LOCATION: 11 Lawrance Lane, O Co'Nee
- 4. OWNERSHIP: a. public b. private
- 5. PRESENT OWNER: _____ ADDRESS: _____
- 6. USE: Original: residence Present: residence
- 7. ACCESSIBILITY TO PUBLIC: Exterior visible from public road: Yes No
Interior accessible: Explain private residence

DESCRIPTION

- 8. BUILDING MATERIAL: a. clapboard b. stone c. brick d. board and batten
e. cobblestone f. shingles g. stucco other: _____
- 9. STRUCTURAL SYSTEM: a. wood frame with interlocking joints
(if known) b. wood frame with light members
c. masonry load bearing walls
d. metal (explain) _____
e. other _____
- 10. CONDITION: a. excellent b. good c. fair d. deteriorated
- 11. INTEGRITY: a. original site b. moved if so, when? _____
c. list major alterations and dates (if known): _____

12. PHOTO: Neg. KK V-10, fm. W

13. MAP: NYS DOT Bay Shore East & West Quads

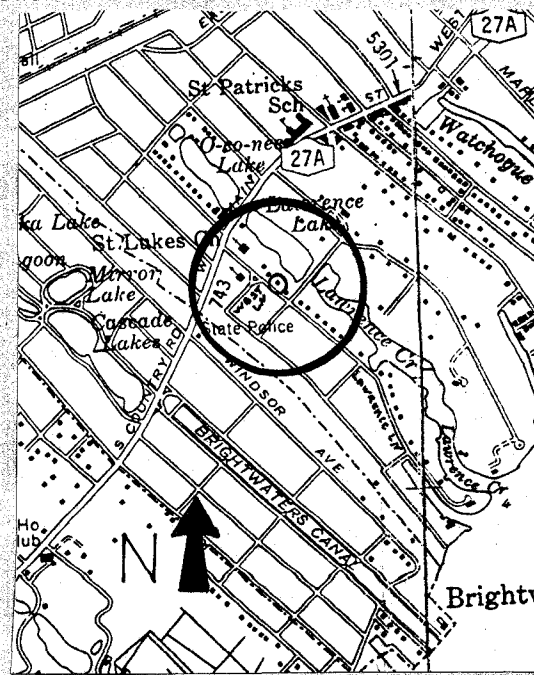

14. THREATS TO BUILDING: a. none known b. zoning c. roads
 d. developers e. deterioration
 f. other: _____
15. RELATED OUTBUILDINGS AND PROPERTY:
 a. barn b. carriage house c. garage
 d. privy e. shed f. greenhouse
 g. shop h. gardens
 i. landscape features: _____
 j. other: brick walls and posts near north facade
16. SURROUNDINGS OF THE BUILDING (check more than one if necessary):
 a. open land b. woodland
 c. scattered buildings
 d. densely built-up e. commercial
 f. industrial g. residential
 h. other: _____

17. INTERRELATIONSHIP OF BUILDING AND SURROUNDINGS: In O Co'Nee District
 (Indicate if building or structure is in an historic district)

11 Lawrance Lane is located in the western section of the private residential community of the O Co'Nee Association, characterized by residences smaller than those in the eastern section of the community of similar date and general type.

18. OTHER NOTABLE FEATURES OF BUILDING AND SITE (including interior features if known):
 11 Lawrance Lane is a 1½ story, brick, irregularly shaped English Tudor Revival, steep gable roof house with a Ludovici tile roof and diagonally set decorative brick course under the eaves. The entrance bay is a two story, high pyramidal roof element at the juncture of an "L" shaped block. Clipped gable roof dormers feature curved timber brackets.

SIGNIFICANCE

19. DATE OF INITIAL CONSTRUCTION: 1920's

ARCHITECT: _____

BUILDER: _____

20. HISTORICAL AND ARCHITECTURAL IMPORTANCE:

The lot sizes on Lawrance Lane are generally smaller than those on Garner Lane. However, the character of many of the houses continues the district theme.

21. SOURCES:

O Co'Nee Association Property Map, 1986.

22. THEME:

Research by the Society for the Preservation of Long Island Antiquities - KEK

October 1986

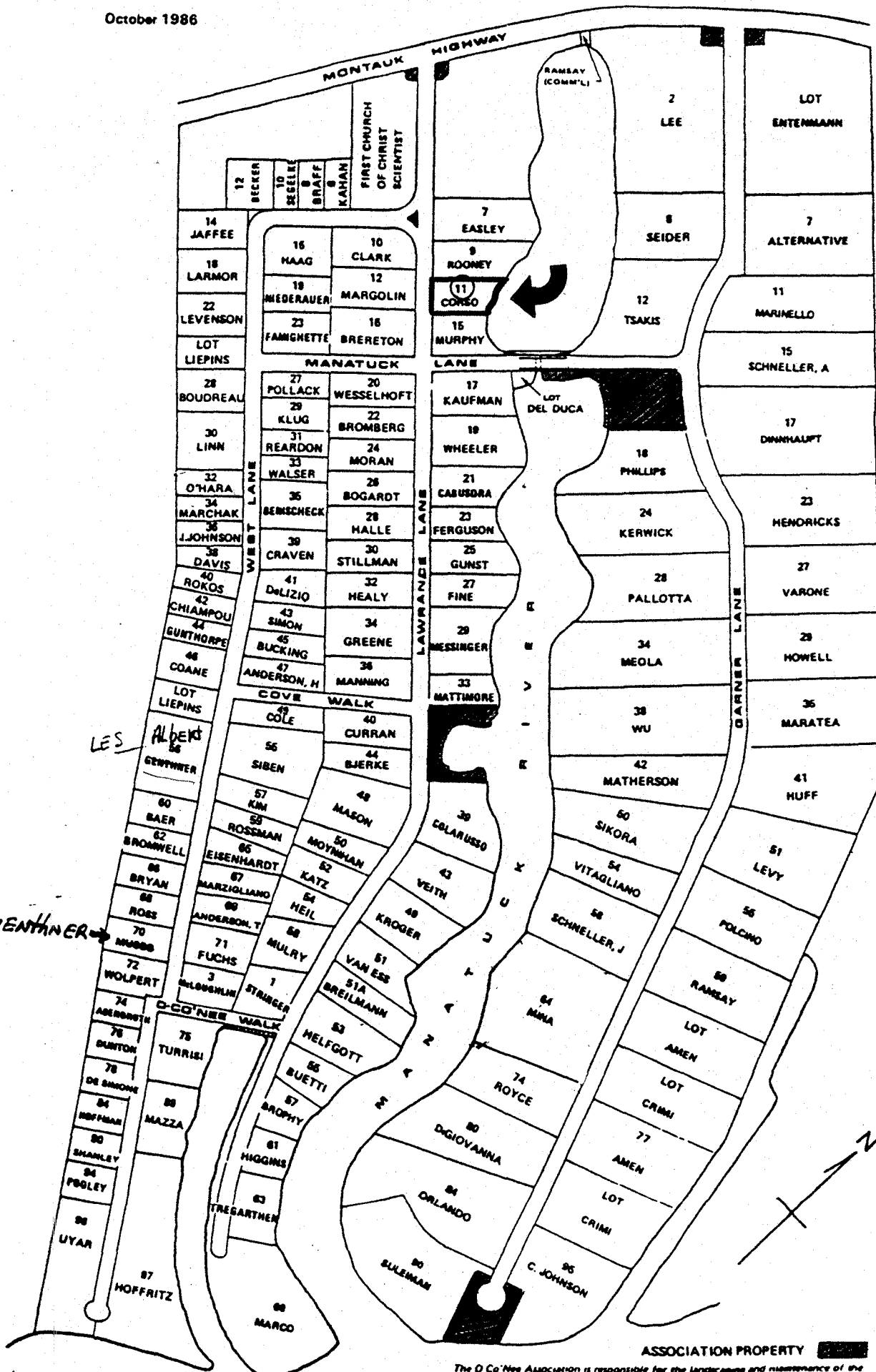

ASSOCIATION PROPERTY

The O Co'Nee Association is responsible for the landscaping and maintenance of the Association-owned properties and the traditional entrances to Curran and Lawrence Lane. It also employs a patrol service to increase the security of the entire area.