

**BUILDING-STRUCTURE INVENTORY FORM**

DIVISION FOR HISTORIC PRESERVATION  
NEW YORK STATE PARKS AND RECREATION  
ALBANY, NEW YORK (518) 474-0479

FOR OFFICE USE ONLY

UNIQUE SITE NO. 10305.000687  
QUAD \_\_\_\_\_  
SERIES \_\_\_\_\_  
NEG. NO. \_\_\_\_\_

BS 53A

YOUR NAME: Town of Islip/SPLIA DATE: January 1990

Town Hall, 655 Main St.  
YOUR ADDRESS: Islip, L.I., N.Y. 11751 TELEPHONE: 516.224.5450

ORGANIZATION (if any): Dept. of Planning, Housing, and Development

\*\*\*\*\*

**IDENTIFICATION**

- 1. BUILDING NAME(S): Frank Lawrance Estate Outbuilding
- 2. COUNTY: Suffolk TOWN/CITY: Islip VILLAGE: Bay Shore
- 3. STREET LOCATION: 52 Hemlock Lane
- 4. OWNERSHIP: a. public  b. private
- 5. PRESENT OWNER: John Carney ADDRESS: \_\_\_\_\_
- 6. USE: Original: residence Present: residence
- 7. ACCESSIBILITY TO PUBLIC: Exterior visible from public road: Yes  No   
Interior accessible: Explain private residence

**DESCRIPTION**

- 8. BUILDING MATERIAL: a. clapboard  b. stone  c. brick  d. board and batten   
e. cobblestone  f. shingles  g. stucco  other: modern cladding
- 9. STRUCTURAL SYSTEM: a. wood frame with interlocking joints  partial  
b. wood frame with light members   
(if known) c. masonry load bearing walls   
d. metal (explain) \_\_\_\_\_  
e. other \_\_\_\_\_
- 10. CONDITION: a. excellent  b. good  c. fair  d. deteriorated
- 11. INTEGRITY: a. original site  partially moved  if so, when? part moved in 1920's from Main St.  
c. list major alterations and dates (if known):  
cladding replaced

12. PHOTO: Neg. KK V-20, fm. E

13. MAP: NYS DOT Bay Shore West Quad

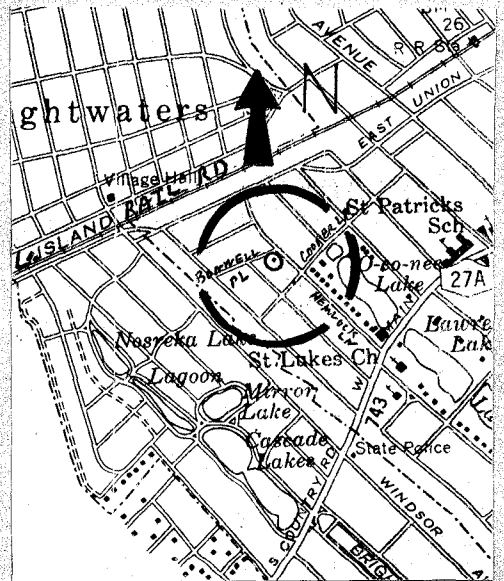

HP-1

14. THREATS TO BUILDING: a. none known  b. zoning  c. roads   
 d. developers  e. deterioration   
 f. other: \_\_\_\_\_
15. RELATED OUTBUILDINGS AND PROPERTY:  
 a. barn  b. carriage house  c. garage   
 d. privy  e. shed  f. greenhouse   
 g. shop  h. gardens   
 i. landscape features: \_\_\_\_\_  
 j. other: \_\_\_\_\_
16. SURROUNDINGS OF THE BUILDING (check more than one if necessary):  
 a. open land  b. woodland   
 c. scattered buildings   
 d. densely built-up  e. commercial   
 f. industrial  g. residential   
 h. other: \_\_\_\_\_

17. INTERRELATIONSHIP OF BUILDING AND SURROUNDINGS:

(Indicate if building or structure is in an historic district)

52 Hemlock Lane is an older house in a residential area that does not conform to the alignment of neighboring lots and streets. It is surrounded by predominantly early to mid 20th century residences of similar scale.

18. OTHER NOTABLE FEATURES OF BUILDING AND SITE (including interior features if known):

52 Hemlock Lane is a 2½ story, narrow, gable roof house with a two bay gable end to the street, ~~primarily facade facing Hemlock Lane~~  
 A 1½ story, three bay, gable roof garage stands at the NE corner of the property.

SIGNIFICANCE

19. DATE OF INITIAL CONSTRUCTION: \_\_\_\_\_ c. 1840, and later

ARCHITECT: \_\_\_\_\_

BUILDER: \_\_\_\_\_

20. HISTORICAL AND ARCHITECTURAL IMPORTANCE:

This is a three-part house. One section has wooden pegs, now the kitchen. One section was "Melton's Dairy Barn," moved from Main Street in the 1920's. The name is painted on the shingles and now covered with modern cladding. Another part has animal stalls in the cellar. All in all an interesting relic, predating the Frank Lawrence estate.

21. SOURCES:

E. Belcher Hyde. Atlas of the Ocean Shore of Suffolk County, L.I., (westerly section), 1915.  
 Interview, owner Mrs. Carney, (665-8972), 12/1989.

22. THEME:

Research by the Society for the Preservation of Long Island Antiquities - KEK

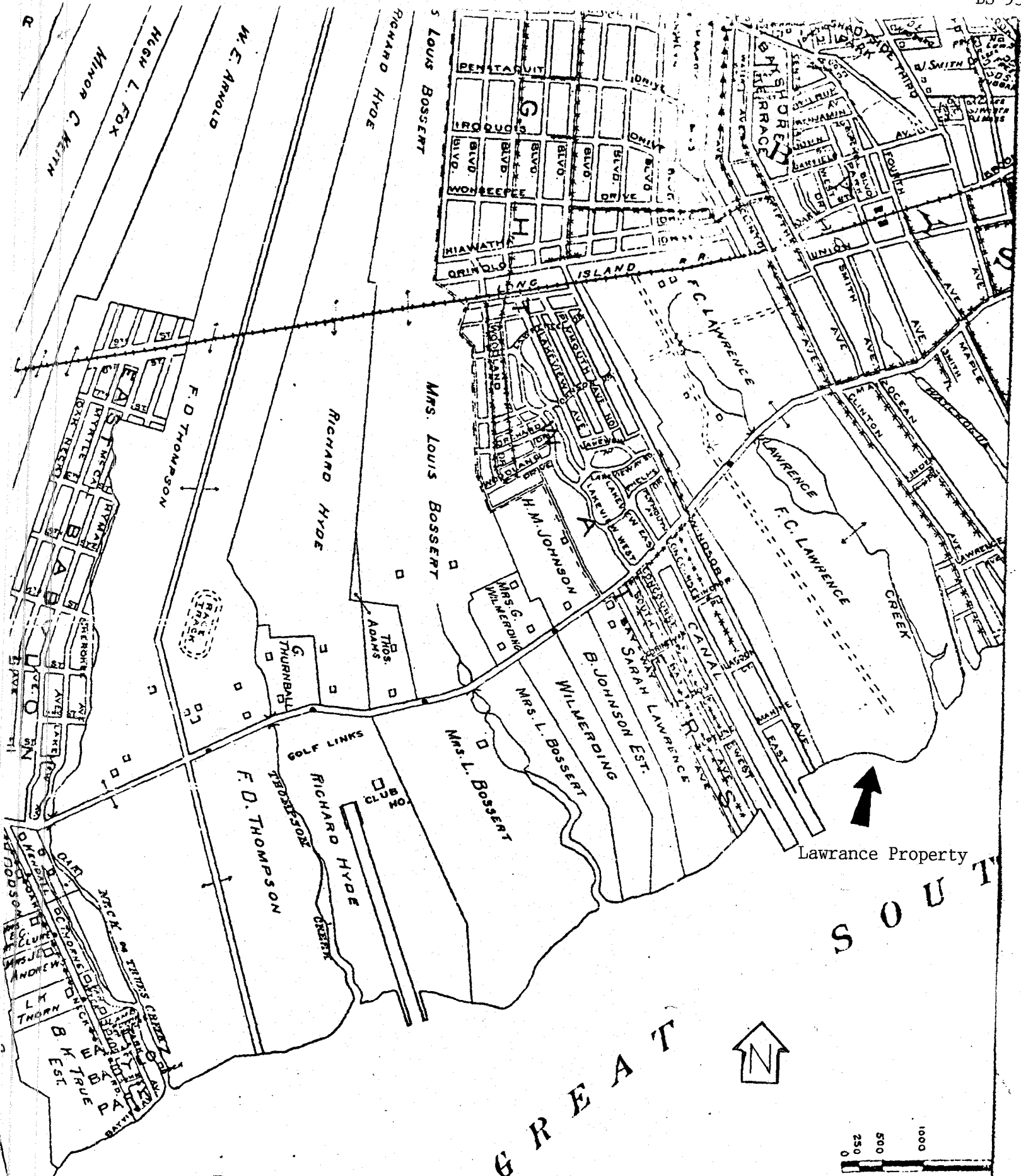

E. Belcher Hyde. Atlas of the Ocean Shore of Suffolk County, L.I. (westerly section), 1915.

CONKLIN POINT