

BUILDING-STRUCTURE INVENTORY FORM

DIVISION FOR HISTORIC PRESERVATION
NEW YORK STATE PARKS AND RECREATION
ALBANY, NEW YORK (518) 474-0479

FOR OFFICE USE ONLY
UNIQUE SITE NO. 10305.000673
QUAD _____
SERIES _____
NEG. NO. _____

BS 41A

YOUR NAME: Town of Islip/SPLIA DATE: January 1990
Town Hall, 655 Main St.
YOUR ADDRESS: Islip, L.I., N.Y. 11751 TELEPHONE: 516.224.5450
ORGANIZATION (if any): Dept. of Planning, Housing, and Development

IDENTIFICATION

1. BUILDING NAME(S): Terry/Polcino House
2. COUNTY: Suffolk TOWN/CITY: Islip VILLAGE: Bay Shore
3. STREET LOCATION: 55 Garner Lane, O Co'Nee
4. OWNERSHIP: a. public b. private
5. PRESENT OWNER: Polcino ADDRESS: _____
6. USE: Original: residence Present: residence
7. ACCESSIBILITY TO PUBLIC: Exterior visible from public road: Yes No
Interior accessible: Explain private residence

DESCRIPTION

8. BUILDING MATERIAL: a. clapboard b. stone c. brick d. board and batten
e. cobblestone f. shingles g. stucco other: _____
9. STRUCTURAL SYSTEM: a. wood frame with interlocking joints
(if known) b. wood frame with light members
c. masonry load bearing walls
d. metal (explain) _____
e. other _____
10. CONDITION: a. excellent b. good c. fair d. deteriorated
11. INTEGRITY: a. original site b. moved if so, when? c. 1955
c. list major alterations and dates (if known):
Entrance has been colonialized
Garage wing added to north

12. PHOTO: Neg. KK IV-25, fm. W/NW 13. MAP: NYS DOT Bay Shore East & West Quads

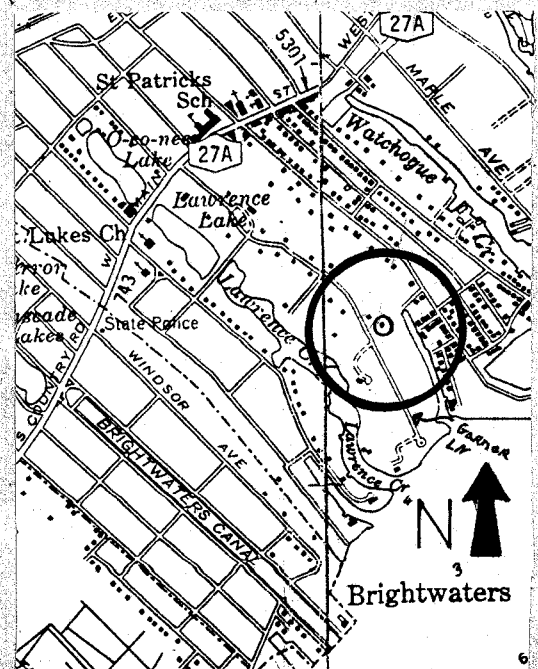

14. THREATS TO BUILDING: a. none known b. zoning c. roads
 d. developers e. deterioration
 f. other: _____
15. RELATED OUTBUILDINGS AND PROPERTY:
 a. barn b. carriage house c. garage
 d. privy e. shed f. greenhouse
 g. shop h. gardens
 i. landscape features: large lawn
 j. other: _____
16. SURROUNDINGS OF THE BUILDING (check more than one if necessary):
 a. open land b. woodland
 c. scattered buildings
 d. densely built-up e. commercial
 f. industrial g. residential
 h. other: _____

17. INTERRELATIONSHIP OF BUILDING AND SURROUNDINGS: In O Co'Nee District
 (Indicate if building or structure is in an historic district)

55 Garner Lane is located in the private residential community of the O Co'Nee Association south of Montauk Highway. It is surrounded by residences of comparable age and size on large landscaped lots. A small creek lies directly east of the house.

18. OTHER NOTABLE FEATURES OF BUILDING AND SITE (including interior features if known):
 55 Garner Lane is a large, 2½ story, shingled, high hip roof, rectangular house in the Arts and Crafts style with wide overhanging eaves and exposed rafter ends. A prominent semi-hexagonal dormer is centered on the main (west) roof slope with a triple window band.

SIGNIFICANCE

19. DATE OF INITIAL CONSTRUCTION: c. 1918 - 1920's*

ARCHITECT: _____

BUILDER: _____

20. HISTORICAL AND ARCHITECTURAL IMPORTANCE:

This house is an important component of the O Co'Nee District.

21. SOURCES:

O Co'Nee Association Property Map, 1986.

* Interview, owner Polcino, December 1989.

22. THEME:

Research by the Society for the Preservation of Long Island Antiquities - KEK

Continuation Sheet
Terry/Polcino House

October 1986

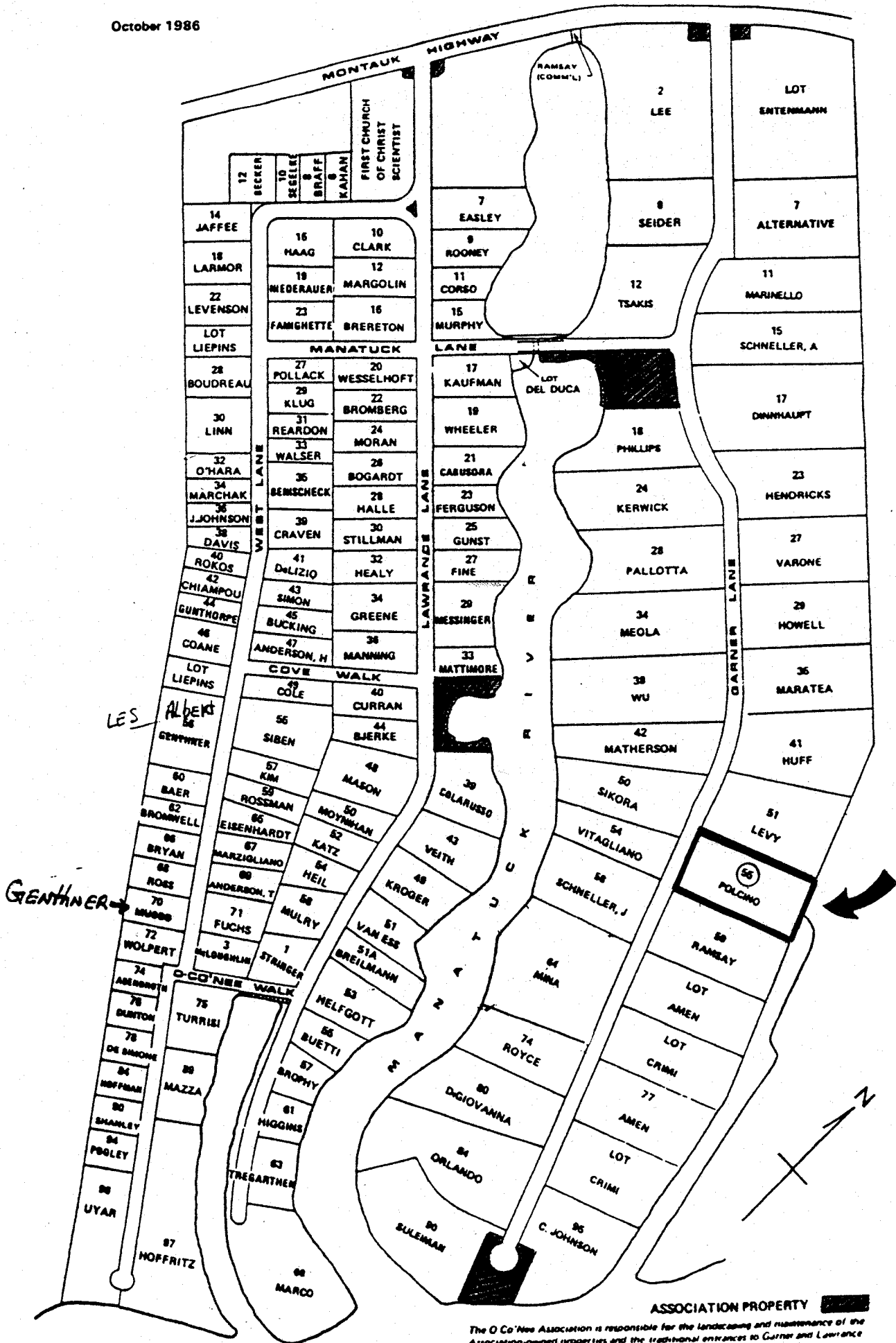

ASSOCIATION PROPERTY

The O Co'Nee Association is responsible for the landscaping and maintenance of the Association-owned properties and the traditional entrances to Garner and Lawrence Lanes. It also employs a patrol service to increase the security of the entire area.