

BUILDING-STRUCTURE INVENTORY FORM

DIVISION FOR HISTORIC PRESERVATION
NEW YORK STATE PARKS AND RECREATION
ALBANY, NEW YORK (518) 474-0479

FOR OFFICE USE ONLY

UNIQUE SITE NO. 10305.000672
QUAD _____
SERIES _____
NEG. NO. _____

BS 41

YOUR NAME: Town of Islip/SPLIA DATE: January 1990
Town Hall, 655 Main St.
YOUR ADDRESS: Islip, L.I., N.Y. 11751 TELEPHONE: 516.224.5450
ORGANIZATION (if any): Dept. of Planning, Housing, and Development

IDENTIFICATION

1. BUILDING NAME(S): Sikora House
2. COUNTY: Suffolk TOWN/CITY: Islip VILLAGE: Bay Shore
3. STREET LOCATION: 50 Garner Lane, O'Neel Co. Nee
4. OWNERSHIP: a. public b. private
5. PRESENT OWNER: _____ ADDRESS: _____
6. USE: Original: residence Present: residence
7. ACCESSIBILITY TO PUBLIC: Exterior visible from public road: Yes No
Interior accessible: Explain private residence

DESCRIPTION

8. BUILDING MATERIAL: a. clapboard b. stone c. brick d. board and batten
e. cobblestone f. shingles g. stucco other: _____
9. STRUCTURAL SYSTEM: a. wood frame with interlocking joints
(if known) b. wood frame with light members
c. masonry load bearing walls
d. metal (explain) _____
e. other _____
10. CONDITION: a. excellent b. good c. fair d. deteriorated
11. INTEGRITY: a. original site b. moved if so, when? _____
c. list major alterations and dates (if known): _____

12. PHOTO: Neg. KK XIV-17A, fm. SW.

13. MAP: NYS DOT Bay Shore East & West Quads



HP-1

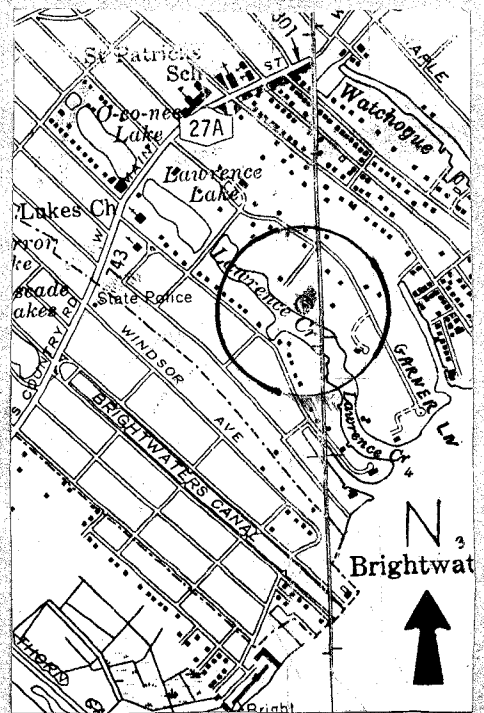

14. THREATS TO BUILDING: a. none known b. zoning c. roads
 d. developers e. deterioration
 f. other: _____
15. RELATED OUTBUILDINGS AND PROPERTY:
 a. barn b. carriage house c. garage
 d. privy e. shed f. greenhouse
 g. shop h. gardens
 i. landscape features: Lawrance Creek directly west
 j. other: stable (refer to continuation sheet)
16. SURROUNDINGS OF THE BUILDING (check more than one if necessary):
 a. open land b. woodland
 c. scattered buildings
 d. densely built-up e. commercial
 f. industrial g. residential
 h. other: Lawrance Creek
17. INTERRELATIONSHIP OF BUILDING AND SURROUNDINGS: In O Co'Nee District
 (Indicate if building or structure is in an historic district)
 50 Garner Lane is located in the private residential community of the O Co'Nee Association, south of Montauk Highway. The house is set back from the road and not visible from the street.
18. OTHER NOTABLE FEATURES OF BUILDING AND SITE (including interior features if known):
 50 Garner Avenue is a 1½ story, irregularly shaped, gable roof, brick/shingle/stone house with a slate roof. Squared posts support a recessed entrance on the main block, set perpendicular to the street. To the east is a 1½ story, shingled, gable roof wing. The house features pedimented dormers.
- SIGNIFICANCE**
19. DATE OF INITIAL CONSTRUCTION: c. 1930 - 35*
- ARCHITECT: _____
- BUILDER: _____
20. HISTORICAL AND ARCHITECTURAL IMPORTANCE:
 The three bay stable with elliptical arch colonnade adds to the importance of this house. The house is an important component in the O Co'Nee District.
21. SOURCES:
O Co'Nee Association Property Map, 1986.
 Correspondence, Robert Ceilly, Eric Ramsay Assoc., Bay Shore, March 1990.
22. THEME:
 Research by the Society for the Preservation of Long Island Antiquities - KEK



Neg. KK XIV-18A, fm. W, showing west and north (entrance) facades.



Neg. KK XIV-19A, fm. N/NW. View of stable.

Continuation Sheet
Sikora House

October 1986

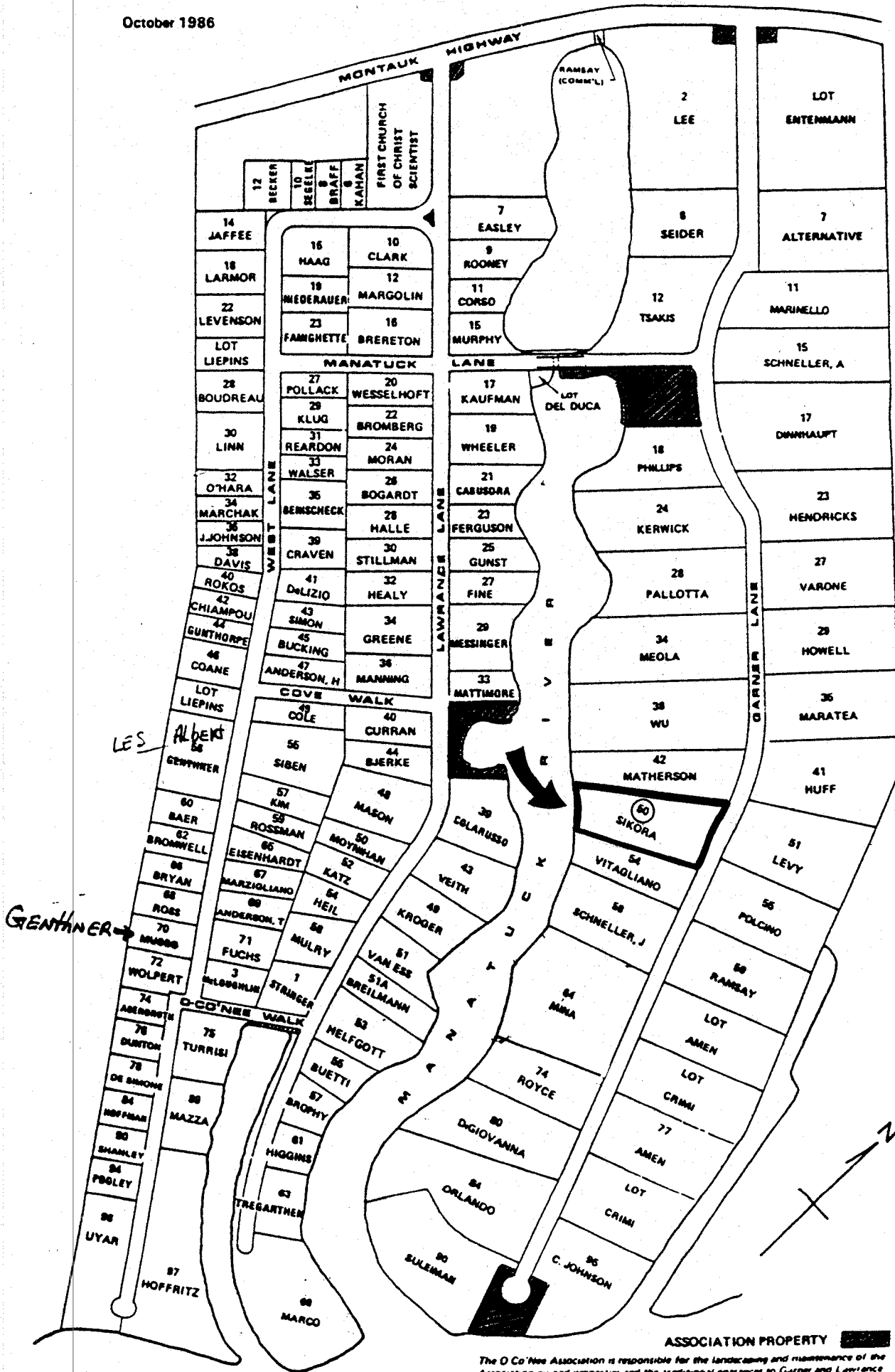

ASSOCIATION PROPERTY

The O Co'Nee Association is responsible for the landscaping and maintenance of the Association-owned properties and the traditional entrances to Corner and Lawrence Lanes. It also employs a patrol service to increase the security of the entire area.