

**BUILDING-STRUCTURE INVENTORY FORM**

FOR OFFICE USE ONLY

BS 39

DIVISION FOR HISTORIC PRESERVATION  
NEW YORK STATE PARKS AND RECREATION  
ALBANY, NEW YORK (518) 474-0479

UNIQUE SITE NO. 10305.000670  
QUAD \_\_\_\_\_  
SERIES \_\_\_\_\_  
NEG. NO. \_\_\_\_\_

YOUR NAME: Town of Islip/SPLIA DATE: January 1990

Town Hall, 655 Main St.

YOUR ADDRESS: Islip, L.I., N.Y. 11751 TELEPHONE: 516.224.5450

ORGANIZATION (if any): Dept. of Planning, Housing, and Development

\*\*\*\*\*

**IDENTIFICATION**

1. BUILDING NAME(S): Pallotta House

2. COUNTY: Suffolk TOWN/CITY: Islip VILLAGE: Bay Shore

3. STREET LOCATION: 28 Garner Lane, O Co'Nee

4. OWNERSHIP: a. public  b. private

5. PRESENT OWNER: Pallotta ADDRESS: \_\_\_\_\_

6. USE: Original: residence Present: residence

7. ACCESSIBILITY TO PUBLIC: Exterior visible from public road: Yes  No

Interior accessible: Explain private residence

**DESCRIPTION**

8. BUILDING MATERIAL: a. clapboard  b. stone  c. brick  d. board and batten   
e. cobblestone  f. shingles  g. stucco  other: \_\_\_\_\_

9. STRUCTURAL SYSTEM: (if known) a. wood frame with interlocking joints   
b. wood frame with light members   
c. masonry load bearing walls   
d. metal (explain) \_\_\_\_\_  
e. other \_\_\_\_\_

10. CONDITION: a. excellent  b. good  c. fair  d. deteriorated

11. INTEGRITY: a. original site  b. moved  if so, when? \_\_\_\_\_  
c. list major alterations and dates (if known):

One story wing added to north

12. PHOTO: Neg. KK XIV-12A, fm. E

13. MAP: NYS DOT Bay Shore East & West Quads

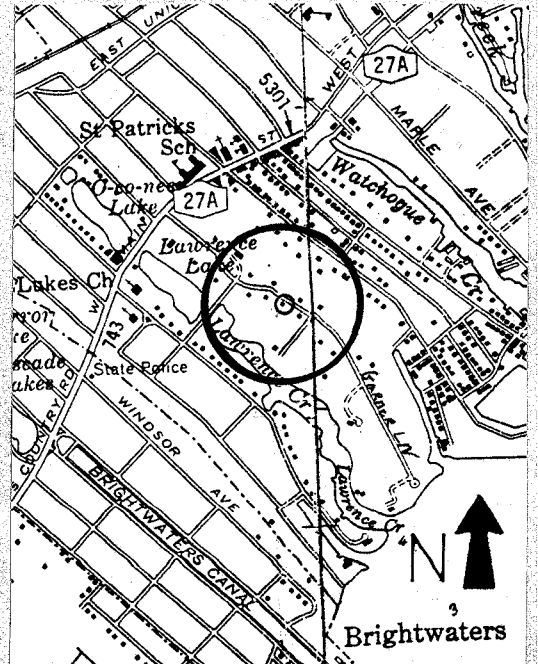

14. THREATS TO BUILDING: a. none known  b. zoning  c. roads   
 d. developers  e. deterioration   
 f. other: \_\_\_\_\_
15. RELATED OUTBUILDINGS AND PROPERTY:  
 a. barn  b. carriage house  c. garage   
 d. privy  e. shed  f. greenhouse   
 g. shop  h. gardens   
 i. landscape features: large specimen tree at circular drive  
 j. other: Lawrance Creek directly west
16. SURROUNDINGS OF THE BUILDING (check more than one if necessary):  
 a. open land  b. woodland   
 c. scattered buildings   
 d. densely built-up  e. commercial   
 f. industrial  g. residential   
 h. other: \_\_\_\_\_

17. INTERRELATIONSHIP OF BUILDING AND SURROUNDINGS: In O Co'Nee District  
 (Indicate if building or structure is in an historic district)

28 Garner Lane is located in the private residential community of the O Co'Nee Association, south of Montauk Highway. It is surrounded by residences of similiar date and type on large landscaped parcels.

18. OTHER NOTABLE FEATURES OF BUILDING AND SITE (including interior features if known):  
 28 Garner Lane is a large, 2½ story, symmetrical, five bay, hip roof house in the stripped - Georgian Revival style with a 2½ story, centered entrance projection marked by quoins and a pilastered Palladian window over a broken arch entrance door pediment. Quoins also mark the corners of the main block and the south wing is pilastered. The roof features a widow's walk with handsome railing.

SIGNIFICANCE \_\_\_\_\_ 1921\*

19. DATE OF INITIAL CONSTRUCTION: \_\_\_\_\_

ARCHITECT: \_\_\_\_\_

BUILDER: \_\_\_\_\_

20. HISTORICAL AND ARCHITECTURAL IMPORTANCE:

This handsome mansion is an important component of the O Co'Nee District.

21. SOURCES:  
O Co'Nee Association Property Map, 1986.  
 \*Interview, owner Pallotta, 11/1989.

22. THEME:

Research by the Society for the Preservation of Long Island Antiquities - KEK

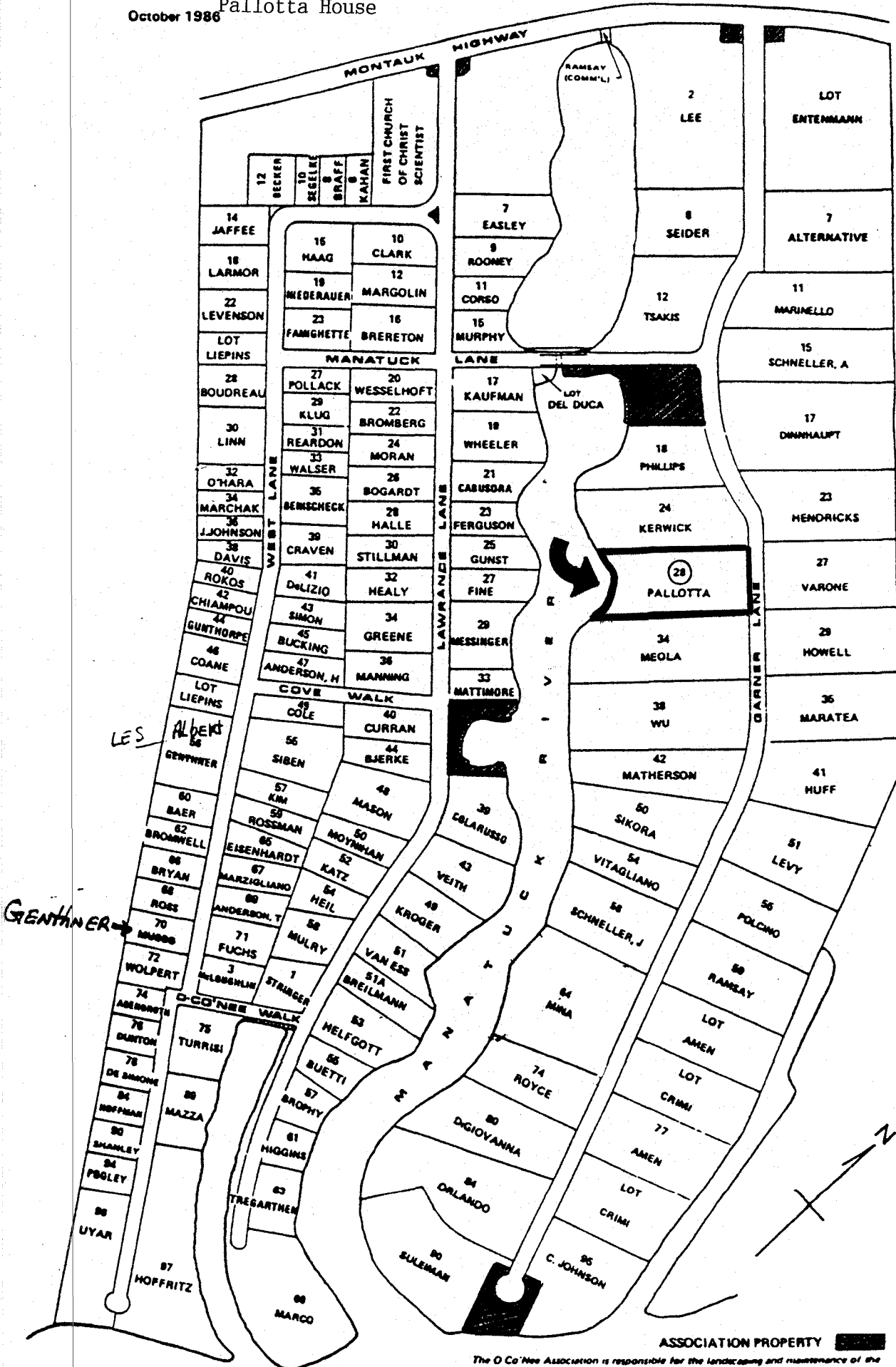

**ASSOCIATION PROPERTY**

The O Co'Ne Association is responsible for the landscaping and maintenance of the Association-owned properties and the traditional entrances to Garner and Lawrence Lanes. It also employs a patrol service to increase the security of the entire area.