

BUILDING-STRUCTURE INVENTORY FORM

DIVISION FOR HISTORIC PRESERVATION
NEW YORK STATE PARKS AND RECREATION
ALBANY, NEW YORK (518) 474-0479

FOR OFFICE USE ONLY
UNIQUE SITE NO. 10305.000665
QUAD _____
SERIES _____
NEG. NO. _____

BS 34A

YOUR NAME: Town of Islip/SPLIA DATE: January 1990
Town Hall, 655 Main St.
YOUR ADDRESS: Islip, L.I., N.Y. 11751 TELEPHONE: 516.224.5450
ORGANIZATION (if any): Dept. of Planning, Housing, and Development

IDENTIFICATION

1. BUILDING NAME(S): Lee House
2. COUNTY: Suffolk TOWN/CITY: Islip VILLAGE: Bay Shore
3. STREET LOCATION: 2 Garner Lane, O Co'Nee
4. OWNERSHIP: a. public b. private
5. PRESENT OWNER: _____ ADDRESS: _____
6. USE: Original: residence Present: residence
7. ACCESSIBILITY TO PUBLIC: Exterior visible from public road: Yes No
Interior accessible: Explain private residence

DESCRIPTION

8. BUILDING MATERIAL: a. clapboard b. stone c. brick d. board and batten
e. cobblestone f. shingles g. stucco other: _____
9. STRUCTURAL SYSTEM: a. wood frame with interlocking joints
(if known) b. wood frame with light members
c. masonry load bearing walls
d. metal (explain) _____
e. other _____
10. CONDITION: a. excellent b. good c. fair d. deteriorated
11. INTEGRITY: a. original site b. moved if so, when? _____
c. list major alterations and dates (if known): _____

12. PHOTO: Neg. KK III-33, fm. N 13. MAP: NYS DOT Bay Shore East & West Quads

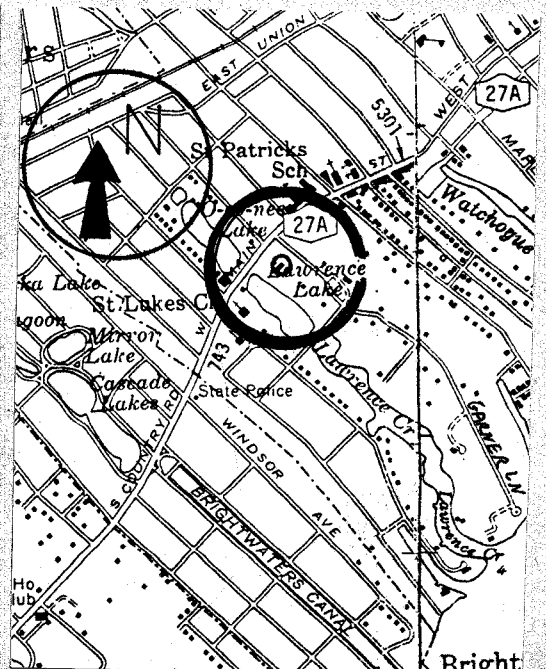

14. THREATS TO BUILDING: a. none known b. zoning c. roads
 d. developers e. deterioration
 f. other: _____
15. RELATED OUTBUILDINGS AND PROPERTY:
 a. barn b. carriage house c. garage
 d. privy e. shed f. greenhouse
 g. shop h. gardens
 i. landscape features: Lawrance Lake directly west
 j. other: circular driveway, large lawn
16. SURROUNDINGS OF THE BUILDING (check more than one if necessary):
 a. open land b. woodland
 c. scattered buildings
 d. densely built-up e. commercial
 f. industrial g. residential
 h. other: private community
17. INTERRELATIONSHIP OF BUILDING AND SURROUNDINGS: In O Co'Nee District
 (Indicate if building or structure is in an historic district)
 2 Garner Lane is located on the west side of Garner Lane at the SW corner of Montauk Highway and faces north. The house is the first property past the brick entrance posts that mark the O Co'Nee Assoc. property, a private residential community of predominantly large early 20th century houses.
18. OTHER NOTABLE FEATURES OF BUILDING AND SITE (including interior features if known):
 2 Garner Lane is a large, 2½ story, five bay, rectangular, gable roof house with a smaller, gable roof flanking wings. The main block is fronted by a two story flat roof portico with columns and "X" rail under three pedimented dormers. The pilastered entrance door is surmounted by a segmental arch broken pediment with center urn motif.

SIGNIFICANCE

19. DATE OF INITIAL CONSTRUCTION: 1920's

ARCHITECT: _____

BUILDER: _____

20. HISTORICAL AND ARCHITECTURAL IMPORTANCE:

This handsome house was owned by Lee on the 1986 O Co'Nee map. Its integrity is excellent and it is the anchor landmark of the O Co'Nee District.

21. SOURCES:

O Co'Nee Association Property Map, October 1986.

22. THEME:

Research by the Society for the Preservation of Long Island Antiquities - KEK

Continuation Sheet
Lee House

October 1986

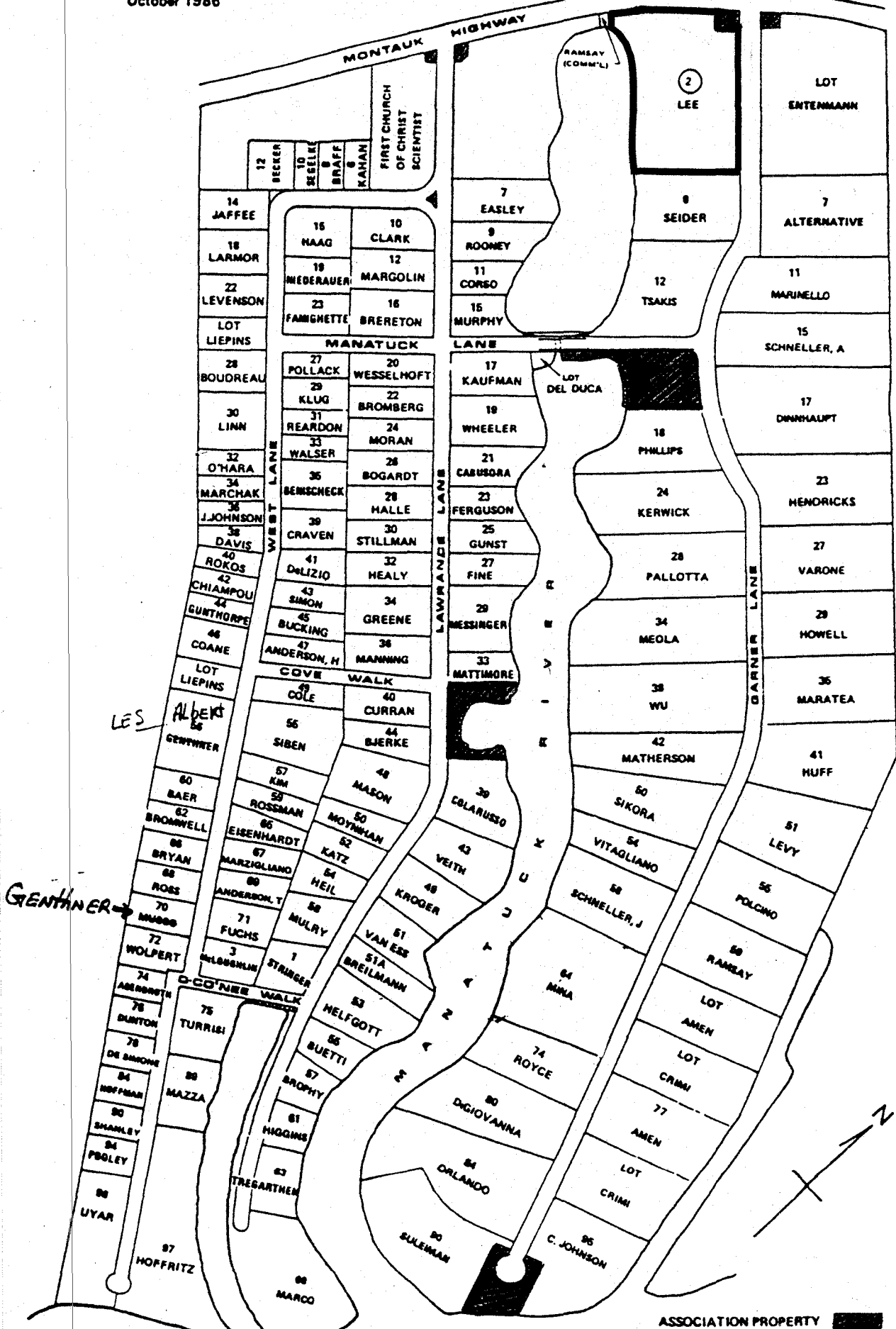

ASSOCIATION PROPERTY

The O Co'Nee Association is responsible for the landscaping and maintenance of the Association-owned properties and the traditional entrances to Garner and Lawrence Lanes. It also employs a patrol service to increase the security of the entire area.