

BUILDING-STRUCTURE INVENTORY FORM

FOR OFFICE USE ONLY
UNIQUE SITE NO. 10305.000668
QUAD _____
SERIES _____
NEG. NO. _____

DIVISION FOR HISTORIC PRESERVATION
NEW YORK STATE PARKS AND RECREATION
ALBANY, NEW YORK (518) 474-0479

YOUR NAME: Town of Islip/SPLIA DATE: January 1990
Town Hall, 655 Main St.
YOUR ADDRESS: Islip, L.I., N.Y. 11751 TELEPHONE: 516.224.5450
ORGANIZATION (if any): Dept. of Planning, Housing, and Development

IDENTIFICATION

1. BUILDING NAME(S): Dinnhaupt House
2. COUNTY: Suffolk TOWN/CITY: Islip VILLAGE: Bay Shore
3. STREET LOCATION: 17 Garner Lane, O Co'Nee
4. OWNERSHIP: a. public b. private
5. PRESENT OWNER: _____ ADDRESS: _____
6. USE: Original: residence Present: residence
7. ACCESSIBILITY TO PUBLIC: Exterior visible from public road: Yes No
Interior accessible: Explain private residence

DESCRIPTION

8. BUILDING MATERIAL: a. clapboard b. stone c. brick d. board and batten
e. cobblestone f. shingles g. stucco other: half timber
9. STRUCTURAL SYSTEM: a. wood frame with interlocking joints
(if known) b. wood frame with light members
c. masonry load bearing walls
d. metal (explain) _____
e. other _____
10. CONDITION: a. excellent b. good c. fair d. deteriorated
11. INTEGRITY: a. original site b. moved if so, when? _____
c. list major alterations and dates (if known): _____

12. PHOTO: Neg. KK IV-III, fm. SW 13. MAP: NYS DOT Bay Shore East & West Quads

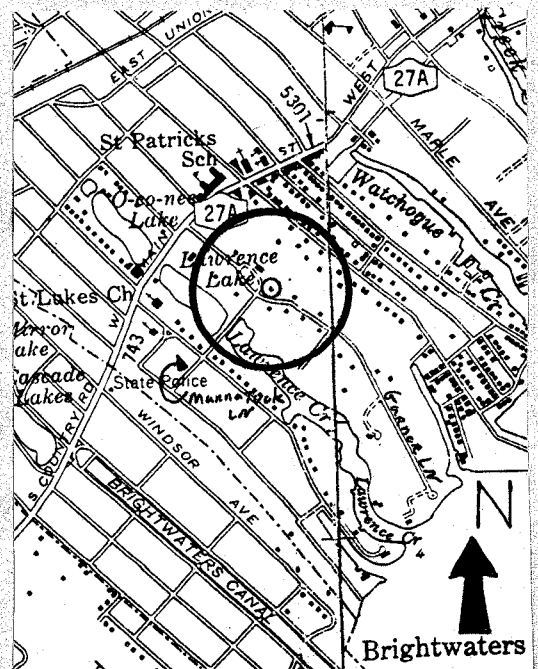

14. THREATS TO BUILDING: a. none known b. zoning c. roads
 d. developers e. deterioration
 f. other: _____
15. RELATED OUTBUILDINGS AND PROPERTY:
 a. barn b. carriage house c. garage matching
 d. privy e. shed f. greenhouse
 g. shop h. gardens
 i. landscape features: reflecting pond
 j. other: concrete gate posts to driveway court
16. SURROUNDINGS OF THE BUILDING (check more than one if necessary):
 a. open land b. woodland
 c. scattered buildings
 d. densely built-up e. commercial
 f. industrial g. residential
 h. other: private community

17. INTERRELATIONSHIP OF BUILDING AND SURROUNDINGS: In O Co'Nee District
 (Indicate if building or structure is in an historic district)

17 Garner Lane is located in the private residential community of the O Co'Nee Association, south of Montauk Highway. It is surrounded by residences of similiar date on large lots and is the only residence in the Association built in this style.

18. OTHER NOTABLE FEATURES OF BUILDING AND SITE (including interior features if known):
 17 Garner Lane is a large, 2½ story, simulated thatch, hip roof house with a brick ground story and stucco/half timbering on the upper story. The roof is marked with clipped gable wall face dormers and a tall second story oriel window on the west facade. The subsumed entrance porch at the NW corner features a bracketed pedimented hood.

SIGNIFICANCE

19. DATE OF INITIAL CONSTRUCTION: 1922

ARCHITECT: _____

BUILDER: _____

20. HISTORICAL AND ARCHITECTURAL IMPORTANCE:

The Dinnhaupt House was reportedly owned by the president of a railroad. Wenger was a former owner. This magnificent house in the manner of English architect, Voysey, is a good example of the English Arts & Crafts movement. It is an important component of the O'Co'Nee District.

21. SOURCES:

Service, Alastair. Edwardian Architecture and Its Origins. The Architectural Press Ltd., 1975.
 Interview, owner Dinnhaupt, November 1989.

22. THEME:

Research by the Society for the Preservation of Long Island Antiquities - KEK

October 1986

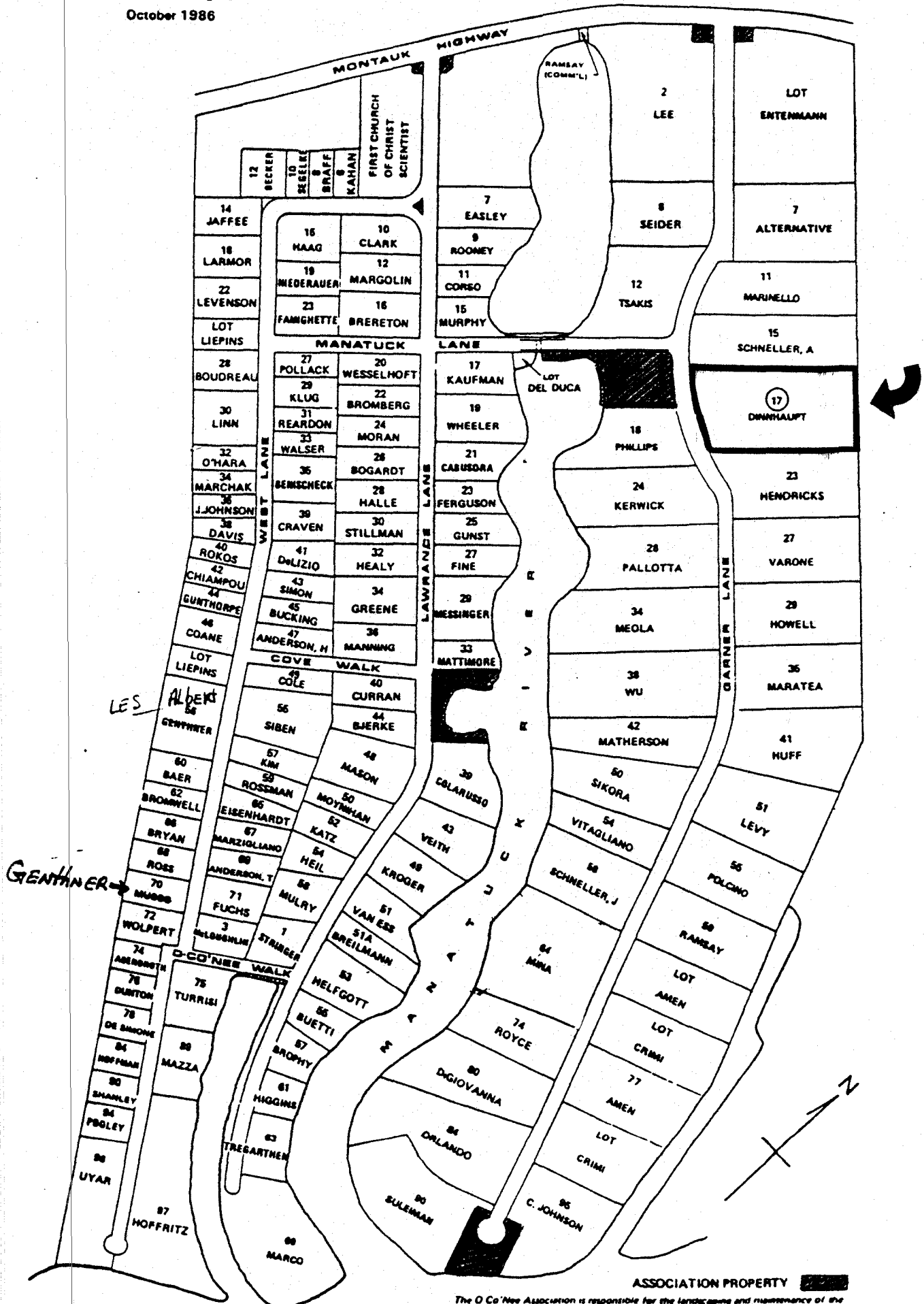

ASSOCIATION PROPERTY

The O Co'Nee Association is responsible for the landscaping and maintenance of the Association-owned properties and the traditional entrances to Garner and Lawrence Lanes. It also employs a patrol service to increase the security of the entire area.