

BUILDING-STRUCTURE INVENTORY FORM

FOR OFFICE USE ONLY

BS 60

DIVISION FOR HISTORIC PRESERVATION
NEW YORK STATE PARKS AND RECREATION
ALBANY, NEW YORK (518) 474-0479

UNIQUE SITE NO. 10365.000695
QUAD _____
SERIES _____
NEG. NO. _____

YOUR NAME: Town of Islip/SPLIA DATE: February 1990
Town Hall, 655 Main St.
YOUR ADDRESS: Islip, L.I., N.Y. 11751 TELEPHONE: 516.224.5450
ORGANIZATION (if any): Dept. of Planning, Housing, and Development

IDENTIFICATION

- 1. BUILDING NAME(S): St. Patrick Cemetery
- 2. COUNTY: Suffolk TOWN/CITY: Islip VILLAGE: Bay Shore
- 3. STREET LOCATION: Brentwood Rd., east side, opposite Tillie St.
- 4. OWNERSHIP: a. public b. private
- 5. PRESENT OWNER: _____ ADDRESS: _____
- 6. USE: Original: cemetery Present: cemetery
- 7. ACCESSIBILITY TO PUBLIC: Exterior visible from public road: Yes No
Interior accessible: Explain yes

DESCRIPTION

- 8. BUILDING MATERIAL: a. clapboard b. stone c. brick d. board and batten
e. cobblestone f. shingles g. stucco other: _____
- 9. STRUCTURAL SYSTEM: a. wood frame with interlocking joints
(if known) b. wood frame with light members
c. masonry load bearing walls
d. metal (explain) _____
e. other _____
- 10. CONDITION: a. excellent b. good c. fair d. deteriorated
- 11. INTEGRITY: a. original site b. moved if so, when? c. 1916 from Main Street when
c. list major alterations and dates (if known): St. Patrick's Church was built.

12. PHOTO: Neg. KK VI-9, fm. W

13. MAP: NYS DOT Bay Shore East & West Quads

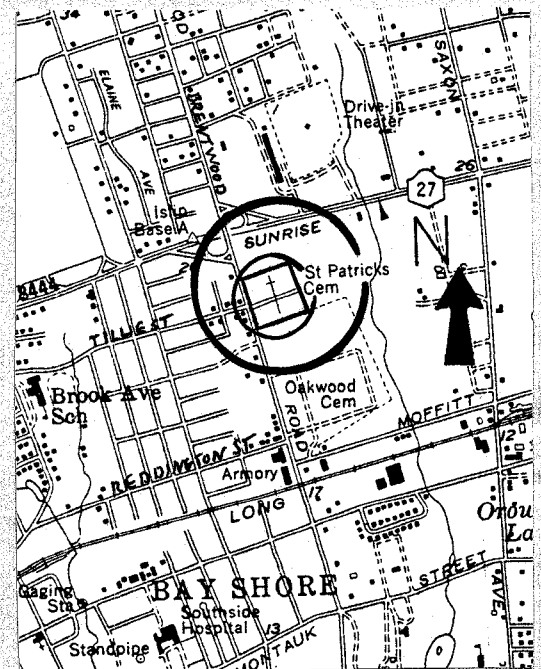

14. THREATS TO BUILDING: a. none known b. zoning c. roads
 d. developers e. deterioration
 f. other: _____
15. RELATED OUTBUILDINGS AND PROPERTY:
 a. barn b. carriage house c. garage
 d. privy e. shed f. greenhouse
 g. shop h. gardens
 i. landscape features: _____
 j. other: chain link fence and masonry gate posts
16. SURROUNDINGS OF THE BUILDING (check more than one if necessary):
 a. open land b. woodland
 c. scattered buildings
 d. densely built-up e. commercial
 f. industrial g. residential
 h. other: another cemetery directly south (BS59)

17. INTERRELATIONSHIP OF BUILDING AND SURROUNDINGS:
 (Indicate if building or structure is in an historic district)

St. Patrick Cemetery is located on the east side of Brentwood Road directly north of the larger Oakwood Cemetery (BS 59) and south of State Highway 27 (Sunrise Highway), a major L.I. east-west thoroughfare recently widened in this area.

18. OTHER NOTABLE FEATURES OF BUILDING AND SITE (including interior features if known):
 St. Patrick Cemetery is a large, sparsely treed burying ground with a single road dividing the parcel approximately in half directly opposite Tillie Street to the west. The cemetery is approximately one third the size of Oakwood Cemetery.

SIGNIFICANCE

19. DATE OF INITIAL CONSTRUCTION: 1884

ARCHITECT: _____

BUILDER: _____

20. HISTORICAL AND ARCHITECTURAL IMPORTANCE:

This cemetery was established in 1884 on Main Street. It is shown on Brentwood Road in 1888.

A new section was opened in 1974. The handsome rusticated stone gate posts and iron gates may predate the move.

21. SOURCES:

Interview, St. Patrick Cemetery office, (516.666.0805), 1/26/1990.
 Wendelken & Co. The Towns of Babylon, Islip, and the South Part of Brookhaven in Suffolk County, N.Y., 1888.

22. THEME:

Research by the Society for the Preservation of Long Island Antiquities - KEK



Neg. KK VI-8, fm. NE. Gate posts on Brentwood Road.

Continuation Sheet
St. Patrick's Cemetery

BS 60

R.D. 4.2

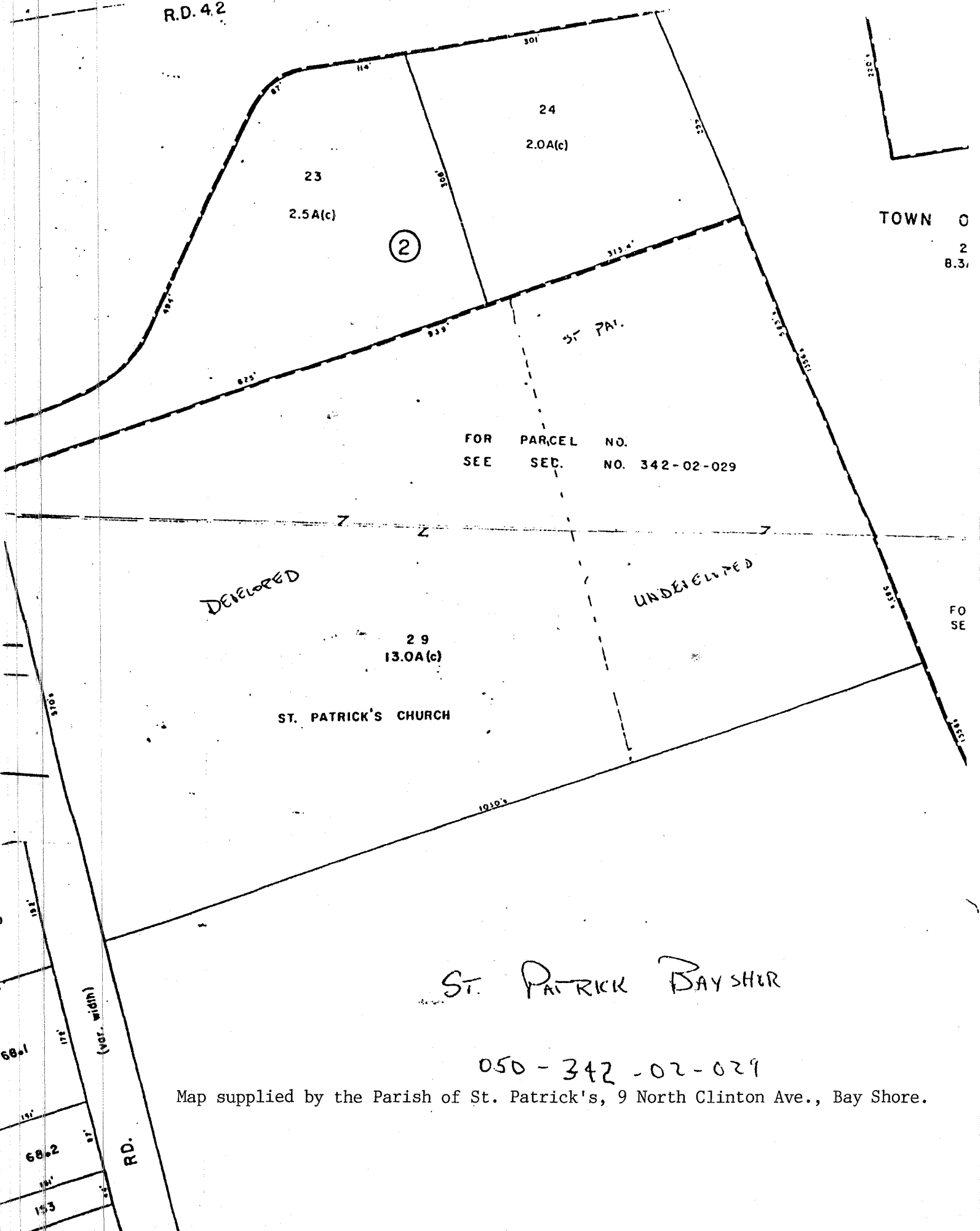

TOWN 0
2
8.37

FOR	PARCEL	NO.
SEE	SEC.	NO. 342-02-029

DEVELOPED

UNDEVELOPED

ST. PATRICK'S CHURCH

ST. PATRICK BAYSHUR

050-342-02-029

Map supplied by the Parish of St. Patrick's, 9 North Clinton Ave., Bay Shore.

RD.

68.1
11' (var. width)
68.2
11'
155