

BUILDING-STRUCTURE INVENTORY FORM

DIVISION FOR HISTORIC PRESERVATION
NEW YORK STATE PARKS AND RECREATION
ALBANY, NEW YORK (518) 474-0479

FOR OFFICE USE ONLY
UNIQUE SITE NO. 103-05-0579-129
QUAD _____
SERIES _____
NEG. NO. _____

Sa 49

green

YOUR NAME: Town of Islip Town Hlaa DATE: 8/13/79
655 Main Street

YOUR ADDRESS: Islip, N.Y. TELEPHONE: (516)224-5450

ORGANIZATION (if any): Department of Planning and Development

IDENTIFICATION

- 1. BUILDING NAME(S): ~~Yarrington House~~ Nettie Crosby House
- 2. COUNTY: Suffolk TOWN/CITY: Islip VILLAGE: Sayville
- 3. STREET LOCATION: 221 Middle Rd
- 4. OWNERSHIP: a. public b. private
- 5. PRESENT OWNER: _____ ADDRESS: _____
- 6. USE: Original: residence Present: residence
- 7. ACCESSIBILITY TO PUBLIC: Exterior visible from public road: Yes No
Interior accessible: Explain _____

DESCRIPTION

- 8. BUILDING MATERIAL: a. clapboard b. stone c. brick d. board and batten
e. cobblestone f. shingles g. stucco other: _____
- 9. STRUCTURAL SYSTEM: (if known) a. wood frame with interlocking joints
b. wood frame with light members
c. masonry load bearing walls
d. metal (explain) _____
e. other _____
- 10. CONDITION: a. excellent b. good c. fair d. deteriorated
- 11. INTEGRITY: a. original site b. moved if so, when? _____
c. list major alterations and dates (if known): _____

12. PHOTO: NJM-6, neg. 18a

13. MAP: Bowe-Anderson

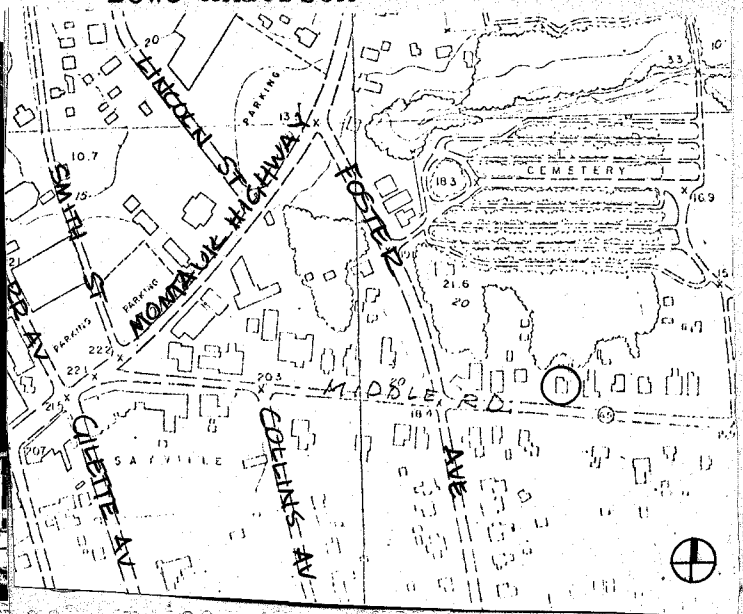

HP-1 front (south) facade

14. THREATS TO BUILDING: a. none known b. zoning c. roads
 d. developers e. deterioration
 f. other: _____
15. RELATED OUTBUILDINGS AND PROPERTY:
 a. barn b. carriage house c. garage
 d. privy e. shed f. greenhouse
 g. shop h. gardens
 i. landscape features: picket fence surrounds land
 j. other: _____
16. SURROUNDINGS OF THE BUILDING (check more than one if necessary):
 a. open land b. woodland
 c. scattered buildings
 d. densely built-up e. commercial
 f. industrial g. residential
 h. other: _____

17. INTERRELATIONSHIP OF BUILDING AND SURROUNDINGS:
 (Indicate if building or structure is in an historic district)

The Yarrington House is on the north side of Middle Road, between Foster Avenue and St. Ann's Church,

18. OTHER NOTABLE FEATURES OF BUILDING AND SITE (including interior features if known):

1½ story, pilastered gable roofed, late Greek Revival House with 3 bay 1st floor and 1 bay 2nd floor with 1 story 3 bay wing to the east. Centered entrance crosseted surround, high roof plate with freize windows on west facade, porch with turned posts and sawn spandrels, picket fence with top rail surrounds property.

SIGNIFICANCE

19. DATE OF INITIAL CONSTRUCTION: ca. 1810

ARCHITECT: _____

BUILDER: _____

20. HISTORICAL AND ARCHITECTURAL IMPORTANCE:

The Yarrington residence is the former home of one of the Pioneer settlers of Sayville. It survives today, still resplendent in its early 19th century spirit, and is a Designated Town Landmark. Mrs. Ruth Dougherty of the Sayville Historical Society reports that this is known as the Nettie Crosby house.

21. SOURCES:

J. Chace Jr. Map of Suffolk County, Long Islnad, New York, Philadelphia, 1858.

22. THEME:

Prepared By: Society for the Preservation of Long Island Antiquities
 Setauket, New York 11733
 Nina Monastero, Research Assistant
 August, 1979