

BUILDING-STRUCTURE INVENTORY FORM

FOR OFFICE USE ONLY

SY 10

DIVISION FOR HISTORIC PRESERVATION
 NEW YORK STATE PARKS AND RECREATION
 ALBANY, NEW YORK (518) 474-0479

UNIQUE SITE NO. 10305.000855
 QUAD _____
 SERIES _____
 NEG. NO. _____

YOUR NAME: Town of Islip/SPLIA DATE: May 1990
Town Hall, 655 Main St.
 YOUR ADDRESS: Islip, L.I., N.Y. 11751 TELEPHONE: 516.224.5450
 ORGANIZATION (if any): Dept. of Planning, Housing, and Development

IDENTIFICATION

1. BUILDING NAME(S): 1 1/2 story House
 2. COUNTY: Suffolk TOWN/CITY: Islip VILLAGE: Sayville
 3. STREET LOCATION: 275 Lincoln Ave.
 4. OWNERSHIP: a. public b. private
 5. PRESENT OWNER: _____ ADDRESS: _____
 6. USE: Original: residence Present: residence
 7. ACCESSIBILITY TO PUBLIC: Exterior visible from public road: Yes No
 Interior accessible: Explain private residence

DESCRIPTION

8. BUILDING MATERIAL: a. clapboard b. stone c. brick d. board and batten
 e. cobblestone f. shingles g. stucco other: modern siding
 9. STRUCTURAL SYSTEM: a. wood frame with interlocking joints
 (if known) b. wood frame with light members ? needs framing inspection
 c. masonry load bearing walls
 d. metal (explain) _____
 e. other _____
 10. CONDITION: a. excellent b. good c. fair d. deteriorated
 11. INTEGRITY: a. original site b. moved if so, when? _____
 c. list major alterations and dates (if known):

modern siding added

12. PHOTO: Neg. KK XXIV-2, fm. NW

13. MAP: NYS DOT composite Patchogue/Sayville Quads

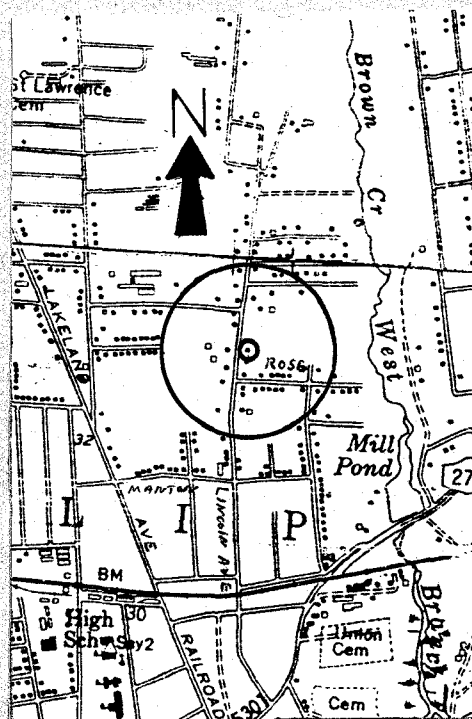

14. THREATS TO BUILDING: a. none known b. zoning c. roads
 d. developers e. deterioration
 f. other: _____
15. RELATED OUTBUILDINGS AND PROPERTY:
 a. barn b. carriage house c. garage
 d. privy e. shed f. greenhouse
 g. shop h. gardens
 i. landscape features: tall conifers
 j. other: _____
16. SURROUNDINGS OF THE BUILDING (check more than one if necessary):
 a. open land b. woodland
 c. scattered buildings
 d. densely built-up e. commercial
 f. industrial g. residential
 h. other: _____

17. INTERRELATIONSHIP OF BUILDING AND SURROUNDINGS:
 (Indicate if building or structure is in an historic district)

275 Lincoln Avenue is located on the east side of the street among residences of similar and later date. Several examples of this type stand in the vicinity.

18. OTHER NOTABLE FEATURES OF BUILDING AND SITE (including interior features if known):

275 Lincoln Avenue is a 1½ story, three bay, center entrance plan, gable roof house with a shed roof extension on the rear (east). The upper story contains two large under-eave windows on the main (west) facade. A gable roof porch with scalloped infill covers the entrance.

SIGNIFICANCE

19. DATE OF INITIAL CONSTRUCTION: Mid 19th century

ARCHITECT: _____

BUILDER: _____

20. HISTORICAL AND ARCHITECTURAL IMPORTANCE:

275 Lincoln Avenue is a house type that would generally be considered to date from the mid 19th century. Further inspection and research is needed to determine the exact date.

21. SOURCES:

E. Belcher Hyde. Atlas of the Ocean Shore of Suffolk County, L.I. (westerly section), 1902.

22. THEME:
 Research by Society for the Preservation of Long Island Antiquities - KEK