

**BUILDING-STRUCTURE INVENTORY FORM**

DIVISION FOR HISTORIC PRESERVATION  
 NEW YORK STATE PARKS AND RECREATION  
 ALBANY, NEW YORK (518) 474-0479

FOR OFFICE USE ONLY  
 UNIQUE SITE NO. 10305.00086/  
 QUAD \_\_\_\_\_  
 SERIES \_\_\_\_\_  
 NEG. NO. \_\_\_\_\_

SY 15

YOUR NAME: Town of Islip/SPLIA DATE: May 1990  
Town Hall, 655 Main St.  
 YOUR ADDRESS: Islip, L.I., N.Y. 11751 TELEPHONE: 516.224.5450  
 ORGANIZATION (if any): Dept. of Planning, Housing, and Development

\*\*\*\*\*

**IDENTIFICATION**

1. BUILDING NAME(S): Pausewang House/ Braywood Adult Home
2. COUNTY: Suffolk TOWN/CITY: Islip VILLAGE: Sayville
3. STREET LOCATION: 121 Lakeland Ave.
4. OWNERSHIP: a. public  b. private
5. PRESENT OWNER: B. Rayson ADDRESS: \_\_\_\_\_
6. USE: Original: residence Present: adult home
7. ACCESSIBILITY TO PUBLIC: Exterior visible from public road: Yes  No   
 Interior accessible: Explain partial, by app't.

**DESCRIPTION**

8. BUILDING MATERIAL: a. clapboard  b. stone  c. brick  d. board and batten   
 e. cobblestone  f. shingles  g. stucco  other: modern cladding
9. STRUCTURAL SYSTEM: a. wood frame with interlocking joints   
 b. wood frame with light members   
 c. masonry load bearing walls   
 d. metal (explain) \_\_\_\_\_  
 e. other \_\_\_\_\_
10. CONDITION: a. excellent  b. good  c. fair  d. deteriorated
11. INTEGRITY: a. original site  b. moved  if so, when? \_\_\_\_\_  
 c. list major alterations and dates (if known):

modern cladding added to portions of building  
north wing added  
porch enclosed

12. PHOTO:

13. MAP:

Neg. KK XXIII-18, fm. SW

NYS DOT composite Sayville and Patchogue Quads

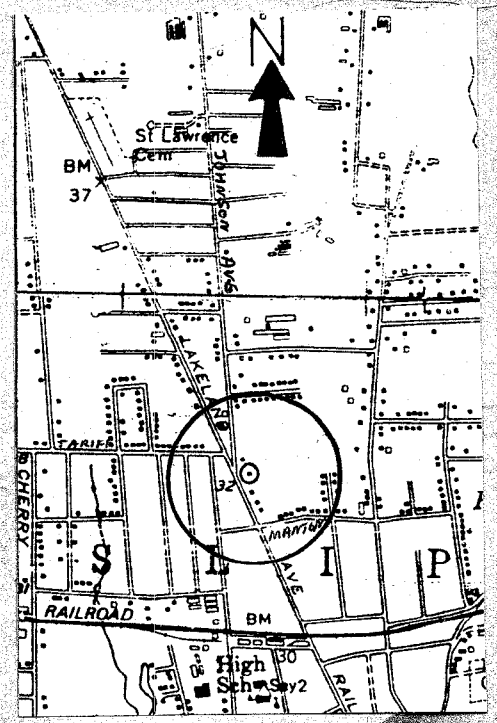

14. THREATS TO BUILDING: a. none known  b. zoning  c. roads   
 d. developers  e. deterioration   
 f. other: \_\_\_\_\_
15. RELATED OUTBUILDINGS AND PROPERTY: -refer to continuation sheet-  
 a. barn  b. carriage house  c. garage   
 d. privy  e. shed  f. greenhouse   
 g. shop  h. gardens   
 i. landscape features: \_\_\_\_\_  
 j. other: small cottage
16. SURROUNDINGS OF THE BUILDING (check more than one if necessary):  
 a. open land  b. woodland   
 c. scattered buildings   
 d. densely built-up  e. commercial  light  
 f. industrial  g. residential   
 h. other: \_\_\_\_\_

17. INTERRELATIONSHIP OF BUILDING AND SURROUNDINGS:  
 (Indicate if building or structure is in an historic district)  
 121 Lakeland Avenue is located on the east side of the street in a predominantly residential community characterized by houses that range from the mid 19th century to the mid 20th century. This example is the largest in the immediate vicinity, and the most architecturally prominent.

18. OTHER NOTABLE FEATURES OF BUILDING AND SITE (including interior features if known):  
 121 Lakeland Avenue is a large, 2½ story, irregularly shaped, high hip roof, Queen Anne style house with a prominent SW corner tower that features a conical roof and curved window bands. The house retains facade gables delineated with heavy timber brackets that bow over two story, semi-hexagonal bay windows on the west and south facades.

**SIGNIFICANCE**

19. DATE OF INITIAL CONSTRUCTION: Late 19th century
- ARCHITECT: \_\_\_\_\_
- BUILDER: \_\_\_\_\_

20. HISTORICAL AND ARCHITECTURAL IMPORTANCE:  
 121 Lakeland Avenue was owned by William Pausewang in 1902. This important landmark is a fine example of an adaptive re-use. That the handsome carriage house has survived and retains its intergrity is also important.

21. SOURCES:  
Suffolk County News, 6/9/1983, p. 14.  
E. Belcher Hyde. Atlas of the Ocean Shore of Suffolk County, L.I. (westerly section), 1902.
22. THEME:  
 Research by Society for the Preservation of Long Island Antiquities - KEK

Continuation Sheet  
Brayson Adult Home



Neg. KK XXIII-16, fm. SW. View of carriage house with large semi-circular windows in the gable peaks and recessed pediment on principle (west) facade.

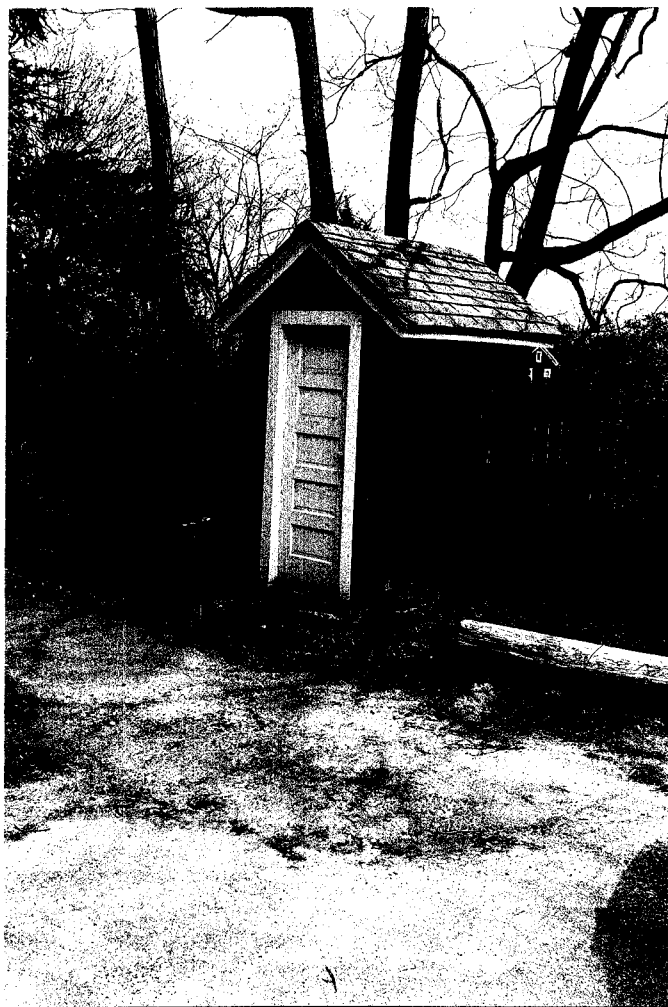

Neg. KK XXIII-17, fm. NW. Privy.