

BUILDING-STRUCTURE INVENTORY FORM

DIVISION FOR HISTORIC PRESERVATION
NEW YORK STATE PARKS AND RECREATION
ALBANY, NEW YORK (518) 474-0479.

FOR OFFICE USE ONLY	
UNIQUE SITE NO.	<u>103-05-0300-D21</u>
QUAD	_____
SERIES	_____
NEG. NO.	_____

Oa 20
green

YOUR NAME: Town of Islip Town Hall DATE: 5/22/79
655 Main Street
 YOUR ADDRESS: Islip, N.Y. TELEPHONE: (516) 224-5450
 ORGANIZATION (if any): Department of Planning and Development

IDENTIFICATION

1. BUILDING NAME(S): Vanderbilt ^{Estate's} Piggery (the Artist Colony) #2
 2. COUNTY: Suffolk TOWN/CITY: Islip VILLAGE: Oakdale
 3. STREET LOCATION: Princess Gate, South Side; at Tower News
 4. OWNERSHIP: a. public b. private
 5. PRESENT OWNER: Anderson Herth ADDRESS: see #3
 6. USE: Original: Pig stalls Present: Residence
 7. ACCESSIBILITY TO PUBLIC: Exterior visible from public road: Yes No
 Interior accessible: Explain _____

DESCRIPTION

8. BUILDING MATERIAL: a. clapboard b. stone c. brick d. board and batten
 e. cobblestone f. shingles g. stucco other: _____
 9. STRUCTURAL SYSTEM: a. wood frame with interlocking joints
 (if known) b. wood frame with light members
 c. masonry load bearing walls
 d. metal (explain) _____
 e. other _____
 10. CONDITION: a. excellent b. good c. fair d. deteriorated
 11. INTEGRITY: a. original site b. moved if so, when? _____
 c. list major alterations and dates (if known): _____

12. PHOTO: Neg. 25, south facade
NJM-1

13. MAP: Bowe-Anderson
Composite

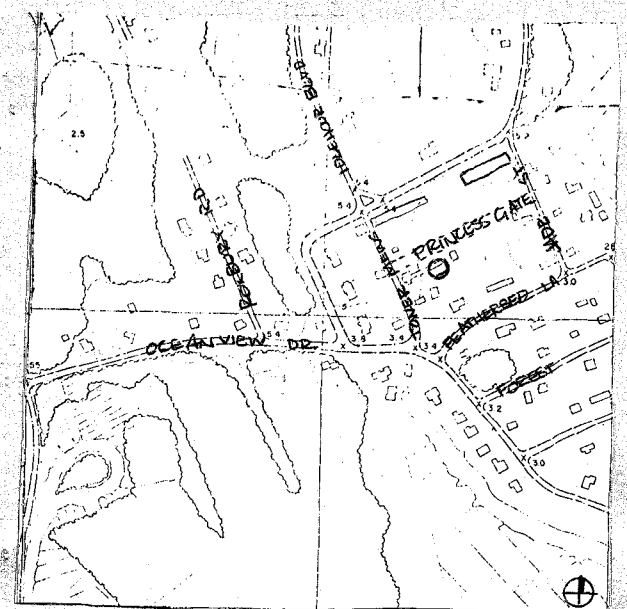

14. THREATS TO BUILDING: a. none known b. zoning c. roads
d. developers e. deterioration
f. other: _____
15. RELATED OUTBUILDINGS AND PROPERTY:
a. barn b. carriage house c. garage
d. privy e. shed f. greenhouse
g. shop h. gardens
i. landscape features: _____
j. other: _____
16. SURROUNDINGS OF THE BUILDING (check more than one if necessary):
a. open land b. woodland
c. scattered buildings
d. densely built-up e. commercial
f. industrial g. residential
h. other: similar buildings of farm complex

17. INTERRELATIONSHIP OF BUILDING AND SURROUNDINGS:
(Indicate if building or structure is in an historic district)
On the East side of Princess Gate, attached to other homes
that used to be pig stalls, in the historic Artist Colony.

18. OTHER NOTABLE FEATURES OF BUILDING AND SITE (including interior features if known):
1 story brick structure with gable roof that is unaltered.
Original hinged windows survive in segmental window and
door openings.

SIGNIFICANCE

19. DATE OF INITIAL CONSTRUCTION: 1890

ARCHITECT: _____

BUILDER: William Bason and Sons

20. HISTORICAL AND ARCHITECTURAL IMPORTANCE:
This building was part of the farm area of the Vanderbilt
Estate. In 1926, this area was purchased by Lucy Sawyer
Pritchard Thompson and her son, William, turning it into
the Artist Colony, a haven for many New York City Artists.

21. SOURCES: Linda Williams, "Idle Hour Residents Waltz to a
Reprise of Artist's Life," Newsday, October 9, 1969.

22. THEME:
Prepared by: Society for the Preservation of Long Island Antiquities
Setauket, N. Y. 11733
Nina Monastero, Research Assistant
May, 1979