

BUILDING-STRUCTURE INVENTORY FORM

DIVISION FOR HISTORIC PRESERVATION
NEW YORK STATE PARKS AND RECREATION
ALBANY, NEW YORK (518) 474-0479

FOR OFFICE USE ONLY

UNIQUE SITE NO. 103-05-0317-021
QUAD _____
SERIES _____
NEG. NO. _____

Oa 33

green

yellow

YOUR NAME: Town of Islip Town Hall DATE: 5/23/79

655 Main Street
YOUR ADDRESS: Islip, N.Y. TELEPHONE: (516) 224-5450

ORGANIZATION (if any): Department of Planning and Development

IDENTIFICATION

- 1. BUILDING NAME(S): Vanderbilt ^{Black} Blacksmith Shop (The Artist Colony)
- 2. COUNTY: Suffolk TOWN/CITY: Islip VILLAGE: Oakdale
- 3. STREET LOCATION: 31 Jade Street
- 4. OWNERSHIP: a. public b. private
- 5. PRESENT OWNER: Iocca ADDRESS: Shore Drive, Oakdale
- 6. USE: Original: Blacksmith Shop Present: residence
- 7. ACCESSIBILITY TO PUBLIC: Exterior visible from public road: Yes No
Interior accessible: Explain _____

DESCRIPTION

- 8. BUILDING MATERIAL: a. clapboard b. stone c. brick d. board and batten
e. cobblestone f. shingles g. stucco other: _____
- 9. STRUCTURAL SYSTEM: (if known) a. wood frame with interlocking joints
b. wood frame with light members
c. masonry load bearing walls
d. metal (explain) _____
e. other _____
- 10. CONDITION: a. excellent b. good c. fair d. deteriorated
- 11. INTEGRITY: a. original site b. moved if so, when? _____
c. list major alterations and dates (if known):
infill to original brick piers

12. PHOTO: ELW IX #10, from W., front 13. MAP: Bowe-Anderson Composite

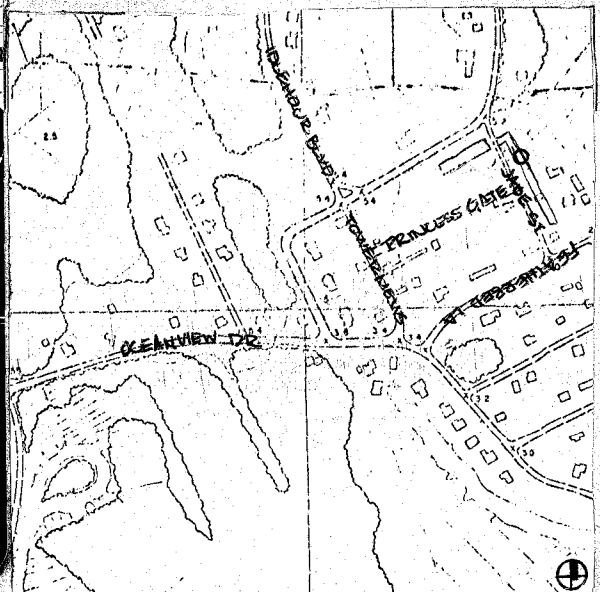

14. THREATS TO BUILDING: a. none known b. zoning c. roads
 d. developers e. deterioration
 f. other: _____
15. RELATED OUTBUILDINGS AND PROPERTY:
 a. barn b. carriage house c. garage
 d. privy e. shed f. greenhouse
 g. shop h. gardens
 i. landscape features: _____
 j. other: _____
16. SURROUNDINGS OF THE BUILDING (check more than one if necessary):
 a. open land b. woodland
 c. scattered buildings
 d. densely built-up e. commercial
 f. industrial g. residential
 h. other: attached to Oa 32

17. INTERRELATIONSHIP OF BUILDING AND SURROUNDINGS:
 (Indicate if building or structure is in an historic district)

One portion of a row of individually owned units on the east side of Jade Street, in the historic Artist Colony.

18. OTHER NOTABLE FEATURES OF BUILDING AND SITE (including interior features if known):

Brick piers with infill and gable roof.

SIGNIFICANCE

19. DATE OF INITIAL CONSTRUCTION: 1890

ARCHITECT: _____

BUILDER: William Bason and Sons

20. HISTORICAL AND ARCHITECTURAL IMPORTANCE:

See Oa 17

Brick segmental arched window and door.

21. SOURCES:

Charles P. Dickerson, A History of the Sayville Community,
 Suffolk County News, 1975.

22. THEME:

Prepared by: Society for the Preservation of Long Island Antiquities
 Setauket, New York 11733
 Nina Momastero, Research Assistant
 May, 1979