

**BUILDING-STRUCTURE INVENTORY FORM**

DIVISION FOR HISTORIC PRESERVATION  
NEW YORK STATE PARKS AND RECREATION  
ALBANY, NEW YORK (518) 474-0479

FOR OFFICE USE ONLY  
UNIQUE SITE NO. 103-05-0311-021  
QUAD \_\_\_\_\_  
SERIES \_\_\_\_\_  
NEG. NO. \_\_\_\_\_

Oa 28  
  
green  
  
yellow

YOUR NAME: Town of Islip Town Hall DATE: 5/23/79  
655 Main Street  
YOUR ADDRESS: Islip, N.Y. TELEPHONE: (516) 224-5450  
ORGANIZATION (if any): Department of Planning and Development

\*\*\*\*\*  
**IDENTIFICATION**

1. BUILDING NAME(S): Vanderbilt Piggery (The Artist Colony)  
2. COUNTY: Suffolk TOWN/CITY: Islip VILLAGE: Oakdale  
3. STREET LOCATION: 31 Featherbed Lane  
4. OWNERSHIP: a. public  b. private   
5. PRESENT OWNER: \_\_\_\_\_ ADDRESS: \_\_\_\_\_  
6. USE: Original: Pig stalls Present: residence  
7. ACCESSIBILITY TO PUBLIC: Exterior visible from public road: Yes  No   
Interior accessible: Explain \_\_\_\_\_

**DESCRIPTION**

8. BUILDING MATERIAL: a. clapboard  b. stone  c. brick  d. board and batten   
e. cobblestone  f. shingles  g. stucco  other: \_\_\_\_\_  
9. STRUCTURAL SYSTEM: (if known) a. wood frame with interlocking joints   
b. wood frame with light members   
c. masonry load bearing walls   
d. metal (explain) \_\_\_\_\_  
e. other \_\_\_\_\_  
10. CONDITION: a. excellent  b. good  c. fair  d. deteriorated   
11. INTEGRITY: a. original site  b. moved  if so, when? \_\_\_\_\_  
c. list major alterations and dates (if known): \_\_\_\_\_

second story addition

12. PHOTO: ELW IX, #9, from S., front 13. MAP: Bowe-Anderson Composite



HP-1

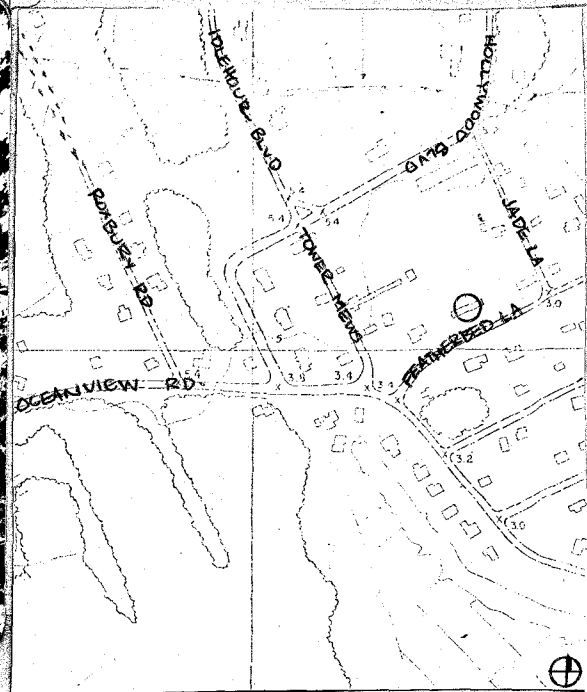

14. THREATS TO BUILDING: a. none known  b. zoning  c. roads   
 d. developers  e. deterioration   
 f. other: \_\_\_\_\_
15. RELATED OUTBUILDINGS AND PROPERTY:  
 a. barn  b. carriage house  c. garage   
 d. privy  e. shed  f. greenhouse   
 g. shop  h. gardens   
 i. landscape features: \_\_\_\_\_  
 j. other: \_\_\_\_\_
16. SURROUNDINGS OF THE BUILDING (check more than one if necessary):  
 a. open land  b. woodland   
 c. scattered buildings   
 d. densely built-up  e. commercial   
 f. industrial  g. residential   
 h. other: similar buildings in farm complex
17. INTERRELATIONSHIP OF BUILDING AND SURROUNDINGS:  
 (Indicate if building or structure is in an historic district)

On north side of Featherbed Lane, a subdivision of the originally continuous chicken coop, in the historic Artist Colony.

18. OTHER NOTABLE FEATURES OF BUILDING AND SITE (including interior features if known):

1 story brick structure with gable roof. Segmented arches at window and door opening.

**SIGNIFICANCE**

19. DATE OF INITIAL CONSTRUCTION: 1890

ARCHITECT: \_\_\_\_\_

BUILDER: William Bason and Sons

20. HISTORICAL AND ARCHITECTURAL IMPORTANCE:

This building was part of the farm area of the Vanderbilt estate. In 1926, this area was purchased by Lucy Sawyer Pritchard Thompson and her son, William, turning it into the Artist Colony, a haven for many New York City Artists.

21. SOURCES:

Charles P. Dickerson, A History of the Sayville Community, Suffolk County News, 1975.

22. THEME:

Prepared by: Society for the Preservation of Long Island Antiquities  
 Setauket, New York  
 Nina Monastero, Research Assistant  
 May, 1979