

463-01-0025⁰⁰³ P/O ✓ . IV - 11
423-01-019 ✓

BUILDING-STRUCTURE INVENTORY FORM

DIVISION FOR HISTORIC PRESERVATION
NEW YORK STATE PARKS AND RECREATION
ALBANY, NEW YORK (518) 474-0479

FOR OFFICE USE ONLY	
UNIQUE SITE NO.	_____
QUAD	_____
SERIES	_____
NEG. NO.	_____

YOUR NAME: Town of Islip DATE: 5 Jan. 1977
Town Hall
 YOUR ADDRESS: 655 Main Street TELEPHONE: 516-581-2000
Islip, L.I., N.Y. 11751
 ORGANIZATION (if any): Department of Planning, Housing and Development

IDENTIFICATION

1. BUILDING NAME(S): Charles D. Webster Estate, "Twvford"
 2. COUNTY: Suffolk TOWN/CITY: Islip VILLAGE: Islip
 3. STREET LOCATION: St. Marks Lane
 4. OWNERSHIP: a. public b. private
 5. PRESENT OWNER: Mrs. Charles Webster ADDRESS: St. Mark's Lane
 6. USE: Original: residence Present: residence
 7. ACCESSIBILITY TO PUBLIC: Exterior visible from public road: Yes No
 Interior accessible: Explain permission of owner

DESCRIPTION

8. BUILDING MATERIAL: a. clapboard b. stone c. brick d. board and batten
 e. cobblestone f. shingles g. stucco other: _____
 9. STRUCTURAL SYSTEM: a. wood frame with interlocking joints
 (if known) b. wood frame with light members
 c. masonry load bearing walls
 d. metal (explain) _____
 e. other _____
 10. CONDITION: a. excellent b. good c. fair d. deteriorated
 11. INTEGRITY: a. original site b. moved if so, when? _____
 c. list major alterations and dates (if known):
remodeled recently

NEGATIVES DEPOSITED AT
SOCIETY FOR PRESERVATION OF
L.I. ANTIQUITIES

12. PHOTO: BVL 1-10 (neg, roll)



HP-1

13. MAP: N.Y. State D.O.T. map

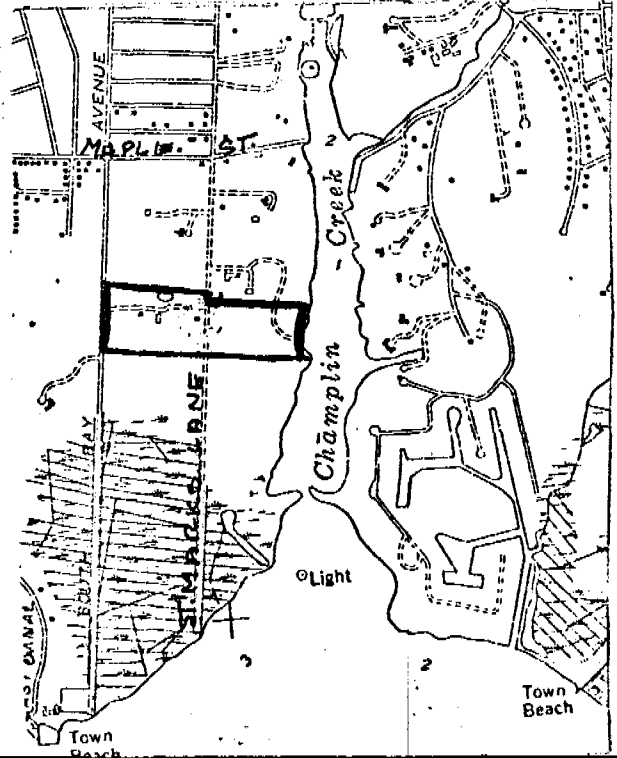

14. THREATS TO BUILDING: a. none known b. zoning c. roads
 d. developers e. deterioration
 f. other: _____
15. RELATED OUTBUILDINGS AND PROPERTY:
 a. barn b. carriage house c. garage
 d. privy e. shed f. greenhouse
 g. shop h. gardens
 i. landscape features: duck ponds, sheep shed
 j. other: gazebo
16. SURROUNDINGS OF THE BUILDING (check more than one if necessary):
 a. open land b. woodland
 c. scattered buildings
 d. densely built-up e. commercial
 f. industrial g. residential
 h. other: _____

17. INTERRELATIONSHIP OF BUILDING AND SURROUNDINGS:
 (Indicate if building or structure is in an historic district)
 The Webster House is located in open fields overlooking Great South Bay. A large acreage.

18. OTHER NOTABLE FEATURES OF BUILDING AND SITE (including interior features if known):
 Stucco house with quoins and fanlight window above main portal, has recent remodeling.

SIGNIFICANCE

19. DATE OF INITIAL CONSTRUCTION: _____
 ARCHITECT: _____
 BUILDER: _____

20. HISTORICAL AND ARCHITECTURAL IMPORTANCE:
 Mrs. Webster is daughter of Harry T. Peters and first cousin of Mrs. Scully of South Bay Avenue. (see IV-10) HARRY PETERS OWNED THE ENTIRE TRACT. SEE IV-12.

21. SOURCES:

22. THEME:
 Research by: Society for the Preservation of Long Island Antiquities
 Marilyn Sachs, Research Assistant

T W Y F O R D

Twyford, the home of Mr. and Mrs. Charles D. Webster, is at Islip, Long Island, New York. Mr. and Mrs. Webster share their horticultural interest, and are active in horticultural and gardening circles of the United States. Mrs. Webster served as President of the Garden Club of America from 1959 to 1962, and Mr. Webster has been President of The Horticultural Society of New York from 1957 to the present date.

Twyford is located approximately fifty miles from New York City on the south shore of Long Island. Its situation is in an area once composed of brackish salt water creeks, marshland interspersed with native stands of Pinus rigida, Pepperidge (Nyassa Sylvatica), Bayberry, Clethra alnifolia, Viburnum dentatum, all of which grow along the borders of an area containing Norway Spruce, White Oak, Sassafras and common Wild Cherry, Prunus Virginiana (serotina).

The formal gardening area is contained in a picket garden, consisting of a grassed oval, outlined with Yew (Taxus cuspidata nana) enclosing beds of dwarf conifers and broadleaved evergreens. There is a central perennial bed, rose beds and low borders of late-blooming Candytuft (Iberis 'Snow Flake'), a cutting and working garden, as well as a knot garden adapted from the Brooklyn Botanic Garden's pattern, and a newly installed small parterre, and a planting of succulents. An octagonal lathhouse gazebo dominates the area.

Outside the picketed "cottage style" garden are border plantings. About the house are formal plantings of broadleaved evergreens, a terrace and lawn with a view of the Great South Bay to the south and full exposure to the north to an open field, a pond for a waterfowl collection of ducks, geese and swan, and a barn and farmyard for chickens, dogs and other pets.

Plant collections include English and native American Holly, Cotoneaster, Stewartias and Viburnums.

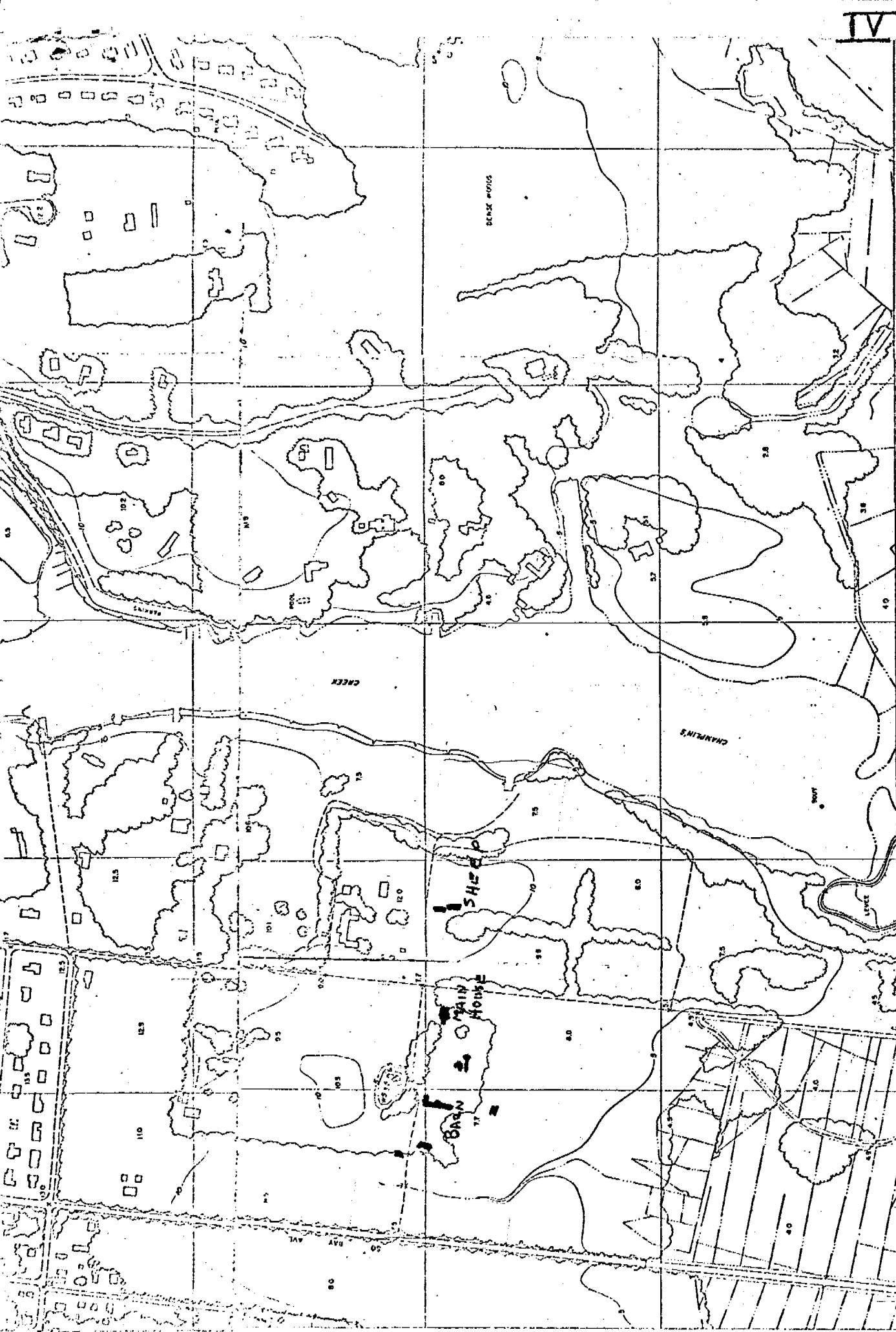

BOARD OF SUPERVISORS, SUFFOLK COUNTY, N.Y.
 EVANS K. GRIFFING, CHAIRMAN
 WILLIAM T. LAUCER STEPHEN F. MESCHUTT JOHN V. KLEIN
 LESTER M. ALBERTSON CHARLES R. DOMINY WILLIAM J. LEONARD
 ROBERT J. FLYNN EDWARD V. ECKER WILLIAM P. HAIR
 THOMAS J. HARMWOOD ROBERT VOJVODA RALPH J. OSGOOD
 H. LEE DENNISON, COUNTY EXECUTIVE # 1985

THIS MAP FINANCED BY A GRANT FROM
 STATE OF NEW YORK, PURSUANT TO
 ARTICLE SECTION 80-30 PUBLIC HEALTH LAW

COMPILED BY
 FALCON AIRWAYS
 A DIVISION OF
 THE BEN W. WHITE COMPANY
 1807 MARION ST. DENVER, COLORADO

SCALE 1"=200'
 0 100 200 300 400 500 FEET

CONTOUR INTERVALS

NEW YORK STATE PLAIN TERNATE SYSTEM
 LONG ISLAND ZONE
 DATUMS WITH STR. DAT. AS ESTABLISHED BY
 THE U.S. COAST AND GEOD. SURVEY

0.0	0.5	1.0	1.5	2.0
0.0	0.5	1.0	1.5	2.0
0.0	0.5	1.0	1.5	2.0
0.0	0.5	1.0	1.5	2.0
0.0	0.5	1.0	1.5	2.0

KEY

IV

Botanical Name	Common Name	Circumference — Ft. In.				Location
		1952	1962	1972	Taken at	
<i>Parrotia persica</i>	Persian Parrotia	7' 1"	7' 2"	8' 8"	0' 6"	Flushing; Kissena Park
<i>Parrotia sinensis</i>	Chinese Parrotia	N.R.	N.R.	8' 7"	0' 6"	Brooklyn; Botanic Garden
<i>Paulownia tomentosa</i>	Royal Paulownia	12' 5"	13' 5"	14' 4"	4' 6"	Brooklyn; Prospect Park
<i>Phellodendron amurense</i>	Amur Corktree	6' 6"	7' 3"	4' 6"		Lattingtown; Bailey Arboretum
<i>Phellodendron chinense</i>	Chinese Corktree	4' 0"	5' 3"	5' 10"	2' 6"	Brooklyn; Botanic Garden
<i>Phellodendron japonicum</i>	Japanese Corktree	5' 4"	7' 0"	8' 3"	2' 6"	Brooklyn; Botanic Garden
<i>Phellodendron lavallei</i>	Lavalle Corktree	N.R.	9' 0"	9' 4"	4' 6"	Brooklyn; Saratoga Park
<i>Phellodendron sachalinense</i>	Sakhalin Corktree	N.R.	N.R.	0' 7"	4' 6"	Brooklyn; Botanic Garden
<i>Photinia villosa</i>	Oriental Photinia	1' 1"	1' 3"	1' 5"	3' 0"	Upper Brookville; Planting Fields Arboretum
<i>Photinia villosa maximowicziana</i>	Veinleaf Oriental Photinia	N.R.	N.R.	2' 7"	0' 0"	Brooklyn; Botanic Garden
<i>Picea abies</i>	Norway Spruce	N.R.	9' 11"	10' 6"	4' 6"	Islip; St. Marks La., C. D. Webster
<i>Picea abies aurea</i>	Golden Norway Spruce	3' 9"	4' 1"	4' 3"	4' 6"	Roslyn; W. C. Bryant Park & Preserve
<i>Picea abies conica</i>	Arrowhead Norway Spruce	N.R.	N.R.	1' 4"	4' 6"	Kings Point; H. Brickman Estate
<i>Picea abies inversa</i>	Drooping Norway Spruce	N.R.	N.R.	1' 9"	4' 6"	Old Westbury; Old Westbury Gardens
<i>Picea abies pendula</i>	Weeping Norway Spruce	4' 6"	5' 1"	5' 6"	4' 0"	Roslyn; W. C. Bryant Park & Preserve
<i>Picea abies pumila</i>	Dwarf Norway Spruce	N.R.	N.R.	0' 5"	4' 6"	Old Westbury; Old Westbury Gardens
<i>Picea abies virgata</i>	Cranston Norway Spruce	N.R.	N.R.	3' 1"	4' 6"	Muttontown; Muttontown Preserve
<i>Picea bicolor</i>	Alcock Spruce	N.R.	7' 2"	8' 3"	4' 6"	Great River; Bayard Cutting Arboretum
<i>Picea glauca</i>	White Spruce	N.R.	2' 11"	Gone	4' 6"	North Hills; I. U. Willets Rd., A. Summers
<i>Picea glauca conica</i>	Arrowhead White Spruce	1' 2"	1' 5"	2' 3"	1' 0"	Roslyn; W. C. Bryant Park & Preserve
<i>Picea glauca pendula</i>	Weeping White Spruce	N.R.	2' 1"	2' 9"	4' 6"	Wading River; former Geo. Hart Estate
<i>Picea jezonensis hondoensis</i>	Hondo Yeddo Spruce	4' 4"	4' 8"	Gone	4' 6"	Great River; Bayard Cutting Arboretum
<i>Picea obovata</i>	Siberian Spruce	N.R.	N.R.	2' 0"	4' 6"	Matinecock; Chicken Val. & Piping Rock Rds.
<i>Picea omorika</i>	Serbian Spruce	N.R.	N.R.	0' 11"	4' 6"	Brooklyn; Botanic Garden
<i>Picea orientalis</i>	Oriental Spruce	4' 4"	5' 2"	6' 5"	4' 6"	Great River; Bayard Cutting Arboretum
<i>Picea polita</i>	Tigertail Spruce	N.R.	N.R.	2' 4"	4' 6"	Muttontown; Muttontown Preserve
<i>Picea pungens</i>	Colorado Spruce	N.R.	N.R.	7' 1"	4' 6"	Upper Brookville; 44 Wolver Hollow Road
<i>Picea pungens kosteriana</i>	Koster Colorado Spruce	N.R.	N.R.	1' 0"	4' 6"	Kings Point; H. Brickman Estate
<i>Picea pungens pendula</i>	Weeping Colorado Spruce	N.R.	N.R.	2' 2"	4' 6"	Muttontown; Muttontown Preserve
<i>Picea rubens</i>	Red Spruce	N.R.	N.R.	4' 4"	4' 6"	Jericho; Jericho Tpke. & Kirby Lane

THE TREES OF LONG ISLAND

<i>Picea wilsoni</i>	Wilson Spruce	N.R.	N.R.	1' 8"	4' 6"	Brooklyn; Botanic Garden
<i>Picrasma quassloides</i>	India Quassia-wood	3' 0"	3' 9"	4' 3"	3' 0"	Brooklyn; Botanic Garden
<i>Pinus banksiana</i>	Jack Pine	1' 7"	2' 5"	2' 8"	4' 6"	Roslyn; W. C. Bryant Park & Preserve
<i>Pinus bungeana</i>	Lacebark Pine	4' 4"	4' 2"	5' 2"	0' 0"	Brooklyn; Botanic Garden
<i>Pinus cembra</i>	Swiss Stone Pine	N.R.	N.R.	3' 11"	0' 2"	Upper Brookville; Planting Fields Arboretum
<i>Pinus cembra</i>	Swiss Stone Pine	2' 11"	3' 5"	3' 9"	4' 6"	Great River; Bayard Cutting Arboretum
<i>Pinus contorta latifolia</i>	Lodgepole Pine	N.R.	N.R.	0' 8"	4' 6"	North Hills; I. U. Willets Rd., A. Summers
<i>Pinus densiflora</i>	Japanese Red Pine	N.R.	8' 0"	9' 10"	3' 0"	Great River; Bayard Cutting Arboretum
<i>Pinus densiflora umbraculifera</i>	Umbrella Pine	N.R.	N.R.	2' 2"	4' 6"	Kings Point; H. Brickman Estate
<i>Pinus echinata</i>	Shortleaf Pine	N.R.	N.R.	1' 4"	4' 6"	North Hills; I. U. Willets Rd., A. Summers
<i>Pinus flexilis</i>	Limber Pine	N.R.	N.R.	3' 4"	4' 6"	Kings Point; H. Brickman Estate
<i>Pinus griffithii</i>	Himalayan Pine	N.R.	8' 4"	9' 3"	4' 6"	Mill Neck; Horseshoe Rd., C. J. Reid
<i>Pinus jeffreyi</i>	Jeffrey Pine	N.R.	N.R.	0' 9"	4' 6"	North Hills; I. U. Willets Rd., A. Summers
<i>Pinus koraiensis</i>	Korean Pine	N.R.	5' 0"	5' 4"	4' 6"	Lattingtown; Bailey Arboretum
<i>Pinus monticola</i>	Western White Pine	5' 0"	6' 8"	7' 5"	4' 6"	Old Westbury; Old Westbury Gardens
<i>Pinus mugo</i>	Swiss Mountain Pine	N.R.	N.R.	0' 8"	4' 6"	Wading River; former Geo. Hart Estate
<i>Pinus nigra</i>	Austrian Pine	N.R.	N.R.	7' 8"	4' 6"	Matinecock; Oyster Bay Rd., J. Cattier
<i>Pinus parviflora</i>	Japanese White Pine	N.R.	4' 6"	4' 10"	4' 6"	Roslyn; W. C. Bryant Park & Preserve
<i>Pinus parviflora glauca</i>	Silver Japanese White Pine	N.R.	N.R.	1' 8"	4' 6"	Muttontown; Muttontown Preserve
<i>Pinus peuce</i>	Balkan Pine	N.R.	N.R.	6' 6"	2' 6"	Hauppauge; 3 Merrydale Dr., Mrs. A. Masson
<i>Pinus pungens</i>	Table Mountain Pine	N.R.	N.R.	1' 5"	4' 6"	North Hills; I. U. Willets Rd., A. Summers
<i>Pinus resinosa</i>	Red Pine	N.R.	N.R.	5' 7"	4' 6"	Mill Neck; Horseshoe Rd., E. Farley
<i>Pinus rigida</i>	Pitch Pine	N.R.	7' 7"	7' 9"	4' 6"	Great River; Bayard Cutting Arboretum
<i>Pinus strobus</i>	White Pine	N.R.	N.R.	11' 8"	1' 0"	Matinecock; Mrs. S. A. Mitchell Jr. Est.
<i>Pinus strobus banksiana</i>	White Pine	N.R.	N.R.	11' 7"	1' 6"	North Hills; I. U. Willets Rd., A. Summers
<i>Pinus strobus nana</i>	Dwarf White Pine	N.R.	1' 2"	1' 6"	0' 0"	Upper Brookville; Planting Fields Arboretum
<i>Pinus strobus pendula</i>	Weeping White Pine	N.R.	N.R.	1' 5"	4' 6"	Muttontown; Muttontown Preserve
<i>Pinus sylvestris</i>	Scotch Pine	N.R.	5' 6"	6' 1"	1' 0"	Hempstead; 18 St. James Place
<i>Pinus taeda</i>	Loblolly Pine	N.R.	N.R.	2' 5"	4' 6"	Roslyn; W. C. Bryant Park & Preserve
<i>Pinus thunbergii</i>	Japanese Black Pine	N.R.	5' 0"	5' 0"	5' 0"	Centre Island; J. R. Howard Residence
<i>Pinus virginiana</i>	Virginia Pine	N.R.	N.R.	4' 3"	4' 6"	Roslyn; W. C. Bryant Park & Preserve
<i>Planera aquatica</i>	Waterelm	N.R.	5' 0"	5' 3"	3' 0"	Southampton; Gr. Plains Rd., R. Denckla
<i>Platanus acerfolia</i>	London Planetree	N.R.	N.R.	15' 6"	4' 6"	Kings Point; H. Brickman Estate
<i>Platanus acerfolia</i>	London Planetree	13' 7"	14' 4"	14' 7"	4' 6"	Brooklyn; Prospect Park

BIGGEST TREE OF EACH SPECIES