

BUILDING-STRUCTURE INVENTORY FORM

DIVISION FOR HISTORIC PRESERVATION  
NEW YORK STATE PARKS AND RECREATION  
ALBANY, NEW YORK (518) 474-0479

FOR OFFICE USE ONLY  
UNIQUE SITE NO. 103-05-0226  
QUAD \_\_\_\_\_  
SERIES \_\_\_\_\_  
NEG. NO. \_\_\_\_\_

I-10

JUN 21 1977

YOUR NAME: Town of Islip DATE: 13 August 1976  
Town Hall  
YOUR ADDRESS: 655 Main Street TELEPHONE: 516 581-2000  
Islip, L.I., N.Y. 11751  
ORGANIZATION (if any): Department of Planning, Housing & Development

IDENTIFICATION

- 1. BUILDING NAME(S): (Charlie's Used Furniture Outlet)
- 2. COUNTY: Suffolk TOWN/CITY: Islip VILLAGE: \_\_\_\_\_
- 3. STREET LOCATION: 487 Main St., N side of st., N of Union Ave.
- 4. OWNERSHIP: a. public  b. private  NW corner Grant Ave.
- 5. PRESENT OWNER: \_\_\_\_\_ ADDRESS: \_\_\_\_\_
- 6. USE: Original: \_\_\_\_\_ Present: Furniture store
- 7. ACCESSIBILITY TO PUBLIC: Exterior visible from public road: Yes  No   
Interior accessible: Explain \_\_\_\_\_

DESCRIPTION

- 8. BUILDING MATERIAL: a. clapboard  b. stone  c. brick  d. board and batten   
e. cobblestone  f. shingles  g. stucco  other: Asbestos shingles
- 9. STRUCTURAL SYSTEM: a. wood frame with interlocking joints   
(if known) b. wood frame with light members   
c. masonry load bearing walls   
d. metal (explain) \_\_\_\_\_  
e. other \_\_\_\_\_
- 10. CONDITION: a. excellent  b. good  c. fair  d. deteriorated
- 11. INTEGRITY: a. original site  b. moved  if so, when? \_\_\_\_\_  
c. list major alterations and dates (if known):

Asbestos shingles; shutters are modern  
ROLL ISL-BAN-I-10  
NEGATIVE

12. PHOTO: LOOKING NE

13. MAP:

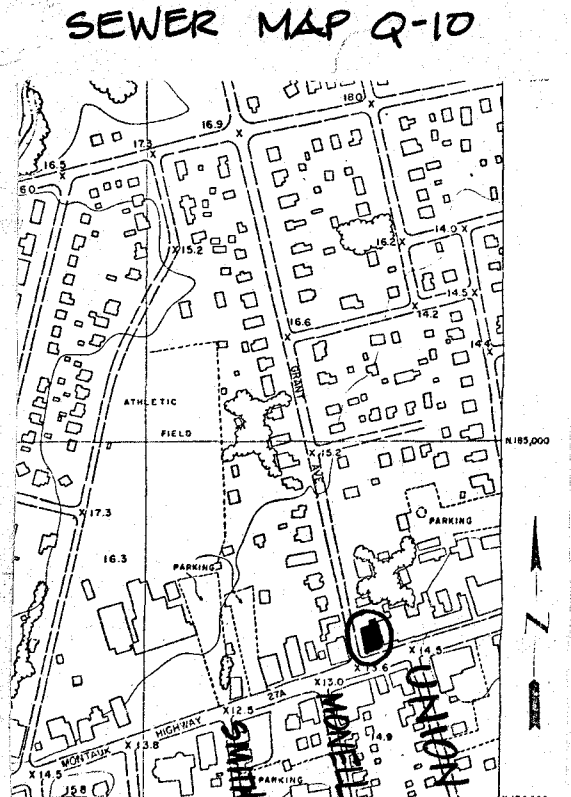

NEGATIVES DEPOSITED AT  
SOCIETY FOR PRESERVATION OF  
L. I. ANTIQUITIES

14. THREATS TO BUILDING: a. none known  b. zoning  c. roads   
 d. developers  e. deterioration   
 f. other: \_\_\_\_\_

15. RELATED OUTBUILDINGS AND PROPERTY:  
 a. barn  b. carriage house  c. garage   
 d. privy  e. shed  f. greenhouse   
 g. shop  h. gardens   
 i. landscape features: \_\_\_\_\_  
 j. other: \_\_\_\_\_

16. SURROUNDINGS OF THE BUILDING (check more than one if necessary):  
 a. open land  b. woodland   
 c. scattered buildings   
 d. densely built-up  e. commercial   
 f. industrial  g. residential   
 h. other: \_\_\_\_\_

17. INTERRELATIONSHIP OF BUILDING AND SURROUNDINGS:  
 (Indicate if building or structure is in an historic district)

18. OTHER NOTABLE FEATURES OF BUILDING AND SITE (including interior features if known):  
 2 story Italianate structure; brackets under cornice; further detailing visible on West facade.

**SIGNIFICANCE**

19. DATE OF INITIAL CONSTRUCTION: \_\_\_\_\_

ARCHITECT: \_\_\_\_\_

BUILDER: \_\_\_\_\_

20. HISTORICAL AND ARCHITECTURAL IMPORTANCE: In 1873 Chas. C. Smith store  
 1915 map: 2 story structure located on property with many other  
 buildings, owned by C. C. Smith  
This was Smith's Emporium.

21. SOURCES: Beers Comstock, Atlas of Long Island, 1873, p.151.  
 Hyde, E. Belcher. Atlas of the Ocean Shore of Suffolk Co., L.I.  
Westerly Section. Brooklyn-Manhattan, 1915.

22. THEME:  
 Research by: Society for the Preservation of Long Island Antiquities  
 Barbara Nadel, Research Assisstant