

BUILDING-STRUCTURE INVENTORY FORM

DIVISION FOR HISTORIC PRESERVATION
NEW YORK STATE PARKS AND RECREATION
ALBANY, NEW YORK (518) 474-0479

FOR OFFICE USE ONLY	
UNIQUE SITE NO.	<u>103-05-0268</u>
QUAD	_____
SERIES	_____
NEG. NO.	_____

YOUR NAME: Town of Islip DATE: 3/3/77

Town Hall

YOUR ADDRESS: 655 Main Street, Islip TELEPHONE: 516-581-2000

L.I., N.Y. 11751

ORGANIZATION (if any): Department of Planning, Housing and Development

1977

IDENTIFICATION

- BUILDING NAME(S): Emanuel Episcopal Church
- COUNTY: Suffolk TOWN/CITY: Islip VILLAGE: Great River
- STREET LOCATION: Great River Rd; West side; at Church Rd.
- OWNERSHIP: a. public b. private
- PRESENT OWNER: _____ ADDRESS: _____
- USE: Original: church Present: church
- ACCESSIBILITY TO PUBLIC: Exterior visible from public road: Yes No
Interior accessible: Explain _____

DESCRIPTION

- BUILDING MATERIAL: a. clapboard b. stone c. brick d. board and batten
e. cobblestone f. shingles g. stucco other: _____
- STRUCTURAL SYSTEM: a. wood frame with interlocking joints
(if known) b. wood frame with light members
c. masonry load bearing walls
d. metal (explain) _____
e. other _____
- CONDITION: a. excellent b. good c. fair d. deteriorated
- INTEGRITY: a. original site b. moved if so, when? _____
c. list major alterations and dates (if known): _____

12. PHOTO: neg. roll MFS3-3

13. MAP: N.Y. State D.O.T.



HP-1 looking west

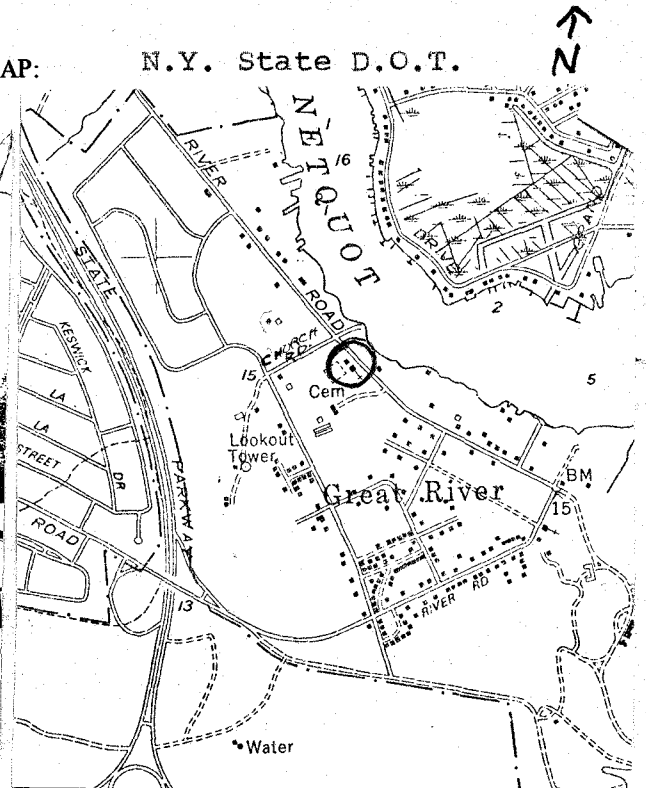

NEGATIVES DEPOSITED AT
SOCIETY FOR PRESERVATION OF
L. I. ANTIQUITIES

- 14. THREATS TO BUILDING: a. none known b. zoning c. roads
 d. developers e. deterioration
 f. other: _____

- 15. RELATED OUTBUILDINGS AND PROPERTY:
 a. barn b. carriage house c. garage
 d. privy e. shed f. greenhouse
 g. shop h. gardens
 i. landscape features: _____
 j. other: rectory

- 16. SURROUNDINGS OF THE BUILDING (check more than one if necessary):
 a. open land b. woodland
 c. scattered buildings
 d. densely built-up e. commercial
 f. industrial g. residential
 h. other: _____

17. INTERRELATIONSHIP OF BUILDING AND SURROUNDINGS:
 (Indicate if building or structure is in an historic district)
 An officially designated Landmark by the Town of Islip.
 Land donated by William Nicoll, the seventh and last owner of Islip
 Grange, who was buried in the cemetery close to the church in 1900.
 A very well preserved structure.

18. OTHER NOTABLE FEATURES OF BUILDING AND SITE (including interior features if known):
 A structure with overhanging stepped gable and elaborate timber
 decoration with drops and hooks. Gothic window, octagonal steeple.
 Vestibule with clipped gables. Original Gothic gateposts at the street.
 Rectory: Shingle Style, wide sweeping gable, original brick chimney
 on South facade, original dormer with flaring shingle course over
 window on North side of first story.

SIGNIFICANCE

- 19. DATE OF INITIAL CONSTRUCTION: 1862
- ARCHITECT: _____
- BUILDER: _____

20. HISTORICAL AND ARCHITECTURAL IMPORTANCE:

- 21. SOURCES:
 Hyde, E. Belcher Atlas of Ocean Shore of Suffolk County, Westerly
 Section, Brooklyn-Manhattan, 1915, plate 25.
 . East of Islip, An Early History, published friends of East
 Islip Public Library, 1969. p.7.
- 22. THE