

HISTORIC AND NATURAL DISTRICTS INVENTORY FORM

FOR OFFICE USE ONLY	
UNIQUE SITE NO.	<u>103-05-0246</u>
QUAD.	_____
SERIES	_____
NEG. NO.	_____

0014

DIVISION FOR HISTORIC PRESERVATION  
NEW YORK STATE PARKS AND RECREATION  
ALBANY, NEW YORK (518) 474-0479

JUN 21 1977

YOUR NAME: Town of Islip DATE: 14 Feb. 1977

Town Hall

YOUR ADDRESS: 655 Main Street, Islip TELEPHONE: 516-581-2000  
L.I., N.Y. 11751

ORGANIZATION (if any): Department of Planning, Housing and Development

\*\*\*\*\*

1. NAME OF DISTRICT: Union Boulevard District - Islip

2. COUNTY: Suffolk TOWN/CITY: Islip VILLAGE: Islip

3. DESCRIPTION:

Union Boulevard District - Islip consists of houses on both sides of Union Blvd. It extends west from Islip Avenue to Watson Place on the north side of the road. On the south side of the road the district extends from Islip Ave. west to include three houses west of Watson Place.

4. SIGNIFICANCE:  
see attached.

5. MAP:

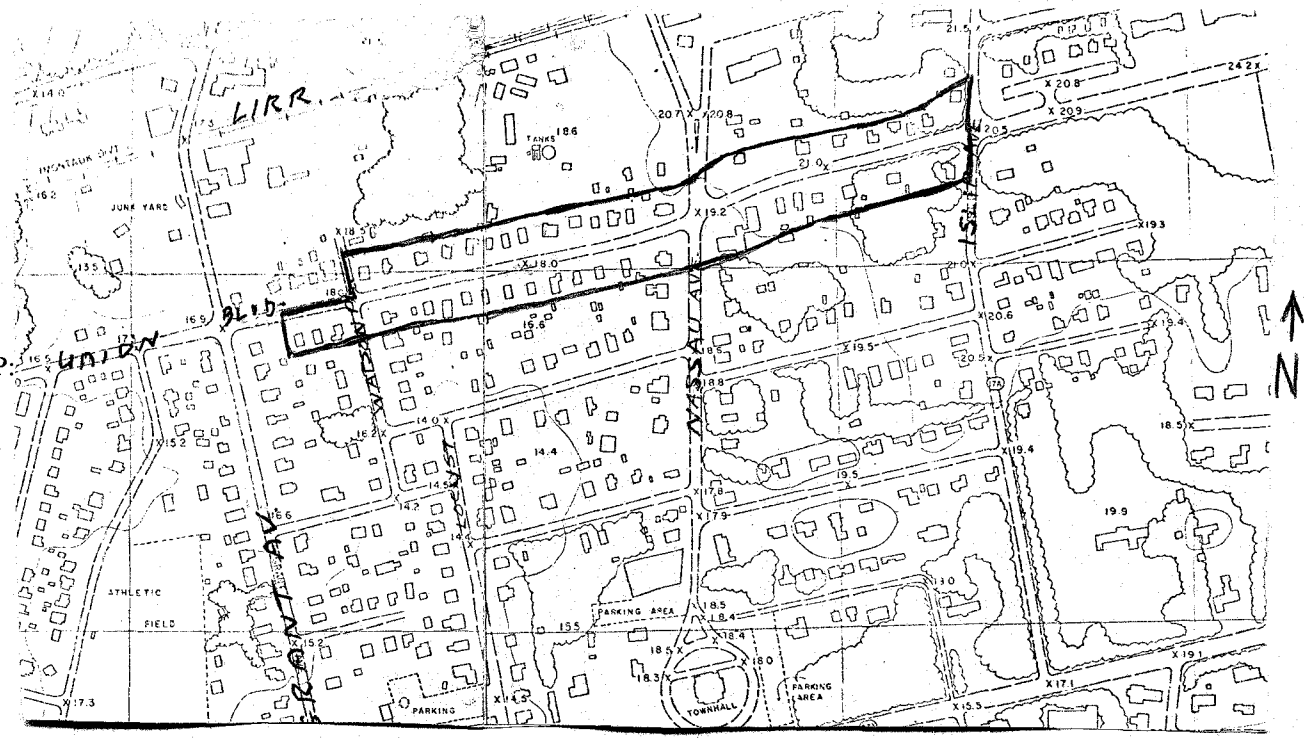

NEGATIVES DEPOSITED AT  
SOCIETY FOR PRESERVATION OF  
L. I. ANTIQUITIES

6. SOURCES:

Hyde, E. Belcher Atlas of Ocean Shore of Suffolk County, L.I.,  
Westerly Section, Brooklyn - Manhattan, 1915, plate 25.

7. THREATS TO AREA:

BY ZONING  BY ROADS  BY DEVELOPERS   
BY DETERIORATION  OTHER \_\_\_\_\_

ADDITIONAL COMMENTS:

8. LOCAL ATTITUDES TOWARD THE AREA:

9. PHOTOS: neg. roll BVL 1-4

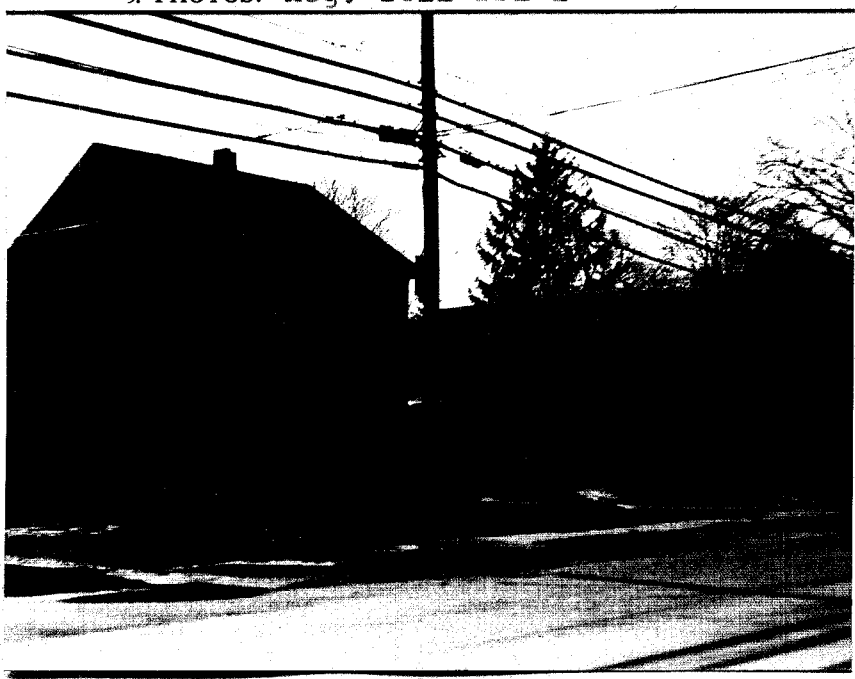

#2622 UNION BVD.  
AT LEFT

#2616 UNION BVD  
AT RIGHT

looking southwest

VII-50



neg. roll MFS 3-10

Looking northwest

#2687 on Union Boulevard, Islip.

SIGNIFICANCE: Notable Houses

From Islip Avenue proceeding west on Union Blvd.:

#2757

#2747 - from earliest period, a 1½ story 5 bay house.

#2750

#2744

#2740 - this is an early Italianate house with balcon-fenetre.

#2732

#2721 - roof almost flat with slight gable on front facade.

#2732

#2687 - notable Queen Anne house. (pic)

#2680

#2670

#2665

#2662

#2661

#2658

#2657

#2654

#2655

#2650

#2645 - 3 bay 2 story Italianate house with wide overhanging cornice. Almost flat roof with 4 gables, one on each side  
equal

#2637

#2631

#2622 - 3 bay 2½ story gable roof with brackets. Italianate house with balcon-fenetre.

## 4. SIGNIFICANCE: (continued)

# 2616 - 3 bay 2 story Italianate house with almost flat roof with slight gable on front facade. Original 6/6 windows. Paired brackets have just been removed from cornice.

# 43 Watson Place - 1 story mansard roof with original dormers.

*Plate*  
*23*  
*1915*

E. Belcher Hyde  
Atlas, 1915  
plate 25.

Mrs. E. E. Wood

ISLIP  
TENNIS  
CLUB

AVE.

MRS. GEO. BRUCE-BROWN

RECTOR  
ST. MARKS CH.  
PARISH HO.

B. SMITH

FRANK CREAMER EST.

PRIVATE ST

C.S. FLINT

H H HOLLISTER

*Plate 23*  
*1915*

B. S. WELLS

