

**BUILDING-STRUCTURE INVENTORY FORM**

FOR OFFICE USE ONLY

H 17,18,19

DIVISION FOR HISTORIC PRESERVATION  
NEW YORK STATE PARKS AND RECREATION  
ALBANY, NEW YORK (518) 474-0479

UNIQUE SITE NO. 103-05-0597-HSP  
QUAD \_\_\_\_\_  
SERIES \_\_\_\_\_  
NEG. NO. \_\_\_\_\_

YOUR NAME B. Van Liew, Consultant/NSF DATE 8/79  
N Sherrill Foster

YOUR ADDRESS: Box 416, St. James, L.I. TELEPHONE 516-584-5600

ORGANIZATION (if any): Natural Heritage Trust

\*\*\*\*\*

**IDENTIFICATION**

- 1. BUILDING NAME(S): Greenhouses, office and work room Heckscher State Park:
- 2. COUNTY: Suffolk TOWN/CITY: Islip VILLAGE: East Islip
- 3. STREET LOCATION: Timber Point Rd; south side
- 4. OWNERSHIP: a. public  b. private
- 5. PRESENT OWNER: LISPC ADDRESS: Belmont State Park
- 6. USE: Original: Greenhouses Present: same
- 7. ACCESSIBILITY TO PUBLIC: Exterior visible from public road: Yes  No   
Interior accessible: Explain \_\_\_\_\_

**DESCRIPTION**

- 8. BUILDING MATERIAL: a. clapboard  b. stone  c. brick  d. board and batten   
e. cobblestone  f. shingles  g. stucco  other: Glass paned walls & roofs
- 9. STRUCTURAL SYSTEM: (if known) a. wood frame with interlocking joints   
b. wood frame with light members   
c. masonry load bearing walls   
d. metal (explain) \_\_\_\_\_  
e. other poured concrete foundation
- 10. CONDITION: a. excellent  b. good  c. fair  d. deteriorated
- 11. INTEGRITY: a. original site  b. moved  if so, when? \_\_\_\_\_  
c. list major alterations and dates (if known): \_\_\_\_\_

Roll 2

12. PHOTO: H 17,18,19 -20  
West view.

13. MAP: Bay Shore East quadrangle  
-21 see attachment

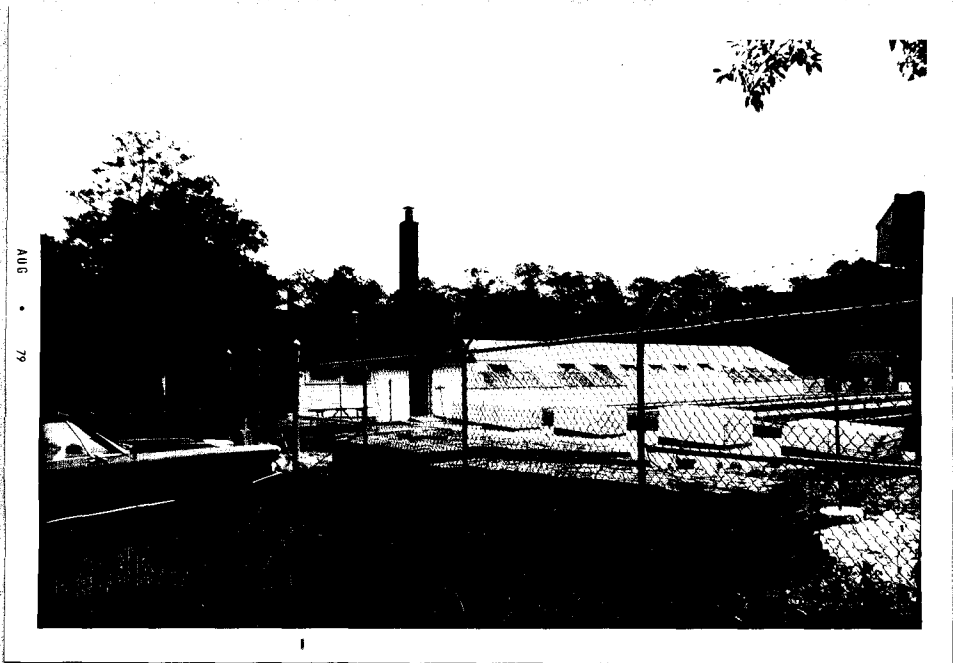

14. THREATS TO BUILDING: a. none known  b. zoning  c. roads   
 d. developers  e. deterioration   
 f. other: \_\_\_\_\_

15. RELATED OUTBUILDINGS AND PROPERTY:  
 a. barn  b. carriage house  c. garage   
 d. privy  e. shed  f. greenhouse   
 g. shop  h. gardens   
 i. landscape features: open sunlit area  
 j. other: \_\_\_\_\_

16. SURROUNDINGS OF THE BUILDING (check more than one if necessary):  
 a. open land  b. woodland   
 c. scattered buildings   
 d. densely built-up  e. commercial   
 f. industrial  g. residential   
 h. other: \_\_\_\_\_

17. INTERRELATIONSHIP OF BUILDING AND SURROUNDINGS:  
 (Indicate if building or structure is in an historic district)  
 Buildings at end of Allee of olive trees

18. OTHER NOTABLE FEATURES OF BUILDING AND SITE (including interior features if known):  
 One story gable roof shingled and glass buildings.

**SIGNIFICANCE**

19. DATE OF INITIAL CONSTRUCTION: 1933

ARCHITECT: \_\_\_\_\_

BUILDER: \_\_\_\_\_ WPA

20. HISTORICAL AND ARCHITECTURAL IMPORTANCE:  
Typical vernacular building of useful occupation

21. SOURCES: Interview with Mr. O'Neil 7/8/79

22. THEME:

ATTACHMENT

H 17, 18, 19

Greenhouses etc.

Heckscher State Park

Roll 2

Photo H 17,18,19-21 West facade



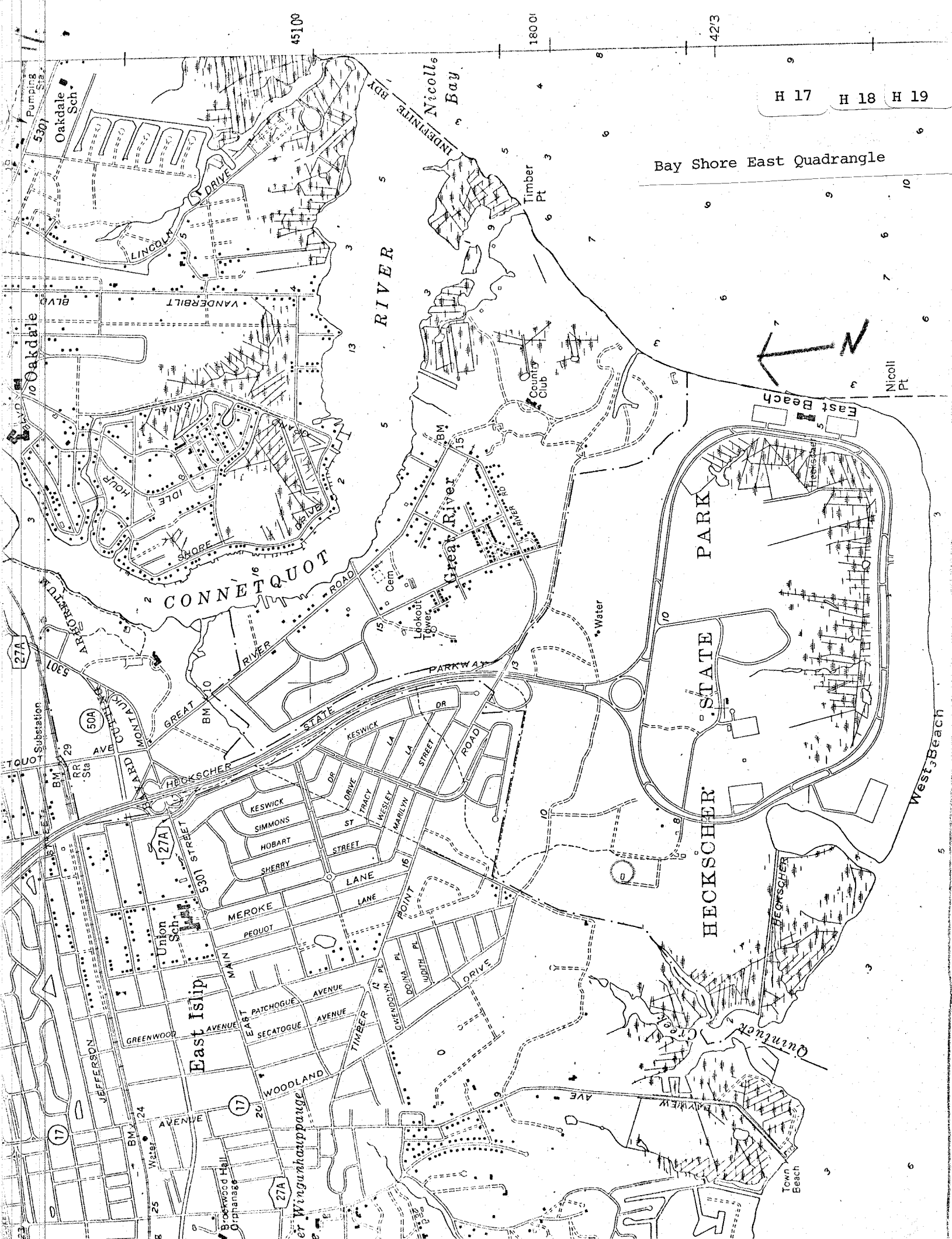

H 17 H 18 H 19

Bay Shore East Quadrangle

Nicoll Pt

West Beach

East Beach

Town Beach

45100

18001

42/3

Pumping Sta  
5307

Oakdale

27A

5301

27A

17

24

25

CONNETQUOT RIVER

RIVER

Great River

Nicoll Bay

PARK

STATE

HECKSCHER

East Islip

er Wignunhappauge

Water

Water

