

**BUILDING-STRUCTURE INVENTORY FORM**

DIVISION FOR HISTORIC PRESERVATION  
 NEW YORK STATE PARKS AND RECREATION  
 ALBANY, NEW YORK (518) 474-0479

FOR OFFICE USE ONLY

UNIQUE SITE NO. 10305.000803  
 QUAD \_\_\_\_\_  
 SERIES \_\_\_\_\_  
 NEG. NO. \_\_\_\_\_

BO 13

YOUR NAME: Town of Islip/SPLIA DATE: March 1990  
Town Hall, 655 Main St.  
 YOUR ADDRESS: Islip, L.I., N.Y. 11751 TELEPHONE: 516.224.5450  
 ORGANIZATION (if any): Dept. of Planning, Housing, and Development

\*\*\*\*\*

**IDENTIFICATION**

1. BUILDING NAME(S): Kouril House  
 2. COUNTY: Suffolk TOWN/CITY: Islip VILLAGE: Bohemia  
 3. STREET LOCATION: 1519 Locust Ave.  
 4. OWNERSHIP: a. public  b. private   
 5. PRESENT OWNER: Bohemia Hist. Soc. ADDRESS: \_\_\_\_\_  
 6. USE: Original: residence Present: future Hist. Soc. site  
 7. ACCESSIBILITY TO PUBLIC: Exterior visible from public road: Yes  No  partial  
 Interior accessible: Explain by app't.

**DESCRIPTION**

8. BUILDING MATERIAL: a. clapboard  b. stone  c. brick  d. board and batten   
 e. cobblestone  f. shingles  g. stucco  other: \_\_\_\_\_  
 9. STRUCTURAL SYSTEM: a. wood frame with interlocking joints   
 (if known) b. wood frame with light members   
 c. masonry load bearing walls   
 d. metal (explain) \_\_\_\_\_  
 e. other \_\_\_\_\_  
 10. CONDITION: a. excellent  b. good  c. fair  d. deteriorated   
 11. INTEGRITY: a. original site  b. moved  if so, when? 1989  
 c. list major alterations and dates (if known): from 12 Locust Ave.

12. PHOTO: Neg. KK XXI-9, fm. SW

13. MAP: NYS DOT Patchogue Quad



HP-1

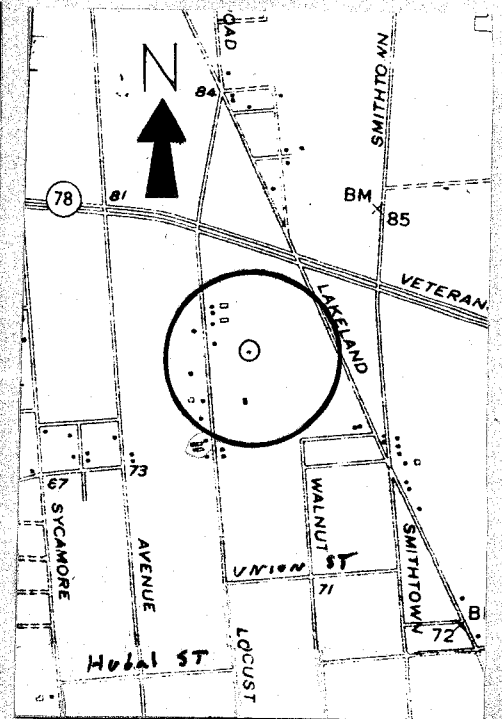

14. THREATS TO BUILDING: a. none known  b. zoning  c. roads   
 d. developers  e. deterioration   
 f. other: \_\_\_\_\_
15. RELATED OUTBUILDINGS AND PROPERTY:  
 a. barn  b. carriage house  c. garage  attached  
 d. privy  e. shed  f. greenhouse   
 g. shop  h. gardens   
 i. landscape features: \_\_\_\_\_  
 j. other: \_\_\_\_\_
16. SURROUNDINGS OF THE BUILDING (check more than one if necessary):  
 a. open land  b. woodland   
 c. scattered buildings   
 d. densely built-up  e. commercial   
 f. industrial  g. residential   
 h. other: moved to Bohemia Historical Soc. property

17. INTERRELATIONSHIP OF BUILDING AND SURROUNDINGS:

(Indicate if building or structure is in an historic district)

The Kouril House has been recently moved to a Bohemia Historical Society property on the east side of Locust Avenue, south of the Veterans Memorial Highway in the residential neighborhood of Bohemia. The house is set back from the road on a primarily open parcel, marked with a sign.

18. OTHER NOTABLE FEATURES OF BUILDING AND SITE (including interior features if known):

The Kouril House is a 1½ story, side entrance plan, gable roof house with a single bay, 1½ story wing on the north and an attached, 1½ story garage wing on the south with a low cupola. The principle (west) facade of the main block features a semi-hexagonal bay window.

**SIGNIFICANCE**

19. DATE OF INITIAL CONSTRUCTION: \_\_\_\_\_ 1946 \_\_\_\_\_

ARCHITECT: \_\_\_\_\_

BUILDER: \_\_\_\_\_ Rudolph Svoboda \_\_\_\_\_

20. HISTORICAL AND ARCHITECTURAL IMPORTANCE:

This house was donated to the Bohemia Historical Society.

21. SOURCES:

Beacon, 12/21/1989.

22. THEME:

Research by Society for the Preservation of Long Island Antiquities - KEK