

BUILDING-STRUCTURE INVENTORY FORM

DIVISION FOR HISTORIC PRESERVATION
NEW YORK STATE PARKS AND RECREATION
ALBANY, NEW YORK (518) 474-0479

FOR OFFICE USE ONLY	
UNIQUE SITE NO.	<u>103-05-0428-D29</u>
QUAD	_____
SERIES	_____
NEG. NO.	_____

BA 28

green

YOUR NAME: Town of Islip DATE: Sept. 10, 1979
Town Hall
 YOUR ADDRESS: 655 Main St., Islip TELEPHONE: 516 224-5450
 ORGANIZATION (if any): Dept. of Planning and Development

IDENTIFICATION

- BUILDING NAME(S): ~~Nicosia house (formerly J. Snedecor house)~~
- COUNTY: Suffolk TOWN/CITY: Islip VILLAGE: Bayport
- STREET LOCATION: 525 Middle Rd., north side, east of Snedecor Ave.
- OWNERSHIP: a. public b. private
- PRESENT OWNER: Lawrence Nicosia ADDRESS: 525 Middle Rd., Bayport
- USE: Original: residence Present: residence
- ACCESSIBILITY TO PUBLIC: Exterior visible from public road: Yes No
Interior accessible: Explain by appointment

DESCRIPTION

- BUILDING MATERIAL: a. clapboard b. stone c. brick d. board and batten
e. cobblestone f. shingles g. stucco other: _____
- STRUCTURAL SYSTEM: (if known) a. wood frame with interlocking joints
b. wood frame with light members
c. masonry load bearing walls
d. metal (explain) _____
e. other _____
- CONDITION: a. excellent b. good c. fair d. deteriorated
- INTEGRITY: a. original site b. moved if so, when? _____
c. list major alterations and dates (if known): _____

porch removed; modern steps.

12. PHOTO: **ELW II, # 3A**
from Sw, front

13. MAP: **Bowe, Albertson Sewer Maps, Bayport Q16**

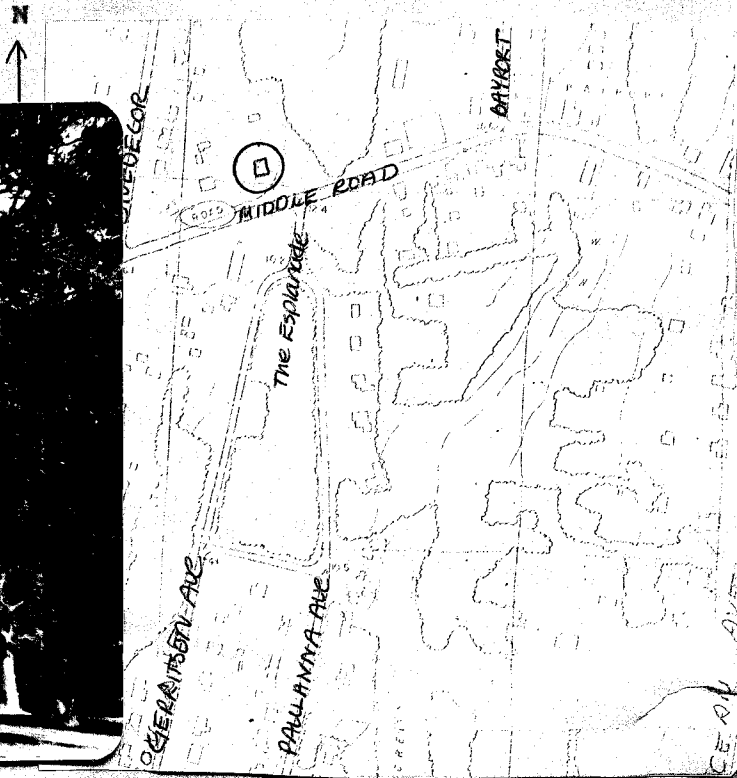

14. THREATS TO BUILDING: a. none known b. zoning c. roads
 d. developers e. deterioration
 f. other: _____
15. RELATED OUTBUILDINGS AND PROPERTY:
 a. barn b. carriage house c. garage
 d. privy e. shed f. greenhouse
 g. shop h. gardens
 i. landscape features: _____
 j. other: _____
16. SURROUNDINGS OF THE BUILDING (check more than one if necessary):
 a. open land b. woodland
 c. scattered buildings
 d. densely built-up e. commercial
 f. industrial g. residential
 h. other: _____

17. INTERRELATIONSHIP OF BUILDING AND SURROUNDINGS:
 (Indicate if building or structure is in an historic district)

This house is located in Middle Road, Bayport, where many of the houses date back over one hundred years.

18. OTHER NOTABLE FEATURES OF BUILDING AND SITE (including interior features if known):

SIGNIFICANCE

19. DATE OF INITIAL CONSTRUCTION: before 1873*

ARCHITECT: _____

BUILDER: _____

20. HISTORICAL AND ARCHITECTURAL IMPORTANCE:

Two and one-half story, three bay, side entrance, gable roof, clapboarded house with gable end to street. Sawn decorative screen in peak of gable. One story bay window on first floor west. Original panelled front door with original etched ruby glass transom. 2/2 windows. Brick foundation. Large barn of vertical boards.

Owner feels the house was built about 1875. It is marked on the 1873 Atlas as that of L. Snedecor.

21. SOURCES: * Beers, F.W., Atlas of Long Island, Brooklyn: Beers, Comstock & Cline, 1873, Bayport, p. 154.
 Belcher-Hyde, E., Atlas of Suffolk County, Brooklyn: 1915, p. 32.

22. THEME:
residential.