

**BUILDING-STRUCTURE INVENTORY FORM**

DIVISION FOR HISTORIC PRESERVATION  
NEW YORK STATE PARKS AND RECREATION  
ALBANY, NEW YORK (518) 474-0479

FOR OFFICE USE ONLY

UNIQUE SITE NO. 103-05-0419-029  
QUAD \_\_\_\_\_  
SERIES \_\_\_\_\_  
NEG. NO. \_\_\_\_\_

BA 19

green/yellow

YOUR NAME: Town of Islip DATE: Sept. 10, 1979  
Town Hall

YOUR ADDRESS: 655 Main St., Islip TELEPHONE: 516 224-5450

ORGANIZATION (if any): Dept. of Planning and Development

\*\*\*\*\*  
**IDENTIFICATION**

- 1. BUILDING NAME(S): ~~Dodson house~~
- 2. COUNTY: Suffolk TOWN/CITY: Islip VILLAGE: Bayport
- 3. STREET LOCATION: 407 Middle Rd., north side, west of Marina Lane
- 4. OWNERSHIP: a. public  b. private
- 5. PRESENT OWNER: Richard Dodson ADDRESS: 407 Middle Rd., Bayport
- 6. USE: Original: residence Present: residence
- 7. ACCESSIBILITY TO PUBLIC: Exterior visible from public road: Yes  No   
Interior accessible: Explain by appointment

**DESCRIPTION**

- 8. BUILDING MATERIAL: a. clapboard  b. stone  c. brick  d. board and batten   
e. cobblestone  f. shingles  g. stucco  other: \_\_\_\_\_
- 9. STRUCTURAL SYSTEM: (if known) a. wood frame with interlocking joints   
b. wood frame with light members   
c. masonry load bearing walls   
d. metal (explain) \_\_\_\_\_  
e. other \_\_\_\_\_
- 10. CONDITION: a. excellent  b. good  c. fair  d. deteriorated
- 11. INTEGRITY: a. original site  b. moved  if so, when? \_\_\_\_\_  
c. list major alterations and dates (if known): \_\_\_\_\_

Two windows altered. *two windows*

12. PHOTO: ELW I, #15A  
from SE, front

13. MAP Bowe, Albertson Sewer Maps, Bayport Q16

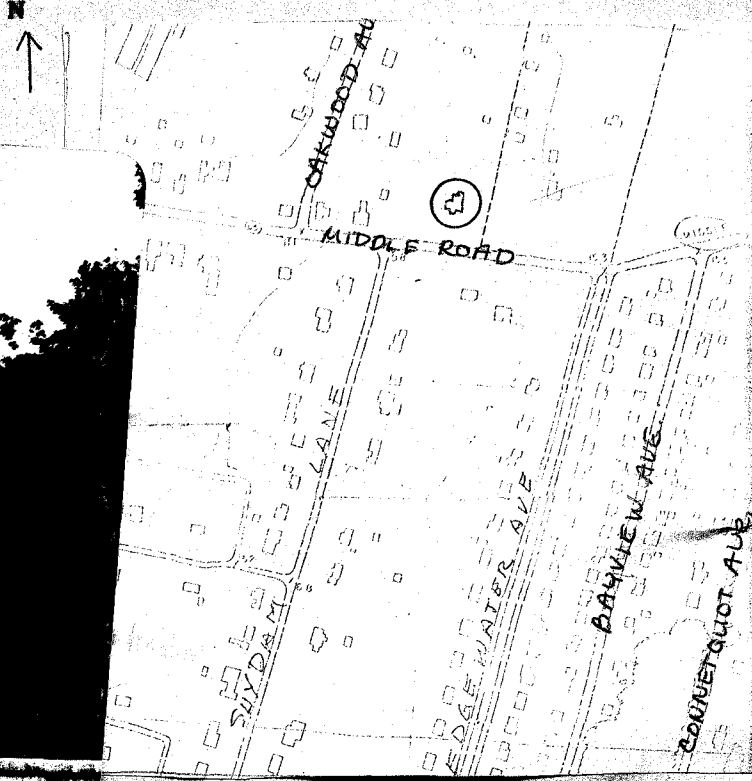

14. THREATS TO BUILDING: a. none known  b. zoning  c. roads   
 d. developers  e. deterioration   
 f. other: \_\_\_\_\_
15. RELATED OUTBUILDINGS AND PROPERTY:  
 a. barn  b. carriage house  c. garage   
 d. privy  e. shed  f. greenhouse   
 g. shop  h. gardens   
 i. landscape features: \_\_\_\_\_  
 j. other: low, stuccoed wall near street
16. SURROUNDINGS OF THE BUILDING (check more than one if necessary):  
 a. open land  b. woodland   
 c. scattered buildings   
 d. densely built-up  e. commercial   
 f. industrial  g. residential   
 h. other: \_\_\_\_\_

17. INTERRELATIONSHIP OF BUILDING AND SURROUNDINGS:  
 (Indicate if building or structure is in an historic district)

**This house is located on Middle Road, Bayport, where many of the houses are over one hundred years old.**

18. OTHER NOTABLE FEATURES OF BUILDING AND SITE (including interior features if known):

**SIGNIFICANCE**

19. DATE OF INITIAL CONSTRUCTION: before 1915\*, after 1873

ARCHITECT: \_\_\_\_\_

BUILDER: \_\_\_\_\_

20. HISTORICAL AND ARCHITECTURAL IMPORTANCE:

**Two and one-half story, five bay, gable roof house with porte-cochere on east, and double-deck porches on west. It is typical pre-World War I, stuccoed architecture.**

**It belonged to Dr. George Rice in 1915.**

21. SOURCES: \* Belcher-Hyde, E., Atlas of Suffolk County, Brooklyn: 1915, Bayport, p. 32.

22. THEME:

**residential.**